

**26465 NW West Union Road
Hillsboro, OR 97124**

First Floor	2,488 sf
Second Floor	1,344 sf
Third Floor	739 sf
Basement	1,206 sf
Total	5,777 sf

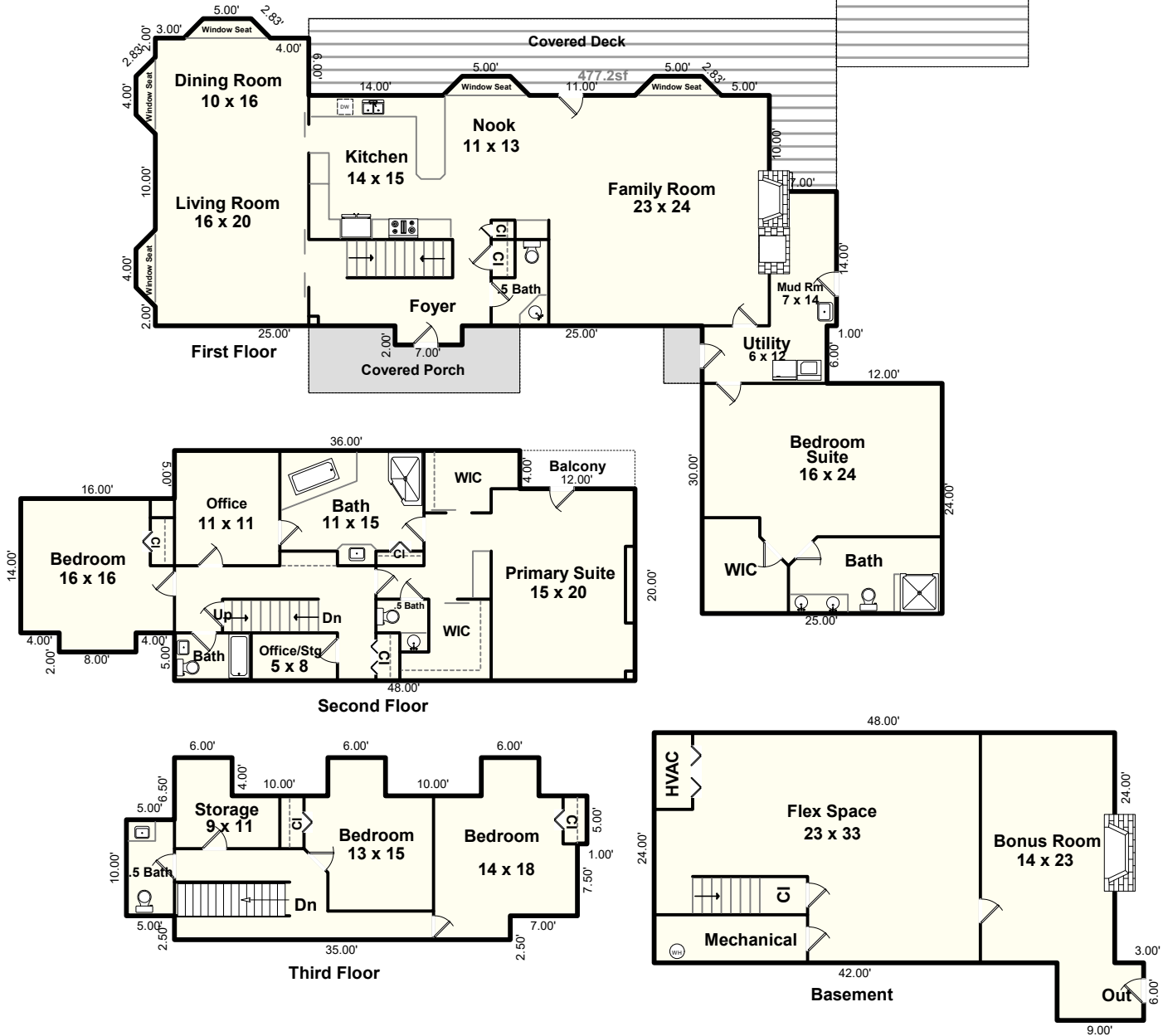
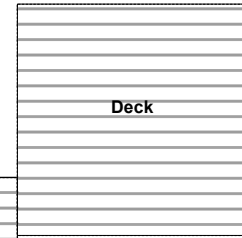

Floor Plan By: Michael Teach, Measurement Northwest

(Formerly Teach Appraising)

MeasurementNorthwest@outlook.com

Due to rounding and the difficulty in measuring to the outside walls of upper floors and basements, the calculations should be considered as a reasonable estimate only, not guaranteed, and should be independently verified. Approximate room dimensions. Prepared for the noted client only, no other use or user is authorized. All rights reserved.

26465 NW West Union Road
Hillsboro, OR 97124

Outbuildings

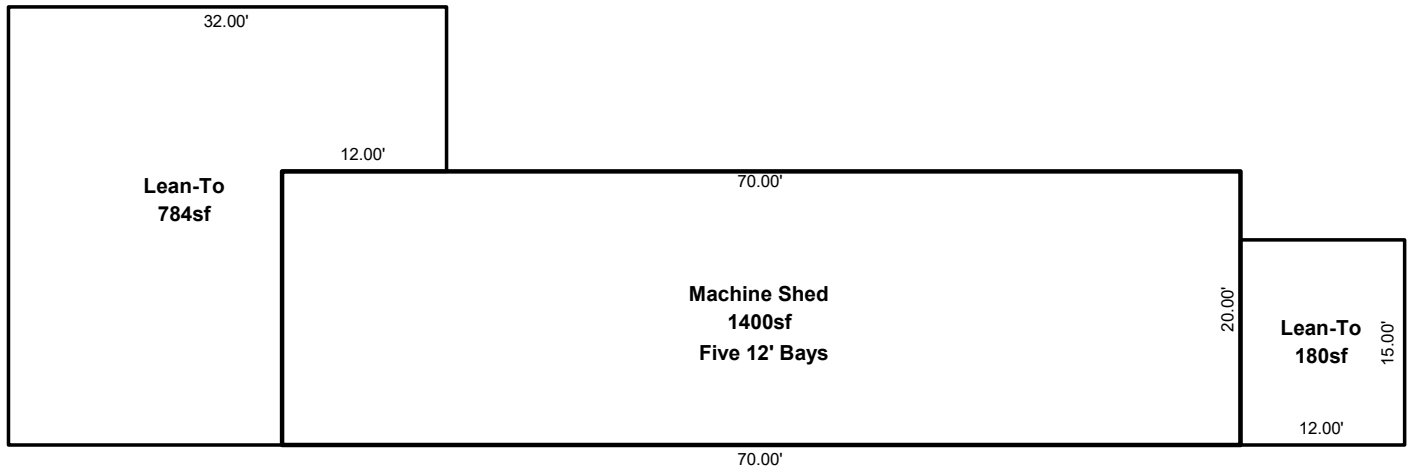
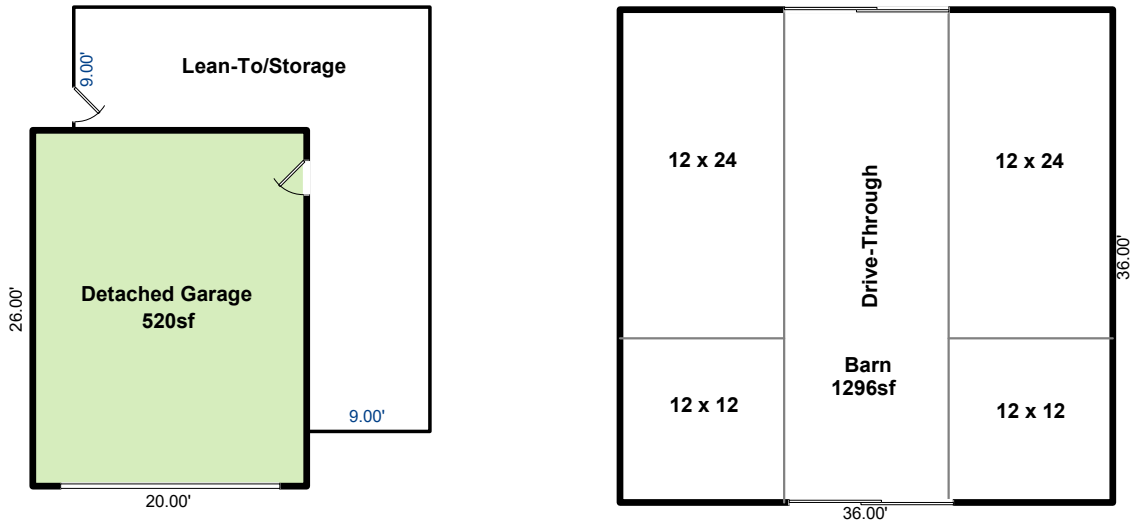

Floor Plan By: Michael Teach, Measurement Northwest
(Formerly Teach Appraising)

MeasurementNorthwest@outlook.com

Due to rounding and the difficulty in measuring to the outside walls of upper floors and basements, the calculations should be considered as a reasonable estimate only, not guaranteed, and should be independently verified. Approximate room dimensions. Prepared for the noted client only, no other use or user is authorized. All rights reserved.