

Item: **RIVERHILL TOWNHOUSE TRACTS NO. EIGHT**

(Category: RESTRICTIONS)

Volume 179, Page 806, Volume 179, Page 822 and Volume 180, Page 584, Deed Records of Kerr County, Texas; Volume 4, Page 279, Plat Records of Kerr County, Texas; Volume 264, Page 456, Volume 264, Page 462 and Volume 274, Page 367, Deed Records of Kerr County, Texas; Volume 935, Page 341 and Volume 1161, Page 304, Real Property Records of Kerr County, Texas, BUT OMITTING ANY COVENANT OR RESTRICTION BASED ON RACE, COLOR, RELIGION, SEX, HANDICAP, FAMILIAL STATUS, OR NATIONAL ORIGIN unless and only to the extent that said covenant (a) is exempt under Chapter 42, Section 3607 of the United States Code or (b) relates to handicap but does not discriminate against handicapped persons.

---

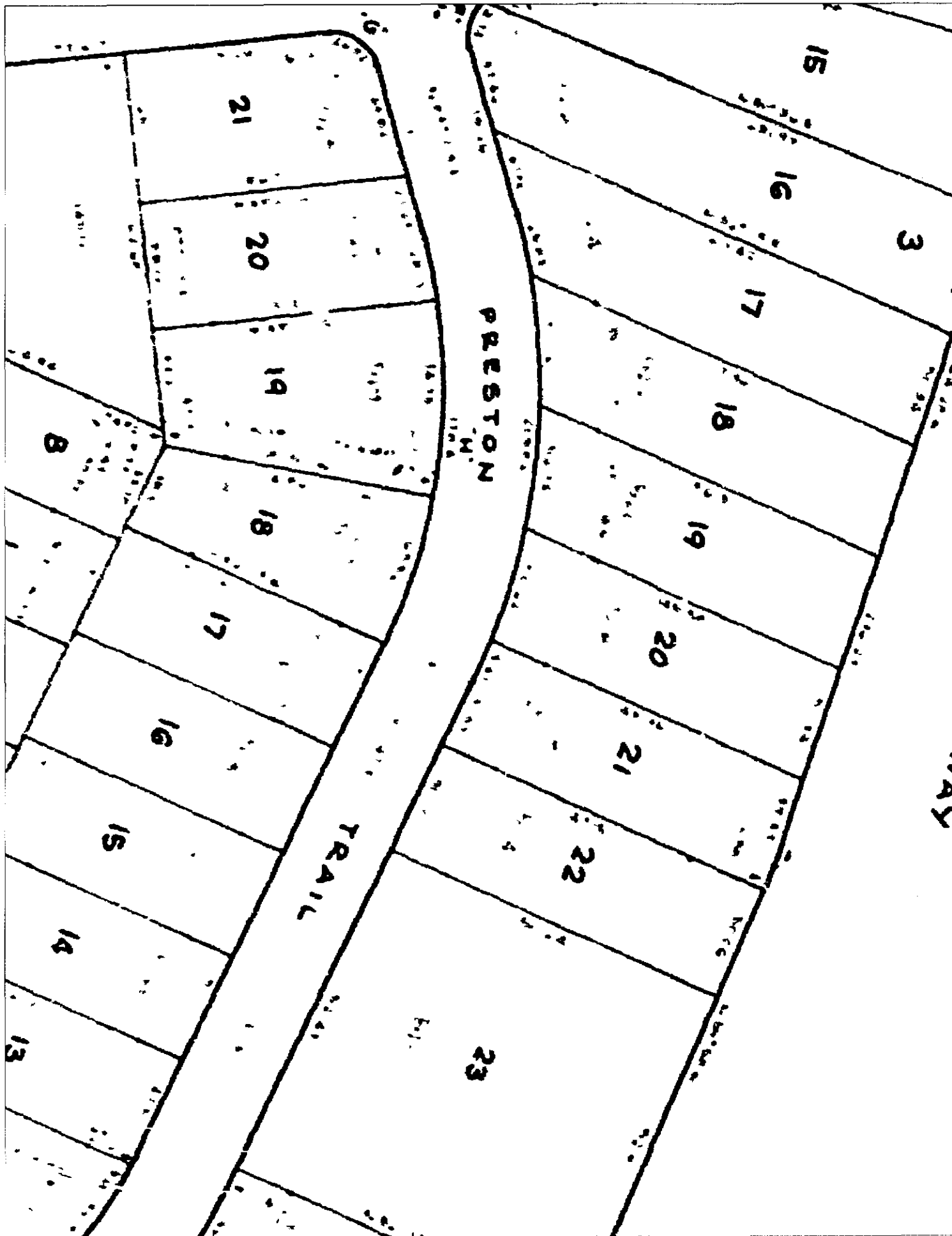



**AMENDMENT  
TO  
SUPPLEMENTAL DECLARATION**

This Amendment to Supplemental Declaration is executed by the Association of Property Owners of Riverhill, Inc. ("Association") effective this 6 day of December, 2001.

- A. The Association is the successor to the Declarant under that certain Declaration of Covenants, Conditions and Restrictions (the "Declaration"), recorded in Volume 179, Page 822, et seq., Deed Records, Kerr County, Texas.
- B. The Declaration has been supplemented by that certain Supplemental Declaration recorded in Volume 264, Page 456, Real Property Records, Kerr County, Texas ("Supplemental Declaration").
- C. The Supplemental Declaration provides that it may be amended with a consent of a majority of the Owners, as therein defined, and the Declarant (now the Association) and in each case such Amendment shall be evidence by document in writing bearing each of the signatures required. This Amendment is being executed by the Association with the written consent of the requisite Owners whose signatures are attached hereto and made a part hereof for all purposes.

NOW, THEREFORE, the Association, joined in by the Owners whose signatures are attached hereto, hereby amend the Supplemental Declaration by changing the provisions of the Supplemental Declaration, Paragraph 1 (a) (viii) to be and read "roofs shall be cedar shingle, tile, metal or composition (300 lb/sq or more). Metal roofs must be painted, baked on finish or acidized." The foregoing shall supercede and amend in its entirety the referenced sub-paragraph of the Supplemental Declaration.

EXCEPT as herein provided the Supplemental Declaration shall remain in full force and effect as provided in the documents referenced herein above.

EXECUTED as of the day and year set forth above.

*Filed By & Return To:*  
*Wallace Jackson*  
*820 main st.*  
*Kerrville Tx*  
*78021*

ASSOCIATION OF PROPERTY OWNERS  
OF RIVERHILL, INC.

BY: *Mark Hamilton*  
VICE - President

Attachments

Assoc. of Property Owners RH, Inc.  
amendment to supplemental declaration

FILED FOR RECORD  
at 2:00 on Dec 12 2001

DEC 12 2001

JANNETT PIEPER

Clerk, County Court, Kerr County, Texas  
*[Signature]*  
Deputy

*41-5-1*

ACKNOWLEDGEMENT

THE STATE OF TEXAS     §

COUNTY OF KERR         §

This instrument was acknowledged before me on the 6<sup>th</sup> day of  
December, 2001, by MACK Hamilton as  
Vice-President of and on behalf of the Association of Property Owners of Riverhill, Inc.



Elizabeth A. Buchanan  
Notary Public, State of Texas

RECORDER'S NOTE  
AT TIME OF RECORDATION INSTRUMENT FOUND  
TO BE INADEQUATE FOR BEST PHOTOGRAPHIC  
REPRODUCTION DUE TO THE DEPTH & DARKNESS OF  
PRINT, COLOR OF PRINT OR INK, BACKGROUND OF  
PAPER, ILLEGIBILITY, CARBON OR PHOTO COPY, ETC.

Provisional Period which restricts the sale, rental or use of the described prop-  
erty because of color or race is invalid and unenforceable under Federal Law.  
THE STATE OF TEXAS }  
COUNTY OF KERR }  
I hereby certify that this instrument was FILED in the File Number Sequence  
on the date and at the time stamped hereon by me and was duly RECORDED  
in the Official Public Records of Real Property of Kerr County, Texas on

DEC 18 2001



Janet Pieper  
COUNTY CLERK, KERR COUNTY, TEXAS

RECORD Real Property  
VOL. 1161 PG 304  
RECORDING DATE

DEC 18 2001



Janet Pieper  
COUNTY CLERK, KERR COUNTY, TEXAS

## ASSOCIATION OF PROPERTY OWNERS OF RIVERHILL, INC.

P.O. Box 293895  
 Kerrville, Texas 78029-3895  
 "Best Buy In Riverhill"

COPY

BOARD OF DIRECTORS: Larry Denton, Bill Ellis, Porter Garner, Mack Hamilton, Nina Weinberg (President)  
 Officers: Wendell Bingham (Secretary), Beverly McHenry (Treasurer)

October 4, 2001

To All Property Owners  
 Riverhill Town House Tract 8

Dear Property Owner,

It has been requested that the Covenants, Conditions and Restrictions (CCRs) pertaining to roofing be revised to permit composition roofing on housing in Block 1, Riverhill Town House Tract 8. Since all other Riverhill tracts permit composition roofing, the Association of Property Owners of Riverhill (APOR) believes it is appropriate to permit such roofing in Town House Tract 8, Block 1.

The proposed revision follows. Refer to Supplemental Declaration of Covenants, Conditions and Restrictions, Volume 264, Page 457-8.

**Building Restrictions**

**(a) Block 1- GOLF COURSE LOTS**

(VIII) Currently reads: Roofs shall be cedar shingle, tile, or metal.  
 Metal roofs must be painted, baked on finish, or acidized.

Proposed to read: Roofs shall be cedar shingle, tile, metal or composition (300 lb/sq or more). Metal roofs must be painted, baked on finish or acidized.

The proposed reading is identical to restrictions that applies to Block 2 (bounded by Rolling Green, Preston Trail and Oakland Hills Lane and Block 3 (Oakland Hills Lane facing Highway 173). As proposed the revised restriction is compatible with all other tracts in Riverhill.

To become effective, the revision must be approved by more than 50% of the homeowners in Tract 8. All owners in Tract 8 are receiving this notice and ballot. You are requested to vote by circling your preference and return the ballot in the enclosed envelope to the Association Secretary by October 15th. Again, APOR recommends you approve this revision.

Sincerely,

*Nina Weinberg*

Nina Weinberg  
 President

**BALLOT**

I ☒ (agree) (disagree) with the proposed revision to the Covenants, Conditions and Restrictions (CCRs) proposed for Riverhill Townhouse Tract 8.

Signed

*Clara Wright*

Date

*10/3/01*

## ASSOCIATION OF PROPERTY OWNERS OF RIVERHILL, INC.

P.O. Box 293895

Kerrville, Texas 78029-3895

"Best Buy In Riverhill"

BOARD OF DIRECTORS: Larry Denton, Bill Ellis, Porter Garner, Mack Hamilton, Nina Weinberg (President)  
 Officers: Wendell Bingham (Secretary), Beverly McHenry (Treasurer)

October 4, 2001

To All Property Owners  
 Riverhill Town House Tract 8

Dear Property Owner,

It has been requested that the Covenants, Conditions and Restrictions (CCRs) pertaining to roofing be revised to permit composition roofing on housing in Block 1, Riverhill Town House Tract 8. Since all other Riverhill tracts permit composition roofing, the Association of Property Owners of Riverhill (APOR) believes it is appropriate to permit such roofing in Town House Tract 8, Block 1.

The proposed revision follows. Refer to Supplemental Declaration of Covenants, Conditions and Restrictions, Volume 264, Page 457-8.

## Building Restrictions

## (a) Block 1- GOLF COURSE LOTS

(VIII) Currently reads: Roofs shall be cedar shingle, tile, or metal.  
 Metal roofs must be painted, baked on finish, or acidized.

Proposed to read: Roofs shall be cedar shingle, tile, metal or composition (300 lb/sq or more). Metal roofs must be painted, baked on finish or acidized.

The proposed reading is identical to restrictions that applies to Block 2 (bounded by Rolling Green, Preston Trail and Oakland Hills Lane and Block 3 (Oakland Hills Lane facing Highway 173). As proposed the revised restriction is compatible with all other tracts in Riverhill.

To become effective, the revision must be approved by more than 50% of the homeowners in Tract 8. All owners in Tract 8 are receiving this notice and ballot. You are requested to vote by circling your preference and return the ballot in the enclosed envelope to the Association Secretary by October 15th. Again, APOR recommends you approve this revision.

Sincerely,



Nina Weinberg  
 President

## BALLOT

I (agree) ~~(disagree)~~ with the proposed revision to the Covenants, Conditions and Restrictions (CCRs) proposed for Riverhill Townhouse Tract 8.

Signed Deane E. Skilleen Date Oct 6, 2001

## ASSOCIATION OF PROPERTY OWNERS OF RIVERHILL, INC.

P.O. Box 293895

Kerrville, Texas 78029-3895

*"Best Buy In Riverhill"*

BOARD OF DIRECTORS: Larry Denton, Bill Ellis, Porter Garner, Mack Hamilton, Nina Weinberg (President)  
 Officers: Wendell Bingham (Secretary), Beverly McHenry (Treasurer)

October 4, 2001

To All Property Owners  
 Riverhill Town House Tract 8

Dear Property Owner,

It has been requested that the Covenants, Conditions and Restrictions (CCRs) pertaining to roofing be revised to permit composition roofing on housing in Block 1, Riverhill Town House Tract 8. Since all other Riverhill tracts permit composition roofing, the Association of Property Owners of Riverhill (APOR) believes it is appropriate to permit such roofing in Town House Tract 8, Block 1.

The proposed revision follows. Refer to Supplemental Declaration of Covenants, Conditions and Restrictions, Volume 264, Page 457-8.

## Building Restrictions

## (a) Block 1- GOLF COURSE LOTS

(VIII) Currently reads: Roofs shall be cedar shingle, tile, or metal.  
 Metal roofs must be painted, baked on finish, or acidized.

Proposed to read: Roofs shall be cedar shingle, tile, metal or composition (300 lb/sq or more). Metal roofs must be painted, baked on finish or acidized.

The proposed reading is identical to restrictions that applies to Block 2 (bounded by Rolling Green, Preston Trail and Oakland Hills Lane and Block 3 (Oakland Hills Lane facing Highway 173). As proposed the revised restriction is compatible with all other tracts in Riverhill.

To become effective, the revision must be approved by more than 50% of the homeowners in Tract 8. All owners in Tract 8 are receiving this notice and ballot. You are requested to vote by circling your preference and return the ballot in the enclosed envelope to the Association Secretary by October 15th. Again, APOR recommends you approve this revision.

Sincerely,



Nina Weinberg  
 President

## BALLOT

☒ (agree) ☐ (disagree) with the proposed revision to the Covenants, Conditions and Restrictions (CCRs) proposed for Riverhill Townhouse Tract 8.

Signed

Date 10-5-01



JACK A. RAMER # 719



# ASSOCIATION OF PROPERTY OWNERS OF RIVERHILL, INC.

P.O. Box 293895  
Kerrville, Texas 78029-3895  
"Best Buy In Riverhill"

BOARD OF DIRECTORS: Larry Denton, Bill Ellis, Porter Garner, Mack Hamilton, Nina Weinberg (President)  
Officers: Wendell Bingham (Secretary), Beverly McHenry (Treasurer)

October 4, 2001

To All Property Owners  
Riverhill Town House Tract 8

Dear Property Owner,

It has been requested that the Covenants, Conditions and Restrictions (CCRs) pertaining to roofing be revised to permit composition roofing on housing in Block 1, Riverhill Town House Tract 8. Since all other Riverhill tracts permit composition roofing, the Association of Property Owners of Riverhill (APOR) believes it is appropriate to permit such roofing in Town House Tract 8, Block 1.

The proposed revision follows. Refer to Supplemental Declaration of Covenants, Conditions and Restrictions, Volume 264, Page 457-B.

## Building Restrictions

### (a) Block 1- GOLF COURSE LOTS

(VIII) Currently reads: Roofs shall be cedar shingle, tile, or metal.  
Metal roofs must be painted, baked on finish, or acidized.

Proposed to read: Roofs shall be cedar shingle, tile, metal or composition (300 lb/sq or more). Metal roofs must be painted, baked on finish or acidized.

The proposed reading is identical to restrictions that applies to Block 2 (bounded by Rolling Green, Preston Trail and Oakland Hills Lane and Block 3 (Oakland Hills Lane facing Highway 173). As proposed the revised restriction is compatible with all other tracts in Riverhill.

To become effective, the revision must be approved by more than 50% of the homeowners in Tract 8. All owners in Tract 8 are receiving this notice and ballot. You are requested to vote by circling your preference and return the ballot in the enclosed envelope to the Association Secretary by October 15th. Again, APOR recommends you approve this revision.

Sincerely,

*Nina Weinberg*

Nina Weinberg  
President

## BALLOT

I ☒ agree ☐ (disagree) with the proposed revision to the Covenants, Conditions and Restrictions (CCRs) proposed for Riverhill Townhouse Tract 8.

Signed

*J.R. Brodman Jr.*

Date

*10-6-01*

J.R. Brodman Jr.  
525 Oakland Hills Ln.

## ASSOCIATION OF PROPERTY OWNERS OF RIVERHILL, INC.

P.O. Box 293895  
 Kerrville, Texas 78029-3895  
 "Best Buy In Riverhill"

BOARD OF DIRECTORS: Larry Denton, Bill Ellis, Porter Garner, Mack Hamilton, Nina Weinberg (President)  
 Officers: Wendell Bingham (Secretary), Beverly McHenry (Treasurer)

October 4, 2001

To All Property Owners  
 Riverhill Town House Tract 8

Dear Property Owner,

It has been requested that the Covenants, Conditions and Restrictions (CCRs) pertaining to roofing be revised to permit composition roofing on housing in Block 1, Riverhill Town House Tract 8. Since all other Riverhill tracts permit composition roofing, the Association of Property Owners of Riverhill (APOR) believes it is appropriate to permit such roofing in Town House Tract 8, Block 1.

The proposed revision follows. Refer to Supplemental Declaration of Covenants, Conditions and Restrictions, Volume 264, Page 457-8.

Building Restrictions

(a) Block 1- GOLF COURSE LOTS

(VIII) Currently reads: Roofs shall be cedar shingle, tile, or metal.  
 Metal roofs must be painted, baked on finish, or acidized.

Proposed to read: Roofs shall be cedar shingle, tile, metal or composition (300 lb/sq or more). Metal roofs must be painted, baked on finish or acidized.

The proposed reading is identical to restrictions that applies to Block 2 (bounded by Rolling Green, Preston Trail and Oakland Hills Lane and Block 3 (Oakland Hills Lane facing Highway 173). As proposed the revised restriction is compatible with all other tracts in Riverhill.

To become effective, the revision must be approved by more than 50% of the homeowners in Tract 8. All owners in Tract 8 are receiving this notice and ballot. You are requested to vote by circling your preference and return the ballot in the enclosed envelope to the Association Secretary by October 15th. Again, APOR recommends you approve this revision.

Sincerely,

*Nina Weinberg*

Nina Weinberg  
 President

BALLOT

I (agree) (~~disagree~~) with the proposed revision to the Covenants, Conditions and Restrictions (CCRs) proposed for Riverhill Townhouse Tract 8.

Signed

*James O. Updegraff*

Date

*10-9-01*

## ASSOCIATION OF PROPERTY OWNERS OF RIVERHILL, INC.

P.O. Box 293895  
 Kerrville, Texas 78029-3895  
 "Best Buy In Riverhill"

BOARD OF DIRECTORS: Larry Denton, Bill Ellis, Porter Garner, Mack Hamilton, Nina Weinberg (President)  
 Officers: Wendell Bingham (Secretary), Beverly McHenry (Treasurer)

October 4, 2001

To All Property Owners  
 Riverhill Town House Tract 8

Dear Property Owner,

It has been requested that the Covenants, Conditions and Restrictions (CCRs) pertaining to roofing be revised to permit composition roofing on housing in Block 1, Riverhill Town House Tract 8. Since all other Riverhill tracts permit composition roofing, the Association of Property Owners of Riverhill (APOR) believes it is appropriate to permit such roofing in Town House Tract 8, Block 1.

The proposed revision follows. Refer to Supplemental Declaration of Covenants, Conditions and Restrictions, Volume 264, Page 457-8.

**Building Restrictions**

**(a) Block 1- GOLF COURSE LOTS**

(VIII) Currently reads: Roofs shall be cedar shingle, tile, or metal.  
 Metal roofs must be painted, baked on finish, or acidized.

Proposed to read: Roofs shall be cedar shingle, tile, metal or composition (300 lb/sq or more). Metal roofs must be painted, baked on finish or acidized.

The proposed reading is identical to restrictions that applies to Block 2 (bounded by Rolling Green, Preston Trail and Oakland Hills Lane and Block 3 (Oakland Hills Lane facing Highway 173). As proposed the revised restriction is compatible with all other tracts in Riverhill.

To become effective, the revision must be approved by more than 50% of the homeowners in Tract 8. All owners in Tract 8 are receiving this notice and ballot. You are requested to vote by circling your preference and return the ballot in the enclosed envelope to the Association Secretary by October 15th. Again, APOR recommends you approve this revision.

Sincerely,

*Nina Weinberg*

Nina Weinberg  
 President

**BALLOT**

I (agree) (disagree) with the proposed revision to the Covenants, Conditions and Restrictions (CCRs) proposed for Riverhill Townhouse Tract 8.

Signed

*Robert Weinberger*

Date

*10/8/01*

## ASSOCIATION OF PROPERTY OWNERS OF RIVERHILL, INC.

P.O. Box 293895

Kerrville, Texas 78029-3895

"Best Buy In Riverhill"

BOARD OF DIRECTORS: Larry Denton, Bill Ellis, Porter Garner, Mack Hamilton, Nina Weinberg (President)  
 Officers: Wendell Bingham (Secretary), Beverly McHenry (Treasurer)

October 4, 2001

To All Property Owners  
 Riverhill Town House Tract 8

Dear Property Owner,

It has been requested that the Covenants, Conditions and Restrictions (CCRs) pertaining to roofing be revised to permit composition roofing on housing in Block 1, Riverhill Town House Tract 8. Since all other Riverhill tracts permit composition roofing, the Association of Property Owners of Riverhill (APOR) believes it is appropriate to permit such roofing in Town House Tract 8, Block 1.

The proposed revision follows. Refer to Supplemental Declaration of Covenants, Conditions and Restrictions, Volume 264, Page 457-8.

## Building Restrictions

## (a) Block 1- GOLF COURSE LOTS

(VIII) Currently reads: Roofs shall be cedar shingle, tile, or metal.  
 Metal roofs must be painted, baked on finish, or acidized.

Proposed to read: Roofs shall be cedar shingle, tile, metal or composition (300 lb/sq or more). Metal roofs must be painted, baked on finish or acidized.

The proposed reading is identical to restrictions that applies to Block 2 (bounded by Rolling Green, Preston Trail and Oakland Hills Lane and Block 3 (Oakland Hills Lane facing Highway 173). As proposed the revised restriction is compatible with all other tracts in Riverhill.

To become effective, the revision must be approved by more than 50% of the homeowners in Tract 8. All owners in Tract 8 are receiving this notice and ballot. You are requested to vote by circling your preference and return the ballot in the enclosed envelope to the Association Secretary by October 15th. Again, APOR recommends you approve this revision.

Sincerely,



Nina Weinberg  
 President

## BALLOT

I (agree) (disagree) with the proposed revision to the Covenants, Conditions and Restrictions (CCRs) proposed for Riverhill Townhouse Tract 8.

Signed

Date

4 Oct '01

DICK SMITH

# ASSOCIATION OF PROPERTY OWNERS OF RIVERHILL, INC.

P.O. Box 293895

Kerrville, Texas 78029-3895

*"Best Buy In Riverhill"*

BOARD OF DIRECTORS: Larry Deaton, Bill Ellis, Porter Garner, Mack Hamilton, Nina Weinberg (President)  
 Officers: Wendell Bingham (Secretary), Beverly McHenry (Treasurer)

October 4, 2001

To All Property Owners  
 Riverhill Town House Tract 8

Dear Property Owner,

It has been requested that the Covenants, Conditions and Restrictions (CCRs) pertaining to roofing be revised to permit composition roofing on housing in Block 1, Riverhill Town House Tract 8. Since all other Riverhill tracts permit composition roofing, the Association of Property Owners of Riverhill (APOR) believes it is appropriate to permit such roofing in Town House Tract 8, Block 1.

The proposed revision follows. Refer to Supplemental Declaration of Covenants, Conditions and Restrictions, Volume 264, Page 457-8.

## Building Restrictions

### (a) Block 1- GOLF COURSE LOTS

(VIII) Currently reads: Roofs shall be cedar shingle, tile, or metal.  
 Metal roofs must be painted, baked on finish, or acidized.

Proposed to read: Roofs shall be cedar shingle, tile, metal or composition (300 lb/sq or more). Metal roofs must be painted, baked on finish or acidized.

The proposed reading is identical to restrictions that applies to Block 2 (bounded by Rolling Green, Preston Trail and Oakland Hills Lane and Block 3 (Oakland Hills Lane facing Highway 173). As proposed the revised restriction is compatible with all other tracts in Riverhill.

To become effective, the revision must be approved by more than 50% of the homeowners in Tract 8. All owners in Tract 8 are receiving this notice and ballot. You are requested to vote by circling your preference and return the ballot in the enclosed envelope to the Association Secretary by October 15th. Again, APOR recommends you approve this revision.

Sincerely,



Nina Weinberg  
 President

## BALLOT

I (agree) (disagree) with the proposed revision to the Covenants, Conditions and Restrictions (CCRs) proposed for Riverhill Townhouse Tract 8.

Signed William J. Huggins Date 10-5-01

## ASSOCIATION OF PROPERTY OWNERS OF RIVERHILL, INC.

P.O. Box 293895  
 Kerrville, Texas 78029-3895  
 "Best Buy In Riverhill"

BOARD OF DIRECTORS: Larry Denton, Bill Ellis, Porter Garner, Mack Hamilton, Nina Weinberg (President)  
 Officers: Wendell Bingham (Secretary), Beverly McHenry (Treasurer)

October 4, 2001

To All Property Owners  
 Riverhill Town House Tract 8

Dear Property Owner,

It has been requested that the Covenants, Conditions and Restrictions (CCRs) pertaining to roofing be revised to permit composition roofing on housing in Block 1, Riverhill Town House Tract 8. Since all other Riverhill tracts permit composition roofing, the Association of Property Owners of Riverhill (APOR) believes it is appropriate to permit such roofing in Town House Tract 8, Block 1.

The proposed revision follows. Refer to Supplemental Declaration of Covenants, Conditions and Restrictions, Volume 264, Page 457-8.

Building Restrictions

(a) Block 1- GOLF COURSE LOTS

(VIII) Currently reads: Roofs shall be cedar shingle, tile, or metal.  
 Metal roofs must be painted, baked on finish, or acidized.

Proposed to read: Roofs shall be cedar shingle, tile, metal or composition (300 lb/sq or more). Metal roofs must be painted, baked on finish or acidized.

The proposed reading is identical to restrictions that applies to Block 2 (bounded by Rolling Green, Preston Trail and Oakland Hills Lane and Block 3 (Oakland Hills Lane facing Highway 173). As proposed the revised restriction is compatible with all other tracts in Riverhill.

To become effective, the revision must be approved by more than 50% of the homeowners in Tract 8. All owners in Tract 8 are receiving this notice and ballot. You are requested to vote by circling your preference and return the ballot in the enclosed envelope to the Association Secretary by October 15th. Again, APOR recommends you approve this revision.

Sincerely,

*Nina Weinberg*

Nina Weinberg  
 President

BALLOT

☒ (agree) ☐ (disagree) with the proposed revision to the Covenants, Conditions and Restrictions (CCRs) proposed for Riverhill Townhouse Tract 8.

Signed

*Steve Allen*

Date

10/4/01

**ASSOCIATION OF PROPERTY OWNERS OF RIVERHILL, INC.**  
**P.O. Box 293895**  
**Kerrville, Texas 78029-3895**  
**"Best Buy In Riverhill"**

**BOARD OF DIRECTORS:** Larry Denton, Bill Ellis, Porter Garner, Mack Hamilton, Nina Weinberg (President)  
**Officers:** Wendell Bingham (Secretary), Beverly McHenry (Treasurer)

October 4, 2001

To All Property Owners  
 Riverhill Town House Tract 8

Dear Property Owner,

It has been requested that the Covenants, Conditions and Restrictions (CCRs) pertaining to roofing be revised to permit composition roofing on housing in Block 1, Riverhill Town House Tract 8. Since all other Riverhill tracts permit composition roofing, the Association of Property Owners of Riverhill (APOR) believes it is appropriate to permit such roofing in Town House Tract 8, Block 1.

The proposed revision follows. Refer to Supplemental Declaration of Covenants, Conditions and Restrictions, Volume 264, Page 457-8.

**Building Restrictions**

**(a) Block 1- GOLF COURSE LOTS**

(VIII) Currently reads: Roofs shall be cedar shingle, tile, or metal.  
 Metal roofs must be painted, baked on finish, or acidized.

Proposed to read: Roofs shall be cedar shingle, tile, metal or composition (300 lb/sq or more). Metal roofs must be painted, baked on finish or acidized.

The proposed reading is identical to restrictions that applies to Block 2 (bounded by Rolling Green, Preston Trail and Oakland Hills Lane and Block 3 (Oakland Hills Lane facing Highway 173). As proposed the revised restriction is compatible with all other tracts in Riverhill.

To become effective, the revision must be approved by more than 50% of the homeowners in Tract 8. All owners in Tract 8 are receiving this notice and ballot. You are requested to vote by circling your preference and return the ballot in the enclosed envelope to the Association Secretary by October 15th. Again, APOR recommends you approve this revision.

Sincerely,

*Nina Weinberg*

Nina Weinberg  
 President

**BALLOT**

I (agree) ~~(disagree)~~ with the proposed revision to the Covenants, Conditions and Restrictions (CCRs) proposed for Riverhill Townhouse Tract 8.

Signed

*[Signature]*

Date

10-4-01

**ASSOCIATION OF PROPERTY OWNERS OF RIVERHILL, INC.**  
**P.O. Box 293895**  
**Kerrville, Texas 78029-3895**  
**"Best Buy In Riverhill"**

**BOARD OF DIRECTORS:** Larry Denton, Bill Ellis, Porter Garner, Mack Hamilton, Nina Weinberg (President)  
**Officers:** Wendell Bingham (Secretary), Beverly McHenry (Treasurer)

October 4, 2001

To All Property Owners  
 Riverhill Town House Tract 8

Dear Property Owner,

It has been requested that the Covenants, Conditions and Restrictions (CCRs) pertaining to roofing be revised to permit composition roofing on housing in Block 1, Riverhill Town House Tract 8. Since all other Riverhill tracts permit composition roofing, the Association of Property Owners of Riverhill (APOR) believes it is appropriate to permit such roofing in Town House Tract 8, Block 1.

The proposed revision follows. Refer to Supplemental Declaration of Covenants, Conditions and Restrictions, Volume 264, Page 457-8.

**Building Restrictions**

**(a) Block 1- GOLF COURSE LOTS**

**(VIII)** Currently reads: Roofs shall be cedar shingle, tile, or metal.  
 Metal roofs must be painted, baked on finish, or acidized.

Proposed to read: Roofs shall be cedar shingle, tile, metal or composition (300 lb/sq or more). Metal roofs must be painted, baked on finish or acidized.

The proposed reading is identical to restrictions that applies to Block 2 (bounded by Rolling Green, Preston Trail and Oakland Hills Lane and Block 3 (Oakland Hills Lane facing Highway 173). As proposed the revised restriction is compatible with all other tracts in Riverhill.

To become effective, the revision must be approved by more than 50% of the homeowners in Tract 8. All owners in Tract 8 are receiving this notice and ballot. You are requested to vote by circling your preference and return the ballot in the enclosed envelope to the Association Secretary by October 15th. Again, APOR recommends you approve this revision.

Sincerely,

*Nina Weinberg*

Nina Weinberg  
 President

**BALLOT**

☒ (agree) (disagree) with the proposed revision to the Covenants, Conditions and Restrictions (CCRs) proposed for Riverhill Townhouse Tract 8.

Signed

*Sam Sykes*

Date

*10/3/01*



## ASSOCIATION OF PROPERTY OWNERS OF RIVERHILL, INC.

P.O. Box 293895

Kerrville, Texas 78029-3895

"Best Buy In Riverhill"

BOARD OF DIRECTORS: Larry Denton, Bill Ellis, Porter Garner, Mack Hamilton, Nina Weinberg (President)  
 Officers: Wendell Bingham (Secretary), Beverly McHenry (Treasurer)

October 4, 2001

To All Property Owners  
 Riverhill Town House Tract 8

Dear Property Owner,

It has been requested that the Covenants, Conditions and Restrictions (CCRs) pertaining to roofing be revised to permit composition roofing on housing in Block 1, Riverhill Town House Tract 8. Since all other Riverhill tracts permit composition roofing, the Association of Property Owners of Riverhill (APOR) believes it is appropriate to permit such roofing in Town House Tract 8, Block 1.

The proposed revision follows. Refer to Supplemental Declaration of Covenants, Conditions and Restrictions, Volume 264, Page 457-8.

## Building Restrictions

## (a) Block 1- GOLF COURSE LOTS

(VIII) Currently reads: Roofs shall be cedar shingle, tile, or metal.  
 Metal roofs must be painted, baked on finish, or acidized.

Proposed to read: Roofs shall be cedar shingle, tile, metal or composition (300 lb/sq or more). Metal roofs must be painted, baked on finish or acidized.

The proposed reading is identical to restrictions that applies to Block 2 (bounded by Rolling Green, Preston Trail and Oakland Hills Lane and Block 3 (Oakland Hills Lane facing Highway 173). As proposed the revised restriction is compatible with all other tracts in Riverhill.

To become effective, the revision must be approved by more than 50% of the homeowners in Tract 8. All owners in Tract 8 are receiving this notice and ballot. You are requested to vote by circling your preference and return the ballot in the enclosed envelope to the Association Secretary by October 15th. Again, APOR recommends you approve this revision.

Sincerely,



Nina Weinberg  
 President

## BALLOT

I ☒ agree ☐ (disagree) with the proposed revision to the Covenants, Conditions and Restrictions (CCRs) proposed for Riverhill Townhouse Tract 8.

Signed

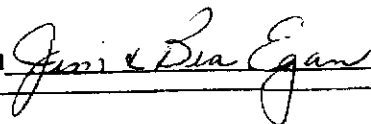

Date

Oct 3-01

VOL. 1161 PAGE 0318

**ASSOCIATION OF PROPERTY OWNERS OF RIVERHILL, INC.**  
**P.O. Box 293895**  
**Kerrville, Texas 78029-3895**  
**"Best Buy In Riverhill"**

**BOARD OF DIRECTORS:** Larry Denton, Bill Ellis, Porter Garner, Mack Hamilton, Nina Weinberg (President)  
**Officers:** Wendell Bingham (Secretary), Beverly McHenry (Treasurer)

October 4, 2001

To All Property Owners  
Riverhill Town House Tract 8

Dear Property Owner,

It has been requested that the Covenants, Conditions and Restrictions (CCRs) pertaining to roofing be revised to permit composition roofing on housing in Block 1, Riverhill Town House Tract 8. Since all other Riverhill tracts permit composition roofing, the Association of Property Owners of Riverhill (APOR) believes it is appropriate to permit such roofing in Town House Tract 8, Block 1.

The proposed revision follows. Refer to Supplemental Declaration of Covenants, Conditions and Restrictions, Volume 264, Page 457-8.

**Building Restrictions**

**(a) Block 1- GOLF COURSE LOTS**

(VIII) Currently reads: Roofs shall be cedar shingle, tile, or metal.  
Metal roofs must be painted, baked on finish, or acidized.

Proposed to read: Roofs shall be cedar shingle, tile, metal or composition (300 lb/sq or more). Metal roofs must be painted, baked on finish or acidized.

The proposed reading is identical to restrictions that applies to Block 2 (bounded by Rolling Green, Preston Trail and Oakland Hills Lane and Block 3 (Oakland Hills Lane facing Highway 173). As proposed the revised restriction is compatible with all other tracts in Riverhill.

To become effective, the revision must be approved by more than 50% of the homeowners in Tract 8. All owners in Tract 8 are receiving this notice and ballot. You are requested to vote by circling your preference and return the ballot in the enclosed envelope to the Association Secretary by October 15th. Again, APOR recommends you approve this revision.

Sincerely,

*Nina Weinberg*

Nina Weinberg  
President

**BALLOT**

I (agree) ~~(disagree)~~ with the proposed revision to the Covenants, Conditions and Restrictions (CCRs) proposed for Riverhill Townhouse Tract 8.

Signed

*Porter F. Garner*

Date

*10/3/01*

## ASSOCIATION OF PROPERTY OWNERS OF RIVERHILL, INC.

P.O. Box 293895

Kerrville, Texas 78029-3895

*"Best Buy In Riverhill"*

BOARD OF DIRECTORS: Larry Denton, Bill Ellis, Porter Garner, Mack Hamilton, Nina Weinberg (President)  
 Officers: Wendell Bingham (Secretary), Beverly McHenry (Treasurer)

October 4, 2001

To All Property Owners  
 Riverhill Town House Tract 8

Dear Property Owner,

It has been requested that the Covenants, Conditions and Restrictions (CCRs) pertaining to roofing be revised to permit composition roofing on housing in Block 1, Riverhill Town House Tract 8. Since all other Riverhill tracts permit composition roofing, the Association of Property Owners of Riverhill (APOR) believes it is appropriate to permit such roofing in Town House Tract 8, Block 1.

The proposed revision follows. Refer to Supplemental Declaration of Covenants, Conditions and Restrictions, Volume 264, Page 457-8.

## Building Restrictions

## (a) Block 1- GOLF COURSE LOTS

(VIII) Currently reads: Roofs shall be cedar shingle, tile, or metal.  
 Metal roofs must be painted, baked on finish, or acidized.

Proposed to read: Roofs shall be cedar shingle, tile, metal or composition (300 lb/sq or more). Metal roofs must be painted, baked on finish or acidized.

The proposed reading is identical to restrictions that applies to Block 2 (bounded by Rolling Green, Preston Trail and Oakland Hills Lane and Block 3 (Oakland Hills Lane facing Highway 173). As proposed the revised restriction is compatible with all other tracts in Riverhill.

To become effective, the revision must be approved by more than 50% of the homeowners in Tract 8. All owners in Tract 8 are receiving this notice and ballot. You are requested to vote by circling your preference and return the ballot in the enclosed envelope to the Association Secretary by October 15th. Again, APOR recommends you approve this revision.

Sincerely,



Nina Weinberg  
 President

## BALLOT

I agree (~~disagree~~) with the proposed revision to the Covenants, Conditions and Restrictions (CCRs) proposed for Riverhill Townhouse Tract 8.

Signed R. L. Ashjian Date 10/3/01  
Murley O. Shields

511 Oakland Hills Ln.

## ASSOCIATION OF PROPERTY OWNERS OF RIVERHILL, INC.

P.O. Box 293895

Kerrville, Texas 78029-3895

*"Best Buy In Riverhill"*

BOARD OF DIRECTORS: Larry Denton, Bill Ellis, Porter Garner, Mack Hamilton, Nina Weinberg (President)  
 Officers: Wendell Bingham (Secretary), Beverly McHenry (Treasurer)

October 4, 2001

To All Property Owners  
 Riverhill Town House Tract 8

Dear Property Owner,

It has been requested that the Covenants, Conditions and Restrictions (CCRs) pertaining to roofing be revised to permit composition roofing on housing in Block 1, Riverhill Town House Tract 8. Since all other Riverhill tracts permit composition roofing, the Association of Property Owners of Riverhill (APOR) believes it is appropriate to permit such roofing in Town House Tract 8, Block 1.

The proposed revision follows. Refer to Supplemental Declaration of Covenants, Conditions and Restrictions, Volume 264, Page 457-8.

## Building Restrictions

## (a) Block 1- GOLF COURSE LOTS

(VIII) Currently reads: Roofs shall be cedar shingle, tile, or metal.  
 Metal roofs must be painted, baked on finish, or acidized.

Proposed to read: Roofs shall be cedar shingle, tile, metal or composition (300 lb/sq or more). Metal roofs must be painted, baked on finish or acidized.

The proposed reading is identical to restrictions that applies to Block 2 (bounded by Rolling Green, Preston Trail and Oakland Hills Lane and Block 3 (Oakland Hills Lane facing Highway 173). As proposed the revised restriction is compatible with all other tracts in Riverhill.

To become effective, the revision must be approved by more than 50% of the homeowners in Tract 8. All owners in Tract 8 are receiving this notice and ballot. You are requested to vote by circling your preference and return the ballot in the enclosed envelope to the Association Secretary by October 15th. Again, APOR recommends you approve this revision.

Sincerely,



Nina Weinberg  
 President

## BALLOT

I (agree) (disagree) with the proposed revision to the Covenants, Conditions and Restrictions (CCRs) proposed for Riverhill Townhouse Tract 8.

Signed

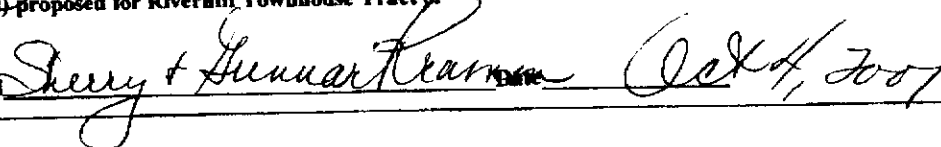

**ASSOCIATION OF PROPERTY OWNERS OF RIVERHILL, INC.**  
**P.O. Box 293895**  
**Kerrville, Texas 78029-3895**  
**"Best Buy In Riverhill"**

**BOARD OF DIRECTORS:** Larry Denton, Bill Ellis, Porter Garner, Mack Hamilton, Nina Weinberg (President)  
**Officers:** Wendell Bingham (Secretary), Beverly McHenry (Treasurer)

October 4, 2001

To All Property Owners  
 Riverhill Town House Tract 8

Dear Property Owner,

It has been requested that the Covenants, Conditions and Restrictions (CCRs) pertaining to roofing be revised to permit composition roofing on housing in Block 1, Riverhill Town House Tract 8. Since all other Riverhill tracts permit composition roofing, the Association of Property Owners of Riverhill (APOR) believes it is appropriate to permit such roofing in Town House Tract 8, Block 1.

The proposed revision follows. Refer to Supplemental Declaration of Covenants, Conditions and Restrictions, Volume 264, Page 457-8.

**Building Restrictions**

**(a) Block 1- GOLF COURSE LOTS**

**(VIII)** Currently reads: Roofs shall be cedar shingle, tile, or metal.  
 Metal roofs must be painted, baked on finish, or acidized.

Proposed to read: Roofs shall be cedar shingle, tile, metal or composition (300 lb/sq or more). Metal roofs must be painted, baked on finish or acidized.

The proposed reading is identical to restrictions that applies to Block 2 (bounded by Rolling Green, Preston Trail and Oakland Hills Lane and Block 3 (Oakland Hills Lane facing Highway 173). As proposed the revised restriction is compatible with all other tracts in Riverhill.

To become effective, the revision must be approved by more than 50% of the homeowners in Tract 8. All owners in Tract 8 are receiving this notice and ballot. **You are requested to vote by circling your preference and return the ballot in the enclosed envelope to the Association Secretary by October 15th.** Again, APOR recommends you approve this revision.

Sincerely,

*Nina Weinberg*

Nina Weinberg  
 President

**BALLOT**

I (agree) ~~(disagree)~~ with the proposed revision to the Covenants, Conditions and Restrictions (CCRs) proposed for Riverhill Townhouse Tract 8.

Signed Mrs. Marilyn C. Hoch Date 10-3-01

VOL. 1161 PAGE 0322

**ASSOCIATION OF PROPERTY OWNERS OF RIVERHILL, INC.**  
**P.O. Box 293895**  
**Kerrville, Texas 78029-3895**  
**"Best Buy In Riverhill"**

**BOARD OF DIRECTORS:** Larry Denton, Bill Ellis, Porter Garner, Mack Hamilton, Nina Weinberg (President)  
**Officers:** Wendell Bingham (Secretary), Beverly McHenry (Treasurer)

October 4, 2001

To All Property Owners  
Riverhill Town House Tract 8

Dear Property Owner,

It has been requested that the Covenants, Conditions and Restrictions (CCRs) pertaining to roofing be revised to permit composition roofing on housing in Block 1, Riverhill Town House Tract 8. Since all other Riverhill tracts permit composition roofing, the Association of Property Owners of Riverhill (APOR) believes it is appropriate to permit such roofing in Town House Tract 8, Block 1.

The proposed revision follows. Refer to Supplemental Declaration of Covenants, Conditions and Restrictions, Volume 264, Page 457-8.

**Building Restrictions**

**(a) Block 1- GOLF COURSE LOTS**

**(VIII)** Currently reads: Roofs shall be cedar shingle, tile, or metal.  
Metal roofs must be painted, baked on finish, or acidized.

Proposed to read: Roofs shall be cedar shingle, tile, metal or composition (300 lb/sq or more). Metal roofs must be painted, baked on finish or acidized.

The proposed reading is identical to restrictions that applies to Block 2 (bounded by Rolling Green, Preston Trail and Oakland Hills Lane and Block 3 (Oakland Hills Lane facing Highway 173). As proposed the revised restriction is compatible with all other tracts in Riverhill.

To become effective, the revision must be approved by more than 50% of the homeowners in Tract 8. All owners in Tract 8 are receiving this notice and ballot. **You are requested to vote by circling your preference and return the ballot in the enclosed envelope to the Association Secretary by October 15th.** Again, APOR recommends you approve this revision.

Sincerely,

*Nina Weinberg*

Nina Weinberg  
President

**BALLOT**

I ☒ (disagree) with the proposed revision to the Covenants, Conditions and Restrictions (CCRs) proposed for Riverhill Townhouse Tract 8.

Signed *Henry Jackson* Date \_\_\_\_\_

## ASSOCIATION OF PROPERTY OWNERS OF RIVERHILL, INC.

P.O. Box 293895

Kerrville, Texas 78029-3895

*"Best Buy In Riverhill"*

BOARD OF DIRECTORS: Larry Denton, Bill Ellis, Porter Garner, Mack Hamilton, Nina Weinberg (President)  
 Officers: Wendell Bingham (Secretary), Beverly McHenry (Treasurer)

October 4, 2001

To All Property Owners  
 Riverhill Town House Tract 8

Dear Property Owner,

It has been requested that the Covenants, Conditions and Restrictions (CCRs) pertaining to roofing be revised to permit composition roofing on housing in Block 1, Riverhill Town House Tract 8. Since all other Riverhill tracts permit composition roofing, the Association of Property Owners of Riverhill (APOR) believes it is appropriate to permit such roofing in Town House Tract 8, Block 1.

The proposed revision follows. Refer to Supplemental Declaration of Covenants, Conditions and Restrictions, Volume 264, Page 457-8.

## Building Restrictions

## (a) Block 1- GOLF COURSE LOTS

(VIII) Currently reads: Roofs shall be cedar shingle, tile, or metal.  
 Metal roofs must be painted, baked on finish, or acidized.

Proposed to read: Roofs shall be cedar shingle, tile, metal or composition (300 lb/sq or more). Metal roofs must be painted, baked on finish or acidized.

The proposed reading is identical to restrictions that applies to Block 2 (bounded by Rolling Green, Preston Trail and Oakland Hills Lane and Block 3 (Oakland Hills Lane facing Highway 173). As proposed the revised restriction is compatible with all other tracts in Riverhill.

To become effective, the revision must be approved by more than 50% of the homeowners in Tract 8. All owners in Tract 8 are receiving this notice and ballot. You are requested to vote by circling your preference and return the ballot in the enclosed envelope to the Association Secretary by October 15th. Again, APOR recommends you approve this revision.

Sincerely,



Nina Weinberg  
 President

## BALLOT

I ☒ agree ☐ (disagree) with the proposed revision to the Covenants, Conditions and Restrictions (CCRs) proposed for Riverhill Townhouse Tract 8.

Signed



Date

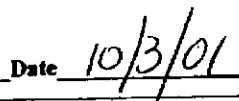

# ASSOCIATION OF PROPERTY OWNERS OF RIVERHILL, INC.

P.O. Box 293895  
Kerrville, Texas 78029-3895  
"Best Buy In Riverhill"

BOARD OF DIRECTORS: Larry Denton, Bill Ellis, Porter Garner, Mack Hamilton, Nina Weinberg (President)  
Officers: Wendell Bingham (Secretary), Beverly McHenry (Treasurer)

October 4, 2001

To All Property Owners  
Riverhill Town House Tract 8

Dear Property Owner,

It has been requested that the Covenants, Conditions and Restrictions (CCRs) pertaining to roofing be revised to permit composition roofing on housing in Block 1, Riverhill Town House Tract 8. Since all other Riverhill tracts permit composition roofing, the Association of Property Owners of Riverhill (APOR) believes it is appropriate to permit such roofing in Town House Tract 8, Block 1.

The proposed revision follows. Refer to Supplemental Declaration of Covenants, Conditions and Restrictions, Volume 264, Page 457-8.

## Building Restrictions

### (a) Block 1- GOLF COURSE LOTS

(VIII) Currently reads: Roofs shall be cedar shingle, tile, or metal.  
Metal roofs must be painted, baked on finish, or acidized.

Proposed to read: Roofs shall be cedar shingle, tile, metal or composition (300 lb/sq or more). Metal roofs must be painted, baked on finish or acidized.

The proposed reading is identical to restrictions that applies to Block 2 (bounded by Rolling Green, Preston Trail and Oakland Hills Lane and Block 3 (Oakland Hills Lane facing Highway 173). As proposed the revised restriction is compatible with all other tracts in Riverhill.

To become effective, the revision must be approved by more than 50% of the homeowners in Tract 8. All owners in Tract 8 are receiving this notice and ballot. You are requested to vote by circling your preference and return the ballot in the enclosed envelope to the Association Secretary by October 15th. Again, APOR recommends you approve this revision.

Sincerely,

*Nina Weinberg*

Nina Weinberg  
President

## BALLOT

☒ (agree) ☐ (disagree) with the proposed revision to the Covenants, Conditions and Restrictions (CCRs) proposed for Riverhill Townhouse Tract 8.

Signed

*Jane Orr Caraway*

Date

*10/6/01*



## ASSOCIATION OF PROPERTY OWNERS OF RIVERHILL, INC.

P.O. Box 293895  
 Kerrville, Texas 78029-3895  
 "Best Buy In Riverhill"

BOARD OF DIRECTORS: Larry Denton, Bill Ellis, Porter Garner, Mack Hamilton, Nina Weinberg (President)  
 Officers: Wendell Bingham (Secretary), Beverly McHenry (Treasurer)

October 4, 2001

To All Property Owners  
 Riverhill Town House Tract 8

Dear Property Owner,

It has been requested that the Covenants, Conditions and Restrictions (CCRs) pertaining to roofing be revised to permit composition roofing on housing in Block 1, Riverhill Town House Tract 8. Since all other Riverhill tracts permit composition roofing, the Association of Property Owners of Riverhill (APOR) believes it is appropriate to permit such roofing in Town House Tract 8, Block 1.

The proposed revision follows. Refer to Supplemental Declaration of Covenants, Conditions and Restrictions, Volume 264, Page 457-8.

Building Restrictions

(a) Block 1- GOLF COURSE LOTS

(VIII) Currently reads: Roofs shall be cedar shingle, tile, or metal.  
 Metal roofs must be painted, baked on finish, or acidized.

Proposed to read: Roofs shall be cedar shingle, tile, metal or composition (300 lb/sq or more). Metal roofs must be painted, baked on finish or acidized.

The proposed reading is identical to restrictions that applies to Block 2 (bounded by Rolling Green, Preston Trail and Oakland Hills Lane and Block 3 (Oakland Hills Lane facing Highway 173). As proposed the revised restriction is compatible with all other tracts in Riverhill.

To become effective, the revision must be approved by more than 50% of the homeowners in Tract 8. All owners in Tract 8 are receiving this notice and ballot. You are requested to vote by circling your preference and return the ballot in the enclosed envelope to the Association Secretary by October 15th. Again, APOR recommends you approve this revision.

Sincerely,

*Nina Weinberg*

Nina Weinberg  
 President

BALLOT

☒ (agree) ☐ (disagree) with the proposed revision to the Covenants, Conditions and Restrictions (CCRs) proposed for Riverhill Townhouse Tract 8.

Signed Polly Boucard Date 10-8-01

BALLOT

I (agree) (disagree) with the proposed revision to the Covenants, Conditions and Restrictions (CCRs) proposed for Riverhill Townhouse Tract 8.

Signed

Erueyn Hickey

Date

10/03/01

TWO LOTS = 2 VOTES

BALLOT

I (agree) (~~disagree~~) with the proposed revision to the Covenants, Conditions and Restrictions (CCRs) proposed for Riverhill Townhouse Tract 8.

Signed Margaret J. Letscher Date Oct 3, 01

BALLOT

☒ (agree) (disagree) with the proposed revision to the Covenants, Conditions and Restrictions (CCRS) proposed for Riverhill Townhouse Tract 8.

Signed Virginia S. Holladay Date 10.3.01

recommends you approve this revision.

VOL. 1161 PAGE 0329

Sincerely,

*Nina Weinberg*

Nina Weinberg  
President

BALLOT

☒ (agree) (disagree) with the proposed revision to the Covenants, Conditions and Restrictions  
(CCRs) proposed for Riverhill Townhouse Tract 8.

Signed

*Jack E. Weimer*

Date

*10/4/01*

Sincerely,

*Nina Weinberg*

Nina Weinberg  
President

BALLOT

☒ (agree) ~~(disagree)~~ with the proposed revision to the Covenants, Conditions and Restrictions (CCRs) proposed for Riverhill Townhouse Tract 8.

Signed

*Nina Weinberg*

Date 10-3-01

BALLOT

I agree (disagree) with the proposed revision to the Covenants, Conditions and Restrictions (CCRs) proposed for Riverhill Townhouse Tract 8.

*Beardsley Partners, Ltd.*

Signed *Shane Beardsley* Date *Oct. 3, 2001*

## ASSOCIATION OF PROPERTY OWNERS OF RIVERHILL, INC.

P.O. Box 293895  
 Kerrville, Texas 78029-3895  
 "Best Buy In Riverhill"

BOARD OF DIRECTORS: Larry Denton, Bill Ellis, Porter Garner, Mack Hamilton, Nina Weinberg (President)  
 Officers: Wendell Bingham (Secretary), Beverly McHenry (Treasurer)

October 4, 2001

To All Property Owners  
 Riverhill Town House Tract 8

Dear Property Owner,

It has been requested that the Covenants, Conditions and Restrictions (CCRs) pertaining to roofing be revised to permit composition roofing on housing in Block 1, Riverhill Town House Tract 8. Since all other Riverhill tracts permit composition roofing, the Association of Property Owners of Riverhill (APOR) believes it is appropriate to permit such roofing in Town House Tract 8, Block 1.

The proposed revision follows. Refer to Supplemental Declaration of Covenants, Conditions and Restrictions, Volume 264, Page 457-8.

Building Restrictions

(a) Block 1- GOLF COURSE LOTS

(VIII) Currently reads: Roofs shall be cedar shingle, tile, or metal.  
 Metal roofs must be painted, baked on finish, or acidized.

Proposed to read: Roofs shall be cedar shingle, tile, metal or composition (300 lb/sq or more). Metal roofs must be painted, baked on finish or acidized.

The proposed reading is identical to restrictions that applies to Block 2 (bounded by Rolling Green, Preston Trail and Oakland Hills Lane and Block 3 (Oakland Hills Lane facing Highway 173). As proposed the revised restriction is compatible with all other tracts in Riverhill.

To become effective, the revision must be approved by more than 50% of the homeowners in Tract 8. All owners in Tract 8 are receiving this notice and ballot. You are requested to vote by circling your preference and return the ballot in the enclosed envelope to the Association Secretary by October 15th. Again, APOR recommends you approve this revision.

Sincerely,

*Nina Weinberg*

Nina Weinberg  
 President

BALLOT

I ~~agree~~ (disagree) with the proposed revision to the Covenants, Conditions and Restrictions (CCRs) proposed for Riverhill Townhouse Tract 8.

Signed Thomas R. Smith Date 10-4-01

505 OAKLAND HILLS LN.



**ASSOCIATION OF PROPERTY OWNERS OF RIVERHILL, INC.****P.O. Box 293895****Kerrville, Texas 78029-3895****"Best Buy In Riverhill"**

**BOARD OF DIRECTORS:** Larry Denton, Bill Ellis, Porter Garner, Mack Hamilton, Nina Weinberg (President)  
**Officers:** Wendell Bingham (Secretary), Beverly McHenry (Treasurer)

October 4, 2001

To All Property Owners  
 Riverhill Town House Tract 8

Dear Property Owner,

It has been requested that the Covenants, Conditions and Restrictions (CCRs) pertaining to roofing be revised to permit composition roofing on housing in Block 1, Riverhill Town House Tract 8. Since all other Riverhill tracts permit composition roofing, the Association of Property Owners of Riverhill (APOR) believes it is appropriate to permit such roofing in Town House Tract 8, Block 1.

The proposed revision follows. Refer to Supplemental Declaration of Covenants, Conditions and Restrictions, Volume 264, Page 457-8.

**Building Restrictions****(a) Block 1- GOLF COURSE LOTS**

(VIII) Currently reads: Roofs shall be cedar shingle, tile, or metal.  
 Metal roofs must be painted, baked on finish, or acidized.

Proposed to read: Roofs shall be cedar shingle, tile, metal or composition (300 lb/sq or more). Metal roofs must be painted, baked on finish or acidized.

The proposed reading is identical to restrictions that applies to Block 2 (bounded by Rolling Green, Preston Trail and Oakland Hills Lane and Block 3 (Oakland Hills Lane facing Highway 173). As proposed the revised restriction is compatible with all other tracts in Riverhill.

To become effective, the revision must be approved by more than 50% of the homeowners in Tract 8. All owners in Tract 8 are receiving this notice and ballot. You are requested to vote by circling your preference and return the ballot in the enclosed envelope to the Association Secretary by October 15th. Again, APOR recommends you approve this revision.

Sincerely,



Nina Weinberg  
 President

**BALLOT**

I (agree) (disagree) with the proposed revision to the Covenants, Conditions and Restrictions (CCRs) proposed for Riverhill Townhouse Tract 8.

Signed

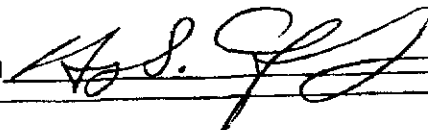

Date

10-6-01

RESERVATION OF ARCHITECTURAL CONTROL

Riverhill Club & Estates, Ltd., a Texas limited partnership ("Declarant"), being the owner of the property which is more fully described on Exhibit "A" attached hereto and made a part hereof for all purposes, said property being located in Kerr County, Texas, and desiring to provide for the preservation of the values and amenities in and upon said real property and to subject said real property to the reservation of architectural control hereinafter expressed, which reservation is for the benefit of said property and each owner thereof, as well as for the benefit of Declarant as developer thereof,

HEREBY RESERVES the right to approve or disapprove as to harmony of external design and location in relation to surrounding structures and topography any and all subdivisions, resubdivisions, exterior addition to, changes in, construction, alteration or excavation of said property or of any structure or improvement located thereon, either permanent or temporary, including without limitation additions to or of, changes in, or alterations of grade, landscaping, roadways, walkways, signs, exterior lights, walls, fences, buildings, or other structures or improvements located thereon which any person or entity including without limitation governmental subdivisions or agencies, seeks to commence, erect, place or maintain upon the aforesaid property.

Any request for such approval shall be submitted to Declarant at P.O. Box 1575, Kerrville, Texas 78028, or at such other address as may from time to time be designated of record in the office of the Recorder of Deeds for Kerr County, Texas, with a copy to William B. Sechrest, Suite 2680, 2001 Bryan Tower, Dallas, Texas 75201, or such other legal representatives as may from time to time be designated of record in the office of the aforesaid Recorder of Deeds, in writing and shall be accompanied by plans and specifications showing the nature, kind, shape, height, materials, color, location and other material attributes of the structure, improvement, addition, change, alteration or excavation. If Declarant fails to approve or disapprove such design and location within thirty (30) days after said plans and specifications have been submitted to it, approval will not be required. Declarant shall have no duty to exercise the power of approval or disapproval hereby reserved. Non-exercise of the power in one or more instances shall not be deemed to constitute a waiver of the right to exercise the power in other or different instances. Likewise, approval of any one set of plans and specifications shall not be deemed to constitute approval of any other or different plans and specifications.

The power hereby reserved may be delegated by Declarant, in its discretion from time to time, to a committee appointed, empowered and constituted by it, whose members shall serve and may be replaced at the pleasure of Declarant.

The power hereby reserved may be assigned together with, or to any person or entity owning, an interest in any portion of the aforesaid property insofar as it pertains to all or any portion of the aforesaid property. Any such

assignment must be expressed, in writing and recorded in the Office of the aforesaid Recorder of Deeds. No such assignment shall be deemed to arise by implication.

All conveyances of the aforesaid property or any portion thereof, subsequent to the date hereof, whether by Declarant or by the successors or assigns of Declarant, shall be and remain subject to this reservation until the 31st day of December, 1994, unless said reservation is specifically released by Declarant or its successors or by the assignee of the power or of a part thereof to approve or disapprove hereby reserved. Any such release may be granted at any time as to all or any part of the aforesaid property and, notwithstanding any one or more of such releases, the power hereby reserved shall remain in full force and effect as to the balance of the aforesaid property. No such release shall be effective unless in writing and recorded in the office of the aforesaid Recorder of Deeds.

Any determination by any court of competent jurisdiction that any provision of this Declaration is invalid or unenforceable shall not affect the validity or enforceability of any of the other provisions hereof.

DATED this 27th day of MAY, 1975.

RIVERHILL CLUB & ESTATES, LTD.

Filed 27th Day of May A.D. 1975 at  
EMMIE M. MUENKER 2:00 P.M.  
Clerk County Court, Kerr County, Texas  
By W. A. G. L. Jett Deputy

By: Tierra Linda Ranch Corporation,  
General Partner

By: [Signature]  
Selser R. Pickett, III, President

STATE OF TEXAS            S  
                                  S  
COUNTY OF KERR        S

BEFORE ME, the undersigned authority, on this day personally appeared SELSER R. PICKETT, III, President of Tierra Linda Ranch Corporation, General Partner of Riverhill Club & Estates, Ltd., a Texas limited partnership, known to me to be the person and officer whose name is subscribed to the foregoing instrument, and acknowledged to me that he executed the same for the purposes and consideration therein expressed, in the capacity therein stated and as the act and deed of said limited partnership.

GIVEN UNDER MY HAND AND SEAL OF OFFICE this the 27th day of MAY, 1975.



[Signature]  
NOTARY PUBLIC IN AND FOR  
KERR COUNTY, TEXAS

## TRACT 1

All that certain tract or parcel of land lying and being situated in the County of Kerr, State of Texas, comprising 19.17 acres being 19.14 acres out of Original Survey no. 147, Nathaniel Holt, Abstract No. 178, and 0.03 acre out of Original Survey No. 146, Wm. C. Francis, Abstract No. 137, this tract being Riverhill Townhouse Tracts No. One, and subject tract being more particularly described by metes and bounds, as follows, to wit:

BEGINNING at a fence corner post the South corner of that 28 acres which was conveyed from Wm. Bryant Saner to L. D. Brinkman by deed dated October 27, 1971, and recorded in Volume 152 at Page 431 of the Deed Records of Kerr County, Texas, and whose Texas Coordinates System South Central Zone are N or Y = 795,458.873, E or X = 1,955,859.093;

THENCE with fence along the NW line of Original Survey No. 147, Nathaniel Holt, S.44°59'W. 988.73 feet to an iron stake in the East line of newly widened right of way of Texas Highway No. 16;

THENCE with the East right of way of said Texas Highway No. 16, S.10°50'E. 200.0 feet to a point in said right of way;

THENCE S. 45°11'12"E. 146.5 feet to an iron stake NW of No. 16 Green of Riverhill Golf Course;

THENCE around No. 16 Green, N.70°17'E. 131.6 feet, and S.55°56'E. 105.3 feet to an iron stake the NW line of No. 17 Fairway;

THENCE along the NW line of 17 Fairway, N.32°11'E. 514.4 feet, N.39°36'E. 212.5 feet, N.14°06'W. 201.3 feet, N.31°36'E. 56.8 feet, N.50°46'E. 118.7 feet and N.29°01'E. 55.2 feet to an iron stake a SW corner of Block One of Riverhill Townhouse Tracts No. One.

THENCE with the South side of said Block One, N.77°11'E. 25.3 feet, S.75°02'E. 60.9 feet, S.69°10'E. 99.5 feet, S.38°12'E. 77.0 feet, S.5°58'W. 23.6 feet, S.54°30'E. 315.81 feet, S.80°18'E. 121.1 feet, S. 58°53'E. 204.1 feet and S.75°10'E. 318.2 feet to an iron stake the most Southerly SE corner of Block One;

THENCE WITH THE NE line of said Block One, N.14°11'E. 98.0 feet, N. 12°37'W. 192.3 feet, N.26°44'W. 240.2 feet, N.32°07'W. 209.6 feet, N.88°53'W. 334.4 feet, N.81°20'W. 372.2 feet and N.84°06'W. 124.2 feet to an iron stake SW of No. 18 Tee;

THENCE with the NE line of Fairway Drive along the arc of a circular curve to the right in a NW direction having a radius of 145.0 feet for a distance of 20 feet to a point;

THENCE crossing street, S.78°16'25"W. 40 feet to the SW line of said Fairway Drive;

THENCE with the SW line of said Fairway Drive along the arc of a circular curve to the left in a SE direction having a radius of 185 feet for a distance of 55 feet to a point;

THENCE with the arc of a circular curve to the right in a SW direction having a radius of 20 feet for a distance of 30 feet to the NW line of Sand Bend Drive;

THENCE with the NW line of said Sand Bend Drive, S.51°09'57"W.  
170 feet to the point of curvature of a circular curve to the left;  
THENCE with the arc of said circular curve in a SW direction  
having a radius of 306.22 feet for a distance of 15 feet to  
a point;

THENCE N. 45°22'W. 5 feet to the place of beginning.

TRACT 2

Lots 1, 2, 3, 4, 5, 6 & 7 of Block R and all of the  
land constituting same as shown on a plat of Riverhill  
Estates No. Two, a subdivision of Kerr County, Texas as  
recorded in Volume 4 at Page 30 of the Plat Records, Kerr  
County, Texas.

All that certain tract or parcel of land lying and being situated in the County of Kerr, State of Texas, comprising 1.48 acres of land out of Original Survey No. 147, Nathaniel Holt, Abstract No. 178, this tract being the area between Texas Highway No. 16 and No. 16 Fairway of Riverhill Golf Course, and subject tract being more particularly described by metes and bounds, as follows, to wit:

BEGINNING at an iron stake SW of No. 16 Tee, and whose Texas Coordinate System South Central Zone are N or y = 793,920.978 feet and E or x = 1.955,436.317 feet;

THENCE with the West line of No. 16 Fairway of Riverhill Golf Course, N.23°32'W. 56.1 feet, N.4°06'W. 107.3 feet, N.1°04'W. 99.1 feet, N.17°42'W. 164.0 feet, and N.22°55'W. 135.8 feet to an iron stake West of No. 16 Green, whose coordinates are N = 794,459.838 feet and E = 1.955,301.660 feet;

THENCE S.45°03'18"W. 111.44 feet to the East line of Texas Highway No. 16;

THENCE with the East line of Texas Highway No. 16, S.10°56'E. 500.75 feet to the SW corner of this tract;

THENCE N.75°07'32"E. 122.89 feet to the place of beginning;

This tract will later be subject to newly widened right of way of Texas Highway No. 16.

All that certain tract or parcel of land lying and being situated in the County of Kerr, State of Texas, comprising 14.84 acres of land out of Original Survey No. 147, Nathaniel Holt, Abstract No. 178. This tract being the area between No. 3 and No. 2 Fairways, of Riverhill Golf Course and Texas Highway No. 173, and subject tract being more particularly described by metes and bounds, as follows, to wit:

BEGINNING at an iron stake West of No. 3 Tee, and whose Texas Coordinate System South Central Zone are N or y = 794,937.845 feet, and E or x = 1,959,122.361 feet;

THENCE around the North and East side of No. 3 Fairway N. 54°18'E. 76.8 feet, S. 48°09'E. 790.4 feet, S. 11°20'E. 90.3 feet, S. 10°06'W. 93.2 feet, and S. 2°39'04" W. 240 feet to Camp Meeting Creek;

THENCE down said creek S. 66°32'W. 257.9 feet, to its intersection with the West right-of-way line of said Texas Highway No. 173;

THENCE with fence the West to SW line of said Texas Highway No. 173 N. 8°39'19" E. 462.55 feet, N. 5°30'E. 54.12 feet, N. 3°39'W. 91.86 feet, N. 11°06'W. 90.8 feet, N. 20°04' W. 97.3 feet, N. 28°51'W. 102.8 feet, N. 37°57' W. 107.4 feet, N. 41°32'W. 439.6 feet, and N. 45°12'W. 486.2 feet to a fence corner post, whose coordinates are N=795,562.325 feet and E = 1,959,266.805 feet;

THENCE S. 28°27'04"W. 521.05 feet to an iron stake East of No. 2 Green, whose coordinates are N = 795,104.203 feet and E = 1,959,018.072 feet;

THENCE with the East line of said No. 2 Green S. 55°41'E. 49.2 feet and S. 19°28' E. 45.7 feet to an iron stake;

THENCE S. 26°49'E. 106.80 feet to the place of beginning.

All that certain tract or parcel of land lying and being situated in the County of Kerr, State of Texas, comprising 10.01 acres of land out of Original Survey No. 147, Nathaniel Holt, Abstract No. 178, this tract being the area between No. 3 and No. 4 Fairways of Riverhill Golf Course, Texas Highway No. 173 and including part of Tamanaco, and subject tract being more particularly described by metes and bounds, as follows, to wit:

BEGINNING at an iron stake East of No. 4 tee, and whose Texas Coordinate System South Central Zone are  $N$  or  $y = 793,356.693$  feet, and  $E$  or  $x = 1,959,374.873$  feet;

THENCE around the South side of No. 4 tee,  $S.57^{\circ}29'E.$  57.9 feet to an ironstake;

THENCE  $S.36^{\circ}02'W.$  124.8 feet to an iron stake the East corner of Block F of Tamanaco Estates plat dated June 26, 1967 and recorded in Volume 3 at Page 21 of the Plat Records of Kerr County, Texas, in the NW line of street, Kerrville Hills Boulevard;

THENCE  $S. 45^{\circ}11'20"E.$  580.4 feet to the SE property line, the SE line of that 26.9 acre tract which was conveyed from John E. Warriner and wife to L.R. Turner Enterprises, Inc. by deed dated May 29, 1968 and recorded in Volume 133 at Page 640 of the Deed Records of Kerr County, Texas;

THENCE with said fence property line  $N.44^{\circ}48'40"E.$  481.75 feet, to a fence corner post and iron stake in the Southwest line of 120 foot wide right of way of Texas Highway No. 173;

THENCE with the SW line of said Texas Highway No. 173, along the arc of a circular curve to the right, having a central angle of  $25^{\circ}55'$  a radius of 1492.69 feet, for a distance of 670.1 feet to a fence corner post;

THENCE continuing with said right of way line  $N.9^{\circ}24'E.$  56.8 feet to the beginning of 80 foot wide right of way;

THENCE  $S.80^{\circ}36'E.$  20.0 feet to corner in West line of 80 foot wide right of way of said Texas Highway No. 173;

THENCE with the West line of said 80 foot wide right of way,  $N.8^{\circ}39'19"E.$  60 feet to its intersection with Camp Meeting Creek;

THENCE up said creek,  $N.66^{\circ}32'W.$  257.9 feet, to its intersection with the West line of said No. 3 Fairway;

THENCE around the East to South line of said No. 3 Fairway  $S.2^{\circ}39'04"W.$  484.23 feet,  $S.51^{\circ}32'W.$  90.1 feet and  $N.75^{\circ}53'W.$  182.5 feet to an iron stake, whose coordinates are  $N=793,540.035$  feet and  $E=1,959,493.862$  feet.

THENCE  $S.32^{\circ}59'W.$  218.47 feet to the place of beginning.

RECORDED'S MEMO: LEGIBILITY OF  
WRITING, TYPING OR PRINTING  
UNSATISFACTORY  
IN THIS DOCUMENT WHEN RECORDED



All that certain tract or parcel of land lying and being situated in the County of Kerr, State of Texas, comprising 13.25 acres of land out of Original Survey No. 147, Nathaniel Holt, Abstract No. 178. This tract being the area between No. 13 Fairway and South bank of lake of Camp Meeting Creek, of Riverhill Golf Course, and subject tract being more particularly described by metes and bounds, as follows, to wit:

BEGINNING at an iron stake South of No. 12 Green, and whose Texas Coordinate System South Central Zone are N or y = 793,910.180 feet, and E or x = 1,955,581.617 feet;

THENCE along No. 12 Fairway, N. 59°11' E. 147.5 feet, and N. 19°39' E. 174.6 feet to an iron stake on the South bank of lake of Camp Meeting Creek;

THENCE with the South bank of said lake, S. 84°12' E. 130.2 feet, N. 71°47' E. 144.4 feet, N. 49°46' E. 160.5 feet, N. 5°43' E. 131.9 feet, N. 38°55' E. 125.6 feet, N. 68°19' E. 116 feet, N. 65°45' E. 104.0 feet, N. 77°08' E. 190.3 feet, N. 70°44' E. 101.8 feet, N. 76°41' E. 100.4 feet, N. 80°14' E. 100.0 feet, S. 83°43' E. 103.4 feet, S. 57°39' E. 116.1 feet, S. 53°51' E. 269.6 feet, and S. 16°46' W. 184.8 feet to the North line of No. 13 Fairway, coordinates N. = 794,286.962, E = 1,957,206.260;

THENCE with the North line of No. 13 Fairway, S. 87°48'40" W. 439.39 feet, S. 61°21' W. 371.0 feet, S. 67°10' W. 406.9 feet, S. 77°23' W. 312.6 feet, and S. 84°47' W. 152.4 feet to an iron stake North of No. 15 Green, coordinates N = 793,852.266, E = 1,955,609.779;

THENCE N. 25°56' W. 64.4 feet to the place of beginning.

All that certain tract or parcel of land lying and being situated in the County of Kerr, State of Texas, comprising 35.87 acres of land, being 1.70 acres out of Original Survey No. 147, Nathaniel Holt, Abstract No. 178, and 34.17 acres out of Original Survey No. 146, Wm. C. Francis, Abstract No. 137, this tract being the area between Texas Highway No. 16 and No. 18 Fairway of Riverhill Golf Course, and subject tract being more particularly described by metes and bounds, as follows, to wit:

BEGINNING at a fence corner post, the East corner of that tract called 28 acres which was conveyed from Wm. Bryant Saner Sr. to L. D. Brinkman by deed dated October-27, 1971, and recorded, in Volume 52, at Page 481, of the deed records of Kerr County, Texas, and whose Texas Coordinate System South Central Zone are N or y = 796,065.550 feet, and E or x = 1,956,464.201 feet;

THENCE with property fence, N.45°08'44" W. 755.38 feet to a fence corner post and iron stake, the West corner said W. B. Saner 28 acre tract;

THENCE with property fence, S. 83°20'W. 1149.72 feet to a fence corner post and iron stake, the West corner of said W. B. Saner 28 acre tract, in the NE line of 100 foot wide right-of-way of Texas Highway No. 16;

THENCE with the NE line of 100 foot right-of-way of Texas Highway No. 16, S. 12°11'E. 1053.14 feet to an iron stake set 50 feet from and normal to center line of said Highway;

THENCE with old right-of-way line and old fence, S. 18°58' E. 92.0 feet S. 13°30'21" E. 277.69 feet to the South corner of that tract called 5.67 acres which was conveyed from Gerald D. James to L. D. Brinkman, by deed dated April 12, 1972, and recorded in Volume 154 at Page 806 of the Deed Records of Kerr County, Texas, and whose Texas Coordinates are N or y = 795,078.412 feet and E or x = 1,955,104.779 feet;

THENCE with property fence along SE line of Gerald D. James 5.67 acre tract, N. 54°14' E. 412.83 feet and N. 45°42' 30" E. 393.72 feet to a fence corner post and iron stake at its East corner and the SW line of foresaid W. B. Saner 28 acre tract;

THENCE with property fence along the SW line of said W. B. Saner 28 acre tract, S. 45°22' E. 193.25 feet to a fence corner post and iron stake, the South corner of said W. B. Saner 28 acre tract, in the NW line of Original Survey 147, Nathaniel Holt, and whose Texas Coordinates are N = 795,458.873 feet and E = 1,955,859.093 feet;

THENCE S. 58°14'06" E. 165.87 feet to an iron stake North of No. 17 green; and whose Texas coordinates are N = 795,371.553 feet and E = 1,956,000.117 feet;

THENCE with the North line of said No. 17 green N. 29°01' E. 55.2 feet to an iron stake;

THENCE N. 4°16'12" E. 230.51 feet to an iron stake SW of No. 18 tee;

THENCE around No. 18 Fairway N. 4°04' W. 89.4 feet, N. 82°41' E. 262.7 feet and N. 73°33' E. 250.4 feet to an iron stake;

THENCE N. 18°13'40" W. 234.08 feet to the place of beginning.

This tract will later be subject to newly widened right-of-way of Texas Highway No. 16.

All that certain tract or parcel of land lying and being situated in the County of Kerr, State of Texas, comprising 12.59 acres of land out of Original Survey No. 147, Nathaniel Molt, Abstract No. 178, this tract being the area between Texas Highway No. 16 and No. 15 Fairway of Riverhill Golf Course, and subject tract being more particularly described by metes and bounds, as follows, to wit:

BEGINNING at an iron stake, the most Westerly N.W. corner of Tamanaco Estates, plat dated June 26, 1967 and recorded in Volume 3 at Page 21 of the Plat Records of Kerr County, Texas, and whose Texas Coordinate System South Central Zone are N or y = 792,659.227 feet and E or x = 1,955,427.521 feet;

THENCE with the North line of said Tamanaco Estates, N.86°55'E. 356.74 feet, N. 82°44'E. 50.1 feet and N. 72°50'E. 209.15 feet to an iron stake, the NE corner of Lot No. 1, Block B of said Tamanaco Estates;

THENCE with the West line of No. 15 Fairway of Riverhill Golf Course, N.72°50'E. 48.7 feet, N.18°00'18"W. 664.77 feet, N.48°40'W. 370.7 feet, N.20°22'W. 125.7 feet, N.3°00'E. 63.4 feet, and N. 58°31'E. 63.6 feet to an iron stake North of No. 15 Green, coordinates N = 793,852.266 feet and E = 1,955,609.779 feet;

THENCE N. 25°56'W. 64.4 feet to an iron stake South of No. 12 Green, coordinates are N. = 793,910.180 feet and E = 1,955,581.617 feet;

THENCE with the South line of No. 16 Tee, N.85°45'W. 145.7 feet to an iron stake;

THENCE S.75°07'30"W. 122.89 feet, to the East line of Texas Highway No. 16;

THENCE with the East line of Texas Highway No. 16, S.10°56'E. 310.95 feet to the point of Curvature of a circular curve to the right;

THENCE with the arc of said circular curve to the right, whose angle is 9°47', having a radius of 2331.83 feet for a distance of 398.1 feet to the end of said curve;

THENCE with the East line of said Texas Highway No. 16, S.1°09'E. 529.6 feet to the place of beginning.

This tract will later be subject to newly widened right-of-way of Texas Highway No. 16.

All that certain tract or parcel of land lying and being situated in the County of Kerr, State of Texas, comprising 19.06 acres of land out of Original Survey No. 147, Nathaniel Holt, Abstract No. 178. This tract being the area between No. 4 and No. 6 Fairways of Riverhill Golf Course, Camp Meeting Creek and Block L of Tamanaco Estates, and subject tract being more particularly described by metes and bounds, as follows, to wit:

BEGINNING at an iron stake the NE corner of Block L of said Tamanaco Estates, Plat dated June 26, 1967 and recorded in Volume 3 at Page 21 of the Plat Records of Kerr County, Texas and in the NW line of Kerrville Hills Drive, and whose Texas Coordinate System Central Zone are N or y = 793,224.646 feet, and E or x = 1,959,252.636 feet;

THENCE with the North line of said Block L N. 66°39' W. 1010.0 feet, N. 34°25' W. 145.0 feet, N. 74°22' W. 182.35 feet and S. 44°07' W. 725.0 feet to an iron stake a Westerly corner of said Block L, the East Line of No. 6 Fairway, having coordinates of N = 793,277.840 feet and E = 1,957,563.478 feet;

THENCE along the East line of No. 6 Fairway, N. 4°01' E. 655.64 feet, and N. 41°11' E. 160.0 feet to the center of Camp Meeting Creek;

THENCE down the center of said Camp Meeting Creek, S. 89°43' E. 321.7 feet, N. 63°08' E. 439.9 feet and N. 33°15' E. 245.8 feet to an iron stake West of No. 4 Green;

THENCE with the West line of No. 4 Fairway, S. 18°17' E. 436.8 feet, S. 38°58' E. 173.6 feet, S. 48°50' E. 181.1 feet and S. 39°31' E. 597.0 feet to an iron stake behind No. 4 Tee, whose coordinates are N = 793,325.569 feet and E = 1,959,326.050 feet;

THENCE S. 36°02' W. 124.8 feet to the place of beginning.

All that certain tract or parcel of land lying and being situated in the County of Kerr, State of Texas, comprising 13.62 acres of land out of Original Survey No. 147, Nathaniel Holt, Abstract No. 178. This tract being the area between No. 1 and No. 2 Fairways, Camp Meeting Creek, and No. 8 and No. 9 Fairways of Riverhill Golf Course, and subject tract being more particularly described by metes and bounds, as follows, to wit:

BEGINNING at an iron stake West of No. 2 tee, and whose Texas Coordinate System South Central Zone are N or y = -795,209.896 feet, and E or x = 1,958.351.542 feet;

THENCE with SW line of No. 2 Fairway, S. 58°42' E. 394.8 feet, S. 34°58' E. 82.2 feet to the center of aforesaid Camp Meeting Creek;

THENCE up the center of said Camp Meeting Creek, S. 40°36' W. 244.7 feet to North line of No. 5 Fairway;

THENCE with the North line of No. 5 Fairway, S. 67°55' W. 197.1 feet, S. 60°32' W. 263.4 feet, S. 73°39' W. 327.7 feet, N. 24°35' W. 172.7 feet, N. 18°24' W. 146.5 feet, N. 56°22' W. 53.4 feet, and N. 62°17' W. 103.4 feet to an iron stake East of No. 9 Fairway, coordinates N = 794,829.439, E = 1,357,596.246;

THENCE with the East line of No. 9 Fairway, N. 7°20' W. 252.3 feet, and N. 2°37' W. 245.8 feet to an iron stake SW of No. 1 Fairway;

THENCE around the SW line to South line of No. 1 Fairway, S. 60°29' E. 177.6 feet, S. 66°46' E. 279.1 feet, S. 73°29' E. 64.8 feet, and N. 76°32' E. 72.6 feet, N. 54°32' E. 57.9 feet, N. 44°25' E. 83.8 feet and N. 10°31' E. 65.2 feet to an iron stake;

THENCE S. 61°44'50"E. 155.83 feet to the place of beginning.

All that certain tract or parcel of land lying and being situated in the County of Kerr, State of Texas, comprising 11.16 acres of land out of Original Survey No. 147, Nathaniel Holt, Abstract No. 178, this tract being the area between No. 2 and No. 4 Fairways, and No. 3 Fairway of Riverhill Golf Course, and subject tract being more particularly described by metes and bounds, as follows, to wit:

BEGINNING at an iron stake East of No. 4 Tee, and whose Texas Coordinate System South Central Zone are N or y = 793,356.693 feet, and E or x = 1,959,374.873 feet;

THENCE with the East line of No. 4 Fairway, N 20°32'W. 502.0 feet, N. 31°44'W. 459.0 feet, N. 6°03'W. 404.1 feet and N. 15°36'W. 102.1 feet to an iron stake South of No. 2 Green;

THENCE around No. 2 Green, N. 22°07'E. 81.6 feet. N. 43°4' E. 102.8 feet, and N. 27°24'E. 186.2 feet to an iron stake East of No. 2 Green, whose coordinates are N = 795,033.378 feet and E = 1,959,073.937 feet;

THENCE S. 26°49'E. 106.80 feet, to an iron stake West of No. 3 Tee, whose coordinates are N = 794,937.845 feet and E = 1,959,122.361 feet;

THENCE around the West side of No. 3 Fairway, S. 28°01'E. 151.7 feet, S. 7°16'E. 93.1 feet, S. 35°25'E. 116.5, S. 32°48'E. 395.7 feet, S. 1°16'W. 305.0 feet, S. 4°01'W. 348.4 feet and S. 22°18' E. 97.0 feet to an iron stake West of No. 3 Green, whose coordinates are N = 793,540.035 feet and E = 1,959.493.862;

THENCE S. 32°59'W. 218.57 feet to the place of beginning.

All that certain tract or parcel of land lying and being situated in the County of Kerr, State of Texas, comprising 2.3 acres of land out of Original Survey No. 147, Nathaniel Holt, Abstract No. 178, this tract being the area between Kerrville Hills Country Club Estates and No. 7 Fairway of Riverhill Golf Course, and subject tract being more particularly described by metes and bounds, as follows, to wit:

BEGINNING at an iron stake, the South corner of Lot 14, Block F, of Kerrville Hills Country Club Estates, plat dated March 31, 1971 and recorded in Volume 3, Page 70 of the Plat Records of Kerr County, Texas, and in the East right-of-way line of street Burning Hills Drive;

THENCE with the East line of said street with the arc of a circular curve to the right having a radius of 298.79 feet, for a distance of 47.12 feet to the end of curve;

THENCE continuing with said street,  $S.33^{\circ}45'E.$  150.18 feet to the point of curvature of a circular curve to the right;

THENCE with the arc of said circular curve to the right, having a radius of 628.30 feet, where the chord bearing and distance is  $S.29^{\circ}12'E.$  99.69 feet, for a distance of 99.79 feet to the end of curve;

THENCE continuing with said street  $S.24^{\circ}19'E.$  174.14 feet to an iron stake the beginning of a curve, and the South corner of this tract;

THENCE with the West line of No. 7 Fairway,  $N.65^{\circ}28'E.$  17.1 feet and  $N.6^{\circ}58'W.$  676.6 feet to an iron stake whose Texas Coordinate System South Central Zone arc N or y = 793,534.837 feet and E or x = 1,957,068.386;

THENCE along the South bank of ponds of Riverhill Golf Course,  $N.67^{\circ}33'W.$  101.9 feet,  $N.78^{\circ}25'W.$  39.4 feet,  $S.80^{\circ}06'W.$  40.4 feet,  $N.63^{\circ}14'W.$  72.3 feet,  $N.33^{\circ}17'W.$  66.0 feet and  $N.55^{\circ}40'W.$  49.49 feet to an iron stake in concrete lined ditch;

THENCE with concrete ditch,  $S.2^{\circ}44'E.$  95.72 feet to an "X" in concrete set to mark the North corner of said Lot 14, Block F;

THENCE with the East line of said Lot 14,  $S.61^{\circ}33'E.$  429.15 feet,  $S.18^{\circ}49'E.$  200.08 feet and  $S.22^{\circ}57'W.$  84.78 feet to the place of beginning.

All that certain tract or parcel of land lying and being situated in the County of Kerr, State of Texas, comprising 0.77 acres of land out of Original Survey No. 147, Nathaniel Holt, Abstract No. 178, this tract being the area between No. 7 Tee of Riverhill Golf Course and Block L of Tamanaco Estates, subject tract being more particularly described by metes and bounds, as follows, to wit:

BEGINNING at an iron stake, the NW corner of Lot 2, Block L of Tamanaco Estates, plat dated June 26, 1967 and recorded in Volume 3 at Page 21 of the Plat Records of Kerr County, Texas, in the East line of street, Burning Hills Drive;

THENCE with the North line of said Block L, N. 64°16'E. 113.69 feet, to an iron stake, the NW corner of Lot 4, Block L, Tamanaco Estates;

THENCE N. 7°04'E. 257.8 feet to an iron stake;

THENCE around the South side of No. 7 Tee, S. 69°35'W. 114.0 feet and S. 80°38'W. 63.0 feet to an iron stake in the East line of said Burning Hills Drive;

THENCE with the East line of said Burning Hills Drive, S. 10°41'E. 27.2 feet to an iron stake, the point of curvature of a circular curve to the right;

THENCE with arc of said circular curve to the right, having a radius of 1789.45 feet, whose long chord bearing and distance is S. 8°17'E. 149.87 feet for a distance of 149.91 feet to the end of said curve;

THENCE continuing with said street line, S. 5°53'E. 80.56 feet to the place of beginning.



All that certain tract or parcel of land lying and being situated in the County of Kerr, State of Texas, comprising 1.14 acres of land out of Original Survey No. 147, Nathaniel Holt, Abstract No. 178, this tract being the area between No. 15 Tee of Riverhill Golf Course and Block B and F of Tamanaco Estates, and subject tract being more particularly by metes and bounds, as follows, to wit:

BEGINNING at an iron stake the SE corner of Lot 1, Block B of Tamanaco Estates, plat dated June 26, 1967 and recorded in Volume 3 at Page 21 of the Plat Records of Kerr County, Texas, in the North line of street, Singing Hills Boulevard;

THENCE with the North line of said Boulevard with the arc of a circular curve to the right having a radius of 257.07 feet, a long chord bearing and distance of S.64°10'E. 170.07 feet, for a distance of 173.34 feet to the end of said curve;

THENCE continuing with the North line of said Boulevard S.44°51'E. 47.16 feet to an iron stake, the West corner of Lot No. 1, Block F of Tamanaco Estates;

THENCE with the North line of Lot No. 1, Block F, N.54°19'E. 160.0 feet to an iron stake a North corner of Lot No. 1, Block F;

THENCE N. 9°24'36"E. 162.42 feet to an iron stake;

THENCE around the South side of No. 15 Tee, S. 67°05'W. 119.7 feet, S.76°40'W. 88.2 feet and N.44°39'36"W. 117.51 feet to an iron stake the most Easterly corner at Block B;

THENCE with the SE line of said Block B, S.21°52'W. 172.62 feet to the place of beginning.

EXHIBIT A - PAGE 14

Filed for record May 27, 1975 at 2:00 o'clock P.M.

Recorded May 29, 1975

EMMIE M. MUENKER, Clerk

By Melinda Abrams Deputy

## DECLARATION OF COVENANTS, CONDITIONS AND RESTRICTIONS

751884

This Declaration of Covenants, Conditions and Restrictions (hereinafter termed the "Declaration") is made this 27th day of MAY, 1975 by Riverhill Club & Estates, Ltd., a Texas limited partnership (hereinafter sometimes termed "Declarant").

## W I T N E S S E T H :

WHEREAS, Declarant owns and desires to develop the "Property" hereinafter defined.

WHEREAS, Declarant owns or may acquire additional real property which Declarant may place subject to this Declaration for purposes of developing all at one time or in stages.

WHEREAS, in order to enable Declarant to accomplish such development in a consistent manner with continuity, Declarant desires to place the Property, subject to the covenants, conditions, assessments, charges, servitudes, liens, easements and reservations (hereinafter collectively termed "Covenants") hereinafter set forth.

NOW, THEREFORE, Declarant hereby declares that the Property shall be held, sold and conveyed subject to the Covenants.

## ARTICLE I

## DEFINITIONS

The following words, phrases or terms used in this Declaration shall have the following meanings:

A. "Covenants" shall mean the covenants, conditions, easements, charges, servitudes, liens, reservations and assessments set forth herein.

B. "Declarant" shall mean Riverhill Club & Estates, Ltd., a Texas limited partnership, and the successors and assigns of Declarant's rights and powers hereunder.

C. "Declaration" shall mean this Declaration of Covenants, Conditions and Restrictions, as amended or supplemented from time to time.

D. "Deed" shall mean a deed or other instrument conveying the fee simple title to a "Lot."

E. "Dwelling Unit" shall mean any portion of a building designed and used for single family residential purposes including, but not limited to, such building and any carport or other structure related thereto or used in conjunction therewith and the Lot upon which the building is located.

F. "Maintenance Cost" shall mean any and all costs assessed pursuant to Article IV and Article IX hereof.

G. "Maintenance Lien" shall mean with respect to any Lot, the lien created and imposed pursuant to Article V hereof securing any Maintenance Cost.

H. "Lot" shall mean and refer to any lot, tract or parcel of the Property (with the exception of any common area, if any, and any "open areas" reserved by Declarant on any plat) shown upon a plat or plats of the Property filed for record in the Map and Plat Records of Kerr County, Texas (as such plat or plats may be amended from time to time). The phrase "open areas" shall mean those areas of the Property including but not limited to streets which are not designated by number as lots, the ownership of such areas being reserved to Declarant and its successors and assigns. (The streets shown on such plats unless otherwise stated on such plats have not been dedicated to the public i.e. the streets are private streets.)

I. "Owner" shall mean and refer to the person or persons, entity or entities, who either own of record fee simple title to a Lot, or have entered as an original party, successor or assignee into a Contract for Deed with Declarant; the term "Owner" to exclude any person or persons, entity or entities, having an interest in a Lot merely as security for the performance of an obligation; the term "Owner" to include Declarant if Declarant is a record owner of fee simple title to a Lot, but only if, with respect to such Lot, Declarant has not entered into any Contract for Deed. For purposes hereof, the term "Contract for Deed" shall be any contract executed by Declarant with another person containing as its title or as part of its title the term "Contract for Deed" pursuant to which such person is acquiring a Lot on an installment basis whereby Declarant does not transfer fee simple title to the Lot until such person has satisfied all the terms and conditions of such contract.

J. "Property" shall mean:

(i) At the time of recordation of this Declaration, the land described on Exhibit "A" attached hereto and made a part hereof for all purposes; and

(ii) From and after the addition of each parcel of land subjected to this Declaration pursuant to Article XII hereof, each such new parcel of land.

## ARTICLE II

### COVENANTS BINDING ON PROPERTY AND OWNERS

Section 1: Property Bound. From and after the date of recordation of this Declaration, the Property shall be subject to the Covenants and said Covenants shall run with, be for the benefit of, and bind and burden the Property.

Section 2: Owners Bound. From and after the date of recordation of this Declaration, the Covenants shall be binding upon and for the benefit of each Owner and his heirs, executors, administrators, trustees, personal representatives, successors and assigns, whether or not so provided or otherwise mentioned in the Deed. Each Owner for himself, his heirs, executors, administrators, trustees, personal representatives, successors and assigns, expressly agrees to pay, and to be personally liable for, assessments provided for hereunder, and to be bound by all of the Covenants herein set forth. Each Owner shall be and remain personally liable, regardless of whether he has transferred title to his Lot, for the amount of assessments (together with interest thereon, cost of collection and attorneys' fees, if any) which fell due while he was an Owner. No Owner shall escape personal liability for the assessments herein provided by non-use of or by transfer or abandonment of his Lot. The Owner's personal obligation shall

not pass to a successor Owner unless expressly assumed by the successor Owner; but any such assumption of personal liability by the successor Owner shall not relieve the prior Owner of his personal liability for the amount of assessment which fell due while the prior Owner was an Owner.

### ARTICLE III

#### USE RESTRICTIONS

Section 1: All Properties. All Lots within the Property are hereby restricted as follows:

(a) Antennas. No exterior television, radio or other antenna of any type shall be placed, allowed or maintained upon any Lot without prior written approval and authorization of the Declarant.

(b) On Street Parking. On street parking is restricted to approved deliveries, pickup or short time guests and invitees and shall be subject to such reasonable rules and regulations as shall be adopted by Declarant.

(c) Storage. No exterior storage of any items of any kind shall be permitted except with prior written approval and authorization of the Declarant. Any such storage as is approved and authorized shall be in areas attractively screened or concealed (subject to all required approvals as to architectural control) from view from neighboring property, pathways and streets. This provision shall apply without limitation, to wood piles, camping trailers, boat trailers, travel trailers, boats, mobile homes and unmounted pickup camper units. Also, without limitation, no automobile, truck or other vehicle, regardless of ownership, age, condition or appearance, shall remain on any Lot in any manner which could be construed as being stored, neglected, abandoned or otherwise not in frequent use, except pursuant to written approval and authorization of Declarant.

(d) Garbage. No garbage or trash shall be placed on the exterior of any building, except in containers meeting the specifications of the City of Kerrville and the Declarant, and the placement, maintenance and appearance of all such containers shall be subject to reasonable rules and regulations of the Declarant. All rubbish, trash and garbage shall be regularly removed from each Lot and shall not be allowed to accumulate thereon.

(e) Outside Speakers and Amplifiers. No radio, stereo, broadcast or loudspeaker units and no amplifiers of any kind shall be placed upon or outside, or be directed to the outside of any building without prior written approval and authorization of the Declarant.

(f) Outside Lighting. No outside lighting, other than indirect lighting, shall be placed, allowed or maintained on any Lot without prior written approval and authorization of the Declarant.

(g) Animals. No animals, reptiles, fish or birds of any kind shall be raised, bred or kept on

any Lot except pursuant to prior written approval of and in accordance with rules and regulations promulgated by the Declarant, provided, however, that dogs, cats, birds or fish may be kept thereon as household pets so long as, in the discretion of the Declarant, such pet is not, or does not become, a nuisance, threat or otherwise objectionable to other Owners.

(h) Re-subdivision. No Lot shall be further subdivided and no portion less than all of any such Lot, or any easement or any other interest therein, shall be conveyed by any Owner without the prior written authorization and approval of the Declarant.

(i) Diseases and Insects. No Owner shall permit any thing or condition to exist upon any Lot which shall induce, breed or harbor plant disease or noxious insects.

(j) Sidewalk Encroachments. No tree, shrub, or plant of any kind on any Lot shall be allowed to overhang or otherwise encroach upon any sidewalk or any other pedestrian way from ground level to a height of seven (7) feet without the prior written approval and authorization of the Declarant.

(k) Machinery, Fixtures and Equipment. No machinery, fixtures or equipment of any type, including without limitation heating, air conditioning or refrigeration equipment and clotheslines, shall be placed, allowed or maintained upon the ground on any Lot, except with prior written approval and authorization of the Declarant and then only in areas attractively screened or concealed (subject to all required approvals as to architectural control) from view of neighboring property, pathways and streets; and no such machinery, fixtures, or equipment shall be placed, allowed or maintained anywhere other than on the ground (such as on the roof) except if screened or concealed (subject to all required approvals as to architectural control) in such manner that the screening or concealment thereof appears to be part of the integrated architectural design of the building and does not have the appearance of a separate piece or pieces of machinery, fixtures or equipment.

(l) Utility and Service Lines. No gas, electric, power, telephone, water, sewer, cable television or other utility or service lines of any nature or kind shall be placed, allowed or maintained upon or above the ground on any Lot, except to the extent, if any, underground placement thereof may be prohibited by law or would prevent the subject line from being functional. The foregoing shall not prohibit service pedestals and above ground switch cabinets and transformers where required.

(m) Burning and Incinerators. No open fires or burning shall be permitted on any Lot at any time and no incinerators or like equipment shall be placed, allowed or maintained upon any Lot. The foregoing shall not be deemed to preclude the use, in customary fashion, of outdoor residential barbecues or grills.

(n) Signs. No exterior signs or advertisements of any kind may be placed, allowed or maintained on any Lot without prior written approval and authorization of the Declarant, except that mailboxes, residential nameplates and "for sale" and "for rent" signs may be placed and maintained in conformity with such common specifications, including without limitation, reasonable restrictions as to size, as may be adopted by the Declarant.

(o) Repairs. No repairs of any detached machinery, equipment or fixtures, including without limitation motor vehicles, shall be made upon any portion of any Lot within view of neighboring property, pathways and streets, without prior written approval and authorization of the Declarant.

(p) Oil and Mineral Activity. No oil exploration, drilling, development or refining operations and no quarrying or mining operations of any kind, including oil wells, surface tanks, tunnels, or mineral excavations or shafts shall be permitted upon or under any Lot; and no derrick or other structure designed for use in boring for oil or natural gas shall be erected, maintained or permitted on any Lot.

(q) Change in Intended Use. No portion of the Property may be developed or redeveloped otherwise than in accordance with its original intended use, without the prior written authorization and approval of the Declarant.

(r) Misuse and Mismaintenance. No Lot shall be maintained or utilized in such manner as in Declarant's judgment to present an unsightly appearance (including but not limited to clothes drying within public view), or as to unreasonably offend the morale of or as to constitute a nuisance or unreasonable annoyance to, or as to endanger the health of, other Owners or residents of the Property; and no noxious or otherwise offensive condition or activity shall be allowed to exist or be conducted thereon.

(s) Violation of Statutes, Ordinances and Regulations. No Lot shall be maintained or utilized in such manner as to violate any applicable statute, ordinance or regulation of the United States of America, the State of Texas, the County of Kerr, the City of Kerrville, if applicable, or any other governmental agency or subdivision having jurisdiction in the premises.

(t) Violation of Covenants. No Lot shall be maintained or utilized in violation of the Covenants.

(u) Motor Vehicles. Motor vehicles owned or in the custody of any Owner may be parked only in the carport or driveway located upon or pertaining to such person's Lot or Dwelling Unit, or in parking areas designed by the Declarant, unless otherwise authorized by the Declarant in writing. No buses, vans or trucks having a carrying capacity in excess of 3/4 tons or designed for commercial purposes shall be placed, allowed or maintained upon any residential Lot except with the prior written approval and authorization

of the Declarant in areas attractively screened or concealed (subject to all required approvals as to architectural control) from view of neighboring property, pathways and streets.

(v) Carports. The interiors of all carports shall be maintained by the Owners in a neat, clean and sightly condition. No carport shall be used for storage; and no power equipment, hobby shops or carpenter shops shall be maintained in any carport, nor automobile overhaul, repair or maintenance work conducted therein.

Section 2: Buildings. Buildings shall be additionally restricted as follows:

(a) New and Permanent Construction. All buildings and other structures on the Property shall be of new and permanent construction; and no structure shall be moved from any location on or off the Property onto any portion of the Property, provided, however, that temporary structures may be placed and maintained on the Property in connection with the construction of buildings, structures or improvements thereon if previously approved and authorized in writing by the Declarant. Any such temporary structure shall be promptly removed upon completion of the construction to which it relates.

(b) Prosecution of Construction, Maintenance and Repairs. All construction, maintenance and repair work shall be prosecuted diligently from commencement until completed.

(c) Maintenance. No Dwelling Unit shall be permitted to fall into disrepair and each such building and structure shall at all times be kept in good condition and repair, adequately painted or otherwise finished.

(d) Owner's Water and Sanitary Sewer Lines. All water and sanitary sewer lines from each Dwelling Unit to the common water and sanitary sewer lines (i.e. all water and sanitary sewer lines which carry water to or sewerage from such Dwelling Unit shall be maintained by the Owner of the Dwelling Unit at his own costs.

Section 3: Exemption for Purpose of Construction, Development and Sale. The Declarant shall have the right during the period of construction, development and sale, to grant reasonable and specifically limited exemptions from these restrictions to itself and any other developer or contractor. Any such exemptions shall be granted only upon specific written request, itemizing the exemption requested, the location thereof, the need therefor and the anticipated duration thereof; and any authorization and approval thereof shall be similarly itemized. No such exemption shall be broader in terms of activity, location or time than is reasonably required.

Section 4: Construction of Covenants. Nothing herein stated shall be construed as preventing an Owner from combining two or more adjacent and contiguous Lots and building thereon a Dwelling Unit.

Section 5: Right-of-Way. The Declarant or its agent with three (3) days prior written notice to the Owner shall have the right to enter upon and inspect any Lot or Dwelling Unit for the purpose of ascertaining whether or not the provisions of these Covenants have been or are being complied with and Declarant shall not be deemed guilty of trespass by reason of such entry provided such entry be made during reasonable hours of the daytime.

#### ARTICLE IV

##### IMPROPER MAINTENANCE BY OWNER

In the event any portion of a Lot or Dwelling Unit thereon is in Declarant's judgment so maintained by the Owner as to not comply with these Covenants or present a public or private nuisance or as to substantially detract from the appearance or quality of the neighboring Lots or Dwelling Units or other areas of the Property which are substantially affected thereby or related thereto, the Declarant may by resolution make a finding to this effect, specifying the particular condition or conditions which exist, and pursuant thereto deliver notice thereof to the offending Owner that unless corrective action is taken within ten (10) days, the Declarant will cause such action to be taken at such Owner's cost. If at the expiration of said ten (10) day period of time the requisite corrective action has not been taken, the Declarant shall be authorized and empowered to cause such action to be taken and the cost (the "Maintenance Cost") thereof shall be assessed against the Lot and Dwelling Unit of the offending Owner and shall be secured by the Maintenance Lien herein-after provided. Written notice of such assessment shall be delivered to the offending Owner which notice shall specify the amount of such Maintenance Cost and shall demand payment thereof within thirty (30) days after the date of said notice.

#### ARTICLE V

##### IMPOSITION OF LIEN; OWNER'S AGREEMENT

Section 1: Imposition of Maintenance Lien. Declarant shall have the right at any time there is unpaid Maintenance Cost outstanding with respect to a Lot to file of record with the County Clerk of Kerr County, Texas, a written statement describing such Lot and/or the Dwelling Unit thereon and declaring the amount of unpaid Maintenance Cost relating thereto in which event, upon such filing there shall automatically be imposed upon such Lot and the Dwelling Unit thereon a lien (the "Maintenance Lien") in favor of Declarant for the amount of such unpaid Maintenance Cost. Upon payment of all Maintenance Cost relating to any such Lot, Declarant shall file of record with the County Clerk of Kerr County, Texas, an appropriate release of any Maintenance Lien previously filed against the Lot and the Dwelling Unit thereon for such Maintenance Cost. The Maintenance Lien shall be for the sole benefit of Declarant and its successors and assigns.

Section 2: Owner's Promises Regarding Maintenance Costs and Maintenance Lien. Each Owner, for himself, his heirs, executors, administrators, trustees, personal representatives, successors and assigns, covenants and agrees:

- (a) That he will pay to the Declarant within thirty (30) days after the date of written notice thereof any Maintenance Cost assessed by the Declarant against his Lot and the Dwelling Unit thereon;



(b) That by accepting a Deed to his Lot, he shall be, and remain, personally liable for any and all Maintenance Cost assessed against his Lot and the Dwelling Unit thereon while he is (or was) the Owner thereof, regardless of whether such covenants or agreements are expressed in such Deed and regardless of whether he signed the Deed.

## ARTICLE VI

### RIGHTS AND POWERS

Section 1: Declarant as Enforcing Body. The Declarant, as the agent and representative of the Owners, shall have the exclusive right to enforce the provisions of this Declaration. However, if the Declarant shall fail or refuse to enforce this Declaration for an unreasonable period of time, after written request to do so, then any Owner may enforce this Declaration on behalf of the Declarant by any appropriate action, whether in law or in equity.

Section 2: Declarant's Remedies to Enforce Payment of Maintenance Cost. If the Owner of any Lot fails to pay the Maintenance Cost when due, the Declarant may enforce the payment of the Maintenance Cost and/or the Maintenance Lien by taking either or both of the following actions, concurrently or separately (and, by exercising either of the remedies hereinafter set forth, the Declarant does not prejudice or waive its right to exercise the other remedy):

(a) Bring an action at law and recover judgment against the Owner personally obligated to pay Maintenance Cost;

(b) Foreclose the Maintenance Lien against the Lot and the Dwelling Unit thereon in accordance with the then prevailing Texas law relating to the foreclosure of realty mortgages and liens (including the right to recover any deficiency).

Sale or transfer of any Lot shall not affect the Maintenance Lien, provided, however, that if the sale or transfer is pursuant to foreclosure of a mortgage or deed of trust, or pursuant to any sale or proceeding in lieu thereof, the purchaser at the mortgage foreclosure or deed of trust sale, or any grantee taking by deed in lieu of foreclosure, shall take the Lot and any Dwelling Unit located thereon free of the Maintenance Lien for all Maintenance Cost that have accrued up to the date of issuance of a sheriff's or trustee's deed or deed in lieu of foreclosure.

Section 3: Costs to be Borne by Owner in Connection with Enforcement of Payment of Maintenance Cost. In any action taken pursuant to Section 2 of this Article, the Owner shall be personally liable for, and the Maintenance Lien shall be deemed to secure the amount of, the Maintenance Cost together with interest thereon at the rate of eight percent (8%) per annum, the Declarant's cost and attorney's fees.

Section 4: Contracts with Others for Performance of Declarant's Duties. Subject to the restrictions and limitations contained herein, the Declarant may enter into contracts and transactions with others, including its subsidiaries and affiliated companies, and such contracts or transactions shall not be invalidated or in any way affected by the fact that one or more partners (limited or general) in Declarant and/or one or more directors of

the general partner of Declarant is employed by or otherwise connected with Declarant, its subsidiaries and affiliates, provided that the fact of such interest shall be disclosed or known to the other partners and/or directors acting upon such contract or transaction, and provided further that the transaction or contract is fair and reasonable; and any such partner and/or director may be counted in determining the existence of a quorum at any meeting which shall authorize any such contract or transaction, and may vote thereat to authorize any such contract or transaction with like force and effect as if he were not so interested.

## ARTICLE VII

### ARCHITECTURAL CONTROL

No building, fence, wall, sign, exterior light or other structure or other apparatus, either permanent or temporary, shall be commenced, erected, placed or maintained upon the Property (or any Lot constituting a part thereof), nor shall any exterior addition thereto, change therein or alteration, excavation, subdivision or resubdivision thereof, including without limitation changes in or alterations of grade, landscaping, roadways and walkways, be made until the plans and specifications showing the nature, kind, shape, height, materials, color and location and other material attributes of the same shall have been submitted to and approved in writing as to harmony of external design and location in relation to surrounding structures and topography by Declarant or by an architectural committee composed of three (3) or more representatives appointed by Declarant. In the event Declarant, or its designated committee, fails to approve or disapprove such design and location within thirty (30) days after said plans and specifications have been submitted to it, approval will not be required and this Article will be deemed to have been fully complied with.

## ARTICLE VIII

### PARTY WALLS

Section 1: General Rules of Law to Apply. Each wall which is built as a part of the original construction of a Dwelling Unit upon the Property and placed on the dividing line between the Lots shall constitute a party wall, and, to the extent not inconsistent with the provisions of this Article, the general rules of law regarding party walls and liability for property damage due to negligence or willful acts or omissions shall apply thereto.

Section 2: Sharing of Repair and Maintenance. The cost of reasonable repair and maintenance of a party wall shall be shared by the Owners who make use of the wall in proportion to such use.

Section 3: Destruction by Fire or Other Casualty. If a party wall is destroyed or damaged by fire or other casualty, any Owner who has used the wall may restore it, and if the other Owners thereafter make use of the wall, they shall contribute to the cost of restoration thereof in proportion to such use without prejudice, however, to the right of any such Owner to call for a larger contribution from the others under rule of law regarding liability for negligence or willful acts or omissions.

**Section 4: Weather Proofing.** Notwithstanding any other provision of this Article, an Owner who by his negligence or willful act causes the party wall to be exposed to the elements shall bear the whole cost of furnishing the necessary protection against such elements.

**Section 5: Right to Contribution Runs with the Land.** The right of any Owner to contributions from any other Owner under this Article shall be appurtenant to the land and shall pass to such Owner's successors in title.

**Section 6: Arbitration.** In the event of any dispute arising concerning a party wall, or under the provisions of this Article, then, upon written request by one of such Owners, addressed to the Declarant, the matter shall be submitted to the Declarant who shall decide the dispute, and the decision of the Declarant shall be final and conclusive on the parties.

## ARTICLE IX

### INSURANCE

**Section 1: Fire Insurance - Dwelling Unit Improvements on Lots.** Each Owner shall purchase at his expense and maintain fire and hazard insurance coverage with respect to the Dwelling Unit on his Lot. Any such insurance shall be for the highest insurable value of such Dwelling Unit and shall contain a replacement cost endorsement. Such insurance shall contain a loss payable endorsement in favor of the Trustee hereinafter described. Upon the request of Declarant, each Owner shall furnish to Declarant, immediately, evidence of such insurability.

**Section 2: Trustee.** All available insurance proceeds, payable under insurance policies described in Section 1 hereof, and subject to the rights of the mortgagees under Section 3 hereof, shall be paid to the Trustee, to be held and expended for the benefit of the Owners, mortgagees, and others as their respective interest shall appear. Said trustee shall be a commercial bank, savings and loan association, title company or other entity in Kerr County, Texas, designated by Declarant which, at the request of Declarant, has agreed in writing to accept such trust. In the event repair or reconstruction is authorized, the Declarant shall have the duty to contract for such work as provided for herein.

**Section 3: Mortgagee's Rights.** With respect to insurance coverage under Section 1 of this Article, any mortgagee of record shall have the option to apply insurance proceeds payable to it in reduction of the obligations secured by its mortgage. For purposes hereof a "mortgagee" shall mean a person or entity to whom a mortgage is made or who is the beneficiary of a deed of trust. For purposes hereof, "available insurance proceeds" shall mean the net insurance proceeds to be paid to the Owner or the Trustee after the mortgagee has made his election hereunder.

**Section 4: Owner's Additional Insurance.** An Owner may carry such additional personal liability and property damage insurance respecting his individual Dwelling Unit as he may desire.

**Section 5: Damage and Destruction; Reconstruction.** If any Dwelling Unit is damaged by fire or other casualty

the Owner of such Dwelling Unit shall immediately take all actions consistent herewith to rebuild such Dwelling Unit (with available insurance proceeds, if available, or at his own cost) pursuant to the original plans and specifications for such Dwelling Unit. If said damage is limited to a single Lot or Dwelling Unit, all available insurance proceeds shall be paid by the Trustee to the Owner of such Lot or Dwelling Unit and the Owner shall use the same to rebuild or repair such Dwelling Unit in accordance with the original plans and specifications therefor. If such damage extends to two or more Lots or Dwelling Units, then:

(a) Reconstruction or Repair by Declarant.

If the available insurance proceeds initially offered or paid by the insurer do not exceed the sum of Ten Thousand and no/100 Dollars (\$10,000.00) and the cost of repairing or rebuilding does not exceed the amount of available insurance proceeds by more than One Thousand and no/100 Dollars (\$1,000.00), such insurance proceeds shall be paid to the Trustee hereinbefore designated in Section 2 hereof. The Declarant shall thereupon contract to repair or rebuild the damaged portions of the Dwelling Units in accordance with the original plans and specifications therefor and the funds held in the insurance trust fund shall be used for this purpose. If the available insurance proceeds are insufficient to pay all the cost of repairing or rebuilding, the Declarant in order to make up any deficiency shall levy a special assessment on all Owners of the Dwelling Units so damaged and their Dwelling Units on a pro rata basis determined in accordance with the amount of damage done to each of the Dwelling Units (which determination shall be made by Declarant in its sole discretion);

(b) Other Situations. If subparagraph (a) is inapplicable, then:

(1) Payment to Trustees. All available insurance proceeds shall be paid to the Trustee designated by the Declarant to be held for the benefit of the Owners of the damaged Dwelling Units as their respective interests may appear. The Declarant is authorized to enter on behalf of such Owners into a construction agreement, consistent with these restrictions, with such Trustee and a contractor relating to the rebuilding of such damaged Dwelling Units, all in accordance with the following procedure;

(2) Procedure. The Declarant shall obtain firm bids (including the right but not the obligation to obtain payment and performance bonds) from three (3) or more responsible contractors to rebuild the damaged Dwelling Units in accordance with their original plans and specifications and shall, as soon as possible thereafter, call a special meeting of the Owners of such damaged Dwelling Units to consider such bids. Each such bid shall be itemized so that the total cost in rebuilding the damaged Dwelling Unit of each Owner will be set forth separately. At the meeting, the Owners shall accept the lowest bid as to

rebuilding all of the damaged Dwelling Units unless by 100% vote, such Owners elect to accept a higher bid for such work. Upon acceptance of such bid, if the available insurance proceeds are insufficient to pay all the cost of repairing or rebuilding, the Declarant in order to make up any deficiency shall levy a special assessment on all Owners of the Dwelling Units so damaged and their Dwelling Units on a pro rata basis determined in accordance with the amount of damage done to each of the Dwelling Units (which determination shall be made by Declarant in its sole discretion).

If any Owner shall fail to pay any special assessment made pursuant to subparagraphs 1 or 2 of this Section 5(b) within thirty (30) days after the levy thereof, the Declarant may make up the deficiency by payment thereof, but said deficiency shall be replenished from the Owner of the damaged Dwelling Unit whether the said improvement is or is not so reconstructed. Any such deficiency shall be deemed a Maintenance Cost with respect to the Lot involved secured by the Maintenance Lien described in Article V hereof. Upon payment by such Owners or by the Declarant for the benefit of such Owners (as provided herein), the Declarant shall let the contract to the successful bidder.

#### ARTICLE X

##### TERMS; AMENDMENTS; TERMINATIONS

Section 1: Term; Method of Termination. This Declaration shall be effective upon the date of recordation hereof and, as amended from time to time, shall continue in full force and effect to and including December 31, 2004. From and after said date, this Declaration, as amended, shall be automatically extended for successive periods of ten (10) years, unless there is an affirmative vote to terminate this Declaration by the then Owners of seventy-five percent (75%) of the Lots. Furthermore, this Declaration may be terminated at any time if (i) Owners of legal title of seventy-five percent (75%) of the Lots by affirmative vote elect to so terminate this Declaration and (ii) Declarant approves such termination in writing.

Section 2: Amendments. This Declaration may be amended or changed in whole or in part at any time by (i) the affirmative vote of the Owners of legal title of fifty-one percent (51%) of the Lots and (ii) the written approval of Declarant.

Section 3: Election Procedure for Amendments and Termination. The affirmative votes required under Section 1 or Section 2 of this Article may be obtained and evidenced either by a written consent to any such amendment or termination, as the case may be, signed by the requisite percentage of Owners (which such consent shall be in recordable form and presented to Declarant) or by the requisite vote by the Owners at a meeting of Owners duly called by at least ten (10) Owners or by Declarant pursuant to notice in writing mailed to all of the Owners at their last known addresses on or prior to ten (10) days before the date of the meeting at which meeting the requisite percentage of Owners, in person or by proxy, vote to so amend or terminate this Declaration (and the Covenants herein). The notice of the meeting must set forth the

proposal as to amendment or termination of this Declaration (and/or the Covenants therein) and the affirmative vote of the requisite percentage of Owners must be evidenced by minutes of the meeting duly certified by the Owners who called the meeting or Declarant. 1. any event, a copy of the minutes must be delivered to Declarant.

Section 4: Recording of Amendments or Termination.

Upon the requisite percentage of Owners duly voting to amend or terminate this Declaration (and/or the Covenants herein) and upon the other conditions set forth in Section 1 or Section 2 (of this Article, as the case may be) and Section 3 of this Article being satisfied, then:

(a) In the case of amendment, each amendment shall be executed by the Declarant, placed in recordable form, and filed of record in the Recorder of Deeds Office, Kerr County, Texas accompanied by a statement that the requisite percentage of Owners had voted to make such amendment to this Declaration.

(b) With respect to terminations, a duly authorized agent of Declarant shall cause to be recorded with the Recorder of Deeds, Kerr County, Texas, a certificate of termination duly signed by such agent with his signature acknowledged.

Section 5: Effect. Upon the recording of the Certificate of termination as required by subparagraph (b) in Section 4 of this Article, these Covenants and this Declaration shall have no further force and effect. Upon the filing of a Certificate of Amendment in accordance with subparagraph (a) of Section 4 of this Article, this Declaration and the Covenants, as amended, shall remain in full force and effect, enforceable in accordance with its terms.

Section 6: Right of Amendment if Requested by Governmental Agency or Federally Chartered Lending Institutions. Anything in this Article to the contrary notwithstanding, Declarant reserves the right to amend all or any part of this Declaration to such an extent and with such language as may be requested by any federal, state or local agency which requests such an amendment as a condition precedent to such agency's approval of this Declaration, or by any federally chartered lending institution as a condition precedent to lending funds upon the security of the Property or any portion thereof. Any such amendment shall be effected by the recordation, by Declarant, of a Certificate of Amendment signed by a duly authorized agent of Declarant, with his signature acknowledged, specifying the Federal, state or local governmental agency or the federally chartered lending institution requesting the amendment and setting forth the amendatory language requested by such agency or institution. Recordation of such a Certificate shall be deemed conclusive proof of the agency's or institution's request for such an amendment, and such Certificate, when recorded, shall be binding upon the Property and all persons having an interest in the Property. Except as provided in this Section 6 Declarant shall not have any right to amend this Declaration otherwise than in accordance with and pursuant to the provisions of Section 2 of this Article.

## RESERVATION OF RIGHT TO RESUBDIVIDE AND REPLAT LOTS

Subject to the approval of any and all appropriate governmental agencies having jurisdiction, Declarant hereby reserves the right at any time while it is the Owner thereof to resubdivide and replat any Lot or Lots without the consent of any of the other Owners.

## ARTICLE XII

## SUBJECTING ADDITIONAL LANDS TO THE DECLARATION

From time to time the size of the Property may be increased by Declarant's recording with the Recorder of Deeds, Kerr County, Texas, a supplement to this Declaration (hereinafter called "Supplemental Declaration"). The Supplemental Declaration shall be signed and acknowledged by or on behalf of the Declarant who shall be the owner of record of the additional land to be included within the Property and subjected to the Covenants set forth in this Declaration. Each such Supplemental Declaration shall:

- (a) describe the additional land to be included as a part of the Property;
- (b) state the number of new lots in such additional land which will be deemed "Lots" hereunder;
- (c) state that such land and any permanent improvements thereon are expressly subjected to all of the Covenants set forth in this Declaration; and
- (d) state that each Owner of a Lot therein, for and on behalf of his heirs, executors, administrators, trustees, personal representatives, successors and assigns, agrees to be personally liable for all Maintenance Cost imposed hereunder and shall be personally bound by all Covenants set forth in this Declaration.

## ARTICLE XIII

## MISCELLANEOUS

Section 1: Interpretation of the Covenants. Except for judicial construction, the Declarant shall have the exclusive right to construe and interpret the provisions of this Declaration. In the absence of any adjudication to the contrary by a court of competent jurisdiction, the Declarant's construction or interpretation of the provisions hereof shall be final, conclusive and binding as to all persons and property benefited or bound by the Covenants and provisions hereof.

Section 2: Severability. Any determination by any court of competent jurisdiction that any provision of this Declaration is invalid or unenforceable shall not affect the validity or enforceability of any of the other provisions hereof.

Section 3: Rule Against Perpetuities. If any interest purported to be created by this Declaration is challenged under the Rule against Perpetuities or any related rule, the interest shall be construed as becoming void and of no

effect as of the end of the applicable period of perpetuities computed from the date when the period of perpetuities starts to run on the challenged interest; the "lives in being" for computing the period of perpetuities shall be those which would be used in determining the validity of the challenged interest.

Section 4: Successors and Assigns of Declarant. Any reference in this Declaration to Declarant shall include any successors or assignees of Declarant's rights and powers hereunder.

Section 5: Gender and Number. Wherever the context of this Declaration so requires, words used in the masculine gender shall include the feminine and neuter genders; words used in the neuter gender shall include the masculine and feminine genders; words in the singular shall include the plural; and words in the plural shall include the singular.

Section 6: Captions and Titles. All captions, titles or headings of the Articles and Sections in this Declaration are for the purpose of reference and convenience only, and are not to be deemed to limit, modify or otherwise affect any of the provisions hereof, or to be used in determining the intent or context thereof.

Section 7: Notices. Any notice permitted or required to be delivered as provided herein may be delivered either personally or by mail. If delivery is made by mail, it shall be deemed to have been delivered twenty-four (24) hours after a copy of same has been deposited in the United States mail, postage prepaid, addressed to each such person at the address given by such person to the Declarant for the purpose of service of such notice or to the address of the Dwelling Unit of such person if no address has been given. Such address may be changed from time to time by notice in writing to the Declarant.

Section 8: Easements. Each Lot shall be subject to an easement for overhangs and minor encroachments by walls, structures and fences upon adjacent Lots as constructed by the original builder or as reconstructed or repaired in accordance with the original plans and specifications.

Section 9: Prior Recorded Instruments. This instrument and the provisions hereof are expressly subject to all prior recorded documents affecting the Property, including without limitation that certain Reservation of Architectural Control, recorded by Riverhill Club & Estates, Ltd., a Texas limited partnership, on the 27<sup>th</sup> day of May, 1974, in the office of the Recorder of Deeds, Kerr County, Texas, ~~Volume \_\_\_\_\_, commencing at page \_\_\_\_\_.~~ under Clerk's File # 751883.

IN WITNESS WHEREOF, Riverhill Club & Estates, Ltd., a Texas limited partnership, has hereunto caused its name to be signed and the same to be attested by the signatures of its duly authorized officials as of the day and year first above written.

RIVERHILL CLUB & ESTATES, LTD.

By: Tierra Linda Ranch Corporation,  
General Partner

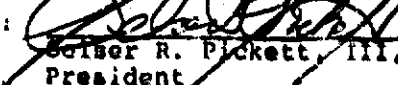
By:   
Robert R. Pickett, III,  
President



STATE OF TEXAS       §  
                             §  
COUNTY OF Kerr     §

VOL. 179 PAGE 337

BEFORE ME, the undersigned authority, on this day personally appeared SELSER R. PICKETT, III, President of Tierra Linda Ranch Corporation, General Partner of Riverhill Club & Estates, Ltd., a Texas limited partnership, known to me to be the person and officer whose name is subscribed to the foregoing instrument, and acknowledged to me that he executed the same for the purposes and consideration therein expressed, in the capacity therein stated and as the act and deed of said limited partnership.

GIVEN UNDER MY HAND AND SEAL OF OFFICE this the 27th day of MAY, 1975.

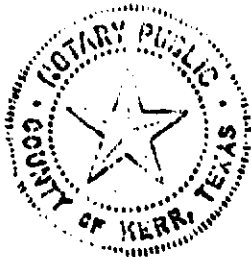

  
NOTARY PUBLIC IN AND FOR  
KERR COUNTY, TEXAS

FILED FOR RECORD

at 2:00 o'clock P.M.

MAY 27 1975

EMMIE M. MUENKER  
Clerk County Court, Kerr County, Texas  
By Donna Witt Deputy

## EXHIBIT A

## TRACT 1

VOL. 177 PAGE 838

All that certain tract or parcel of land lying and being situated in the County of Kerr, State of Texas, comprising 19.17 acres being 19.14 acres out of Original Survey no. 147, Nathaniel Holt, Abstract No. 178, and 0.03 acre out of Original Survey No. 146, Wm. C. Francis, Abstract No. 137, this tract being Riverhill Townhouse Tracts No. One, and subject tract being more particularly described by metes and bounds, as follows, to wit:

BEGINNING at a fence corner post the South corner of that 28 acres which was conveyed from Wm. Bryant Saner to L. D. Brinkman by deed dated October 27, 1971, and recorded in Volume 152 at Page 481 of the Deed Records of Kerr County, Texas, and whose Texas Coordinates System South Central Zone are N or Y = 795,458.873, E or X = 1,955,859.093;

THENCE with fence along the NW line of Original Survey No. 147, Nathaniel Holt, S.44°59'W. 988.73 feet to an iron stake in the East line of newly widened right of way of Texas Highway No. 16;

THENCE with the East right of way of said Texas Highway No. 16, S.10°50'E. 200.0 feet to a point in said right of way;

THENCE S. 45°11'12"E. 146.5 feet to an iron stake NW of No. 16 Green of Riverhill Golf Course;

THENCE around No. 16 Green, N.70°17'E. 131.6 feet, and S.55°56'E. 105.3 feet to an iron stake the NW line of No. 17 Fairway;

THENCE along the NW line of 17 Fairway, N.32°11'E. 514.4 feet, N.39°36'E. 212.5 feet, N.14°06'W. 201.3 feet, N.31°36'E. 66.8 feet, N.50°46'E. 118.7 feet and N.29°01'E. 55.2 feet to an iron stake a SW corner of Block One of Riverhill Townhouse Tracts No. One.

THENCE with the South side of said Block One, N.77°11'E. 25.3 feet, S.75°02'E. 60.9 feet, S.69°10'E. 99.5 feet, S.38°12'E. 77.0 feet, S.5°58'W. 23.6 feet, S.54°30'E. 315.81 feet, S.80°18'E. 121.1 feet, S. 58°53'E. 204.1 feet and S.75°10'E. 318.2 feet to an iron stake the most Southerly SE corner of Block One;

THENCE WITH THE NE line of said Block One, N.14°11'E. 98.0 feet, N. 12°37'W. 192.3 feet, N.26°44'W. 240.2 feet, N.32°07'W. 209.6 feet, N.88°53'W. 334.4 feet, N.81°20'W. 372.2 feet and N.84°06'W. 124.2 feet to an iron stake SW of No. 18 Tee;

THENCE with the NE line of Fairway Drive along the arc of a circular curve to the right in a NW direction having a radius of 145.0 feet for a distance of 20 feet to a point;

THENCE crossing street, S.78°16'25"W. 40 feet to the SW line of said Fairway Drive;

THENCE with the SW line of said Fairway Drive along the arc of a circular curve to the left in a SE direction having a radius of 185 feet for a distance of 55 feet to a point;

THENCE with the arc of a circular curve to the right in a SW direction having a radius of 20 feet for a distance of 30 feet to the NW line of Sand Bend Drive;

THENCE with the NW line of said Sand Bend Drive, S.51°09'57"W.  
170 feet to the point of curvature of a circular curve to the left;  
THENCE with the arc of said circular curve in a SW direction  
having a radius of 306.22 feet for a distance of 15 feet to  
a point;

THENCE N. 45°22'W. 5 feet to the place of beginning.

TRACT 2

Lots 1, 2, 3, 4, 5, 6 & 7 of Block R and all of the  
land constituting same as shown on a plat of Riverhill  
Estates No. Two, a subdivision of Kerr County, Texas as  
recorded in Volume 4 at Page 30 of the Plat Records, Kerr  
County, Texas.

EXHIBIT A - PAGE 2

Filed for record May 27, 1975 at 2:00 o'clock P.M.

Recorded May 29, 1975  
EMMIE M. MUENKER, Clerk

By Theresa A. Brown Deputy

CORRECTED DECLARATION OF COVENANTS, CONDITIONS AND  
RESTRICTIONS, RE: RIVERHILL CLUB AND ESTATES, LTD.

STATE OF TEXAS )

COUNTY OF KERR )

752319

Before me, the undersigned authority, a Notary Public in and for Kerr County, Texas, on this day personally appeared Pat Tinley, known to me to be a credible person of lawful age and qualified in all respects to make this Affidavit, who being by me here and now duly sworn, upon oath said:

That on the 27th day of May, 1975, he caused a Declaration of Covenants, Conditions and Restrictions to be recorded in the office of the County Clerk of Kerr County, Texas, said Declaration of Covenants, Conditions and Restrictions having been made and executed on the 27th day of May, 1975, by Riverhill Club & Estates Ltd., the same having been filed under clerk's file number 751884 and recorded in Volume 179, Page 822, Deed Records of Kerr County, Texas; and

Prior to the recording of such Declaration of Covenant, Conditions and Restrictions, he filled in three blanks in Section 9 of Article XIII of such Declaration of Covenants, Conditions and Restrictions, such Section 9 appearing at Volume 179, Page 836, Deed Records of Kerr County, Texas, thereby causing that portion of Section 9 containing the blanks to read "on the 27th day of May, 1974";

That he incorrectly inserted the year 1974 in one of such blanks instead of the year 1975, and that portion of subsection 9 containing such blanks should have been filled in to read "on the 27th day of May, 1975", and this Affidavit is made for the purpose of ratifying and confirming the fact that the year stated should have been the year 1975.

Further Affiant saith not

Filed 22 Dry of June A.D. 1975  
EMMIE M. MIFFENKER 10 PM.  
Clerk County Court, Kerr County, Texas  
By Emmie M. Miffenker Deputy

  
Pat Tinley

30th day of June, 1975, to certify which witness my hand and seal of office.

Travis J. Short  
Notary Public, Kerr County, Texas  
MAVINE T. SHORT  
NOTARY PUBLIC  
KERR COUNTY, TEXAS



STATE OF TEXAS )

COUNTY OF KERR )

Before me, the undersigned authority, on this day personally appeared Pat Tinley, known to me to be the person whose name is subscribed to the foregoing instrument, and acknowledged to me that he executed the same for the purposes and consideration therein expressed.

Given under my hand and seal of office on this the 20<sup>th</sup> day of June, A.D. 1975.

*Maxine J. Short*  
Notary Public in and for  
Kerr County, Texas

MAXINE J. SHORT  
NOTARY PUBLIC  
KERR COUNTY, TEXAS



-2-

Filed for record June 23, 1975 at 1:10 o'clock P. M.

Recorded June 26, 1975

EDDIE M. MUENKER, Clerk

By *William A. Brown* Deputy

RESERVATION OF RIGHT TO RESUBDIVIDE AND REPLAT  
AND WAIVER

824278

WHEREAS, Riverhill Club & Estates, Ltd., a Texas limited partnership, hereinafter called "Developer", is the record owner of all of the land shown and described on those certain plats designated as Riverhill Townhouse Tracts No. Eight, according to the map or plat filed for record in Volume 4, Page 279, of the Plat Records of Kerr County, Texas, (the "Property") to which reference is hereby made for all purposes;

WHEREAS, Developer has submitted the Property to certain restrictions, covenants and conditions pursuant to a certain Supplemental Declaration of Covenants, Conditions and Restrictions duly recorded in the Deed Records of Kerr County, Texas (the "Declaration"), and

WHEREAS, the Declaration provides, among other things, the reservation of the right of Developer to resubdivide and replat.

NOW, THEREFORE, in furtherance of, and in addition to, the Declaration, (but not in any way in lieu of or in limitation of the Declaration), the Developer does hereby declare that the Property shall hereafter be held, sold, occupied and conveyed subject to the following:

1. Resubdivision. No Lot, as that term is defined in the Declaration, may be re-subdivided or replatted without the prior written consent of Developer; each Owner (as defined in the Declaration) hereby delegating to Developer the right and authority to approve or disapprove the same and each Owner hereby expressly waiving any right to approve the same and any notice of the same.
2. Reservation of Right to Resubdivide and Replat. Subject to the approval of any and all appropriate governmental agencies having jurisdiction, Developer hereby reserves the right at any time while it is the owner thereof to resubdivide and replat any Lot without the consent of any other Owner and each such Owner expressly waives any notice of, and any right to consent to, any such resubdivision or replat and expressly agrees that Developer may resubdivide and replat as herein set forth without any notice to, or consent of, any such Owner. Further, each Owner expressly waives any rights such Owner may have to notice of, consent to, or approval of any such resubdivision or replat under any applicable laws, ordinances, rules or regulations including without limitation, the provisions of Article 974a, Texas Revised Civil Statutes.
3. Covenants Running With The Land. These restrictions and covenants are hereby declared to be covenants running with the land and shall be fully binding upon all persons acquiring any portion of the Property, or any additional property, whether by descent, devise, purchase, assignment, contract or otherwise, and any person by the acceptance of title to any Lot, or entering into a contract for the purchase of same shall thereby agree and covenant to abide by, and fully perform, all of the restrictions, covenants and conditions herein set forth.
4. Severability of all Terms and Provisions. If any term or provision of this instrument, or the application thereof shall be held invalid, all other terms and provisions of this instrument, or the application thereof shall not be affected thereby, nor shall any failure of the Developer to seek enforcement of any term or provision constitute a waiver of any right to do so in the future or the validity or enforceability of such term or provision.

VOL 264 PAGE 463

5. Headings. The headings contained herein are for reference purposes only and shall not in any way affect the meaning or interpretation hereof.

EXECUTED this the 9th day of August, 1982.

RIVERHILL CLUB & ESTATES, LTD.  
By: Silco, Inc., General Partner

By: Herbert G. Bench  
Herbert G. Bench, Vice-President

THE STATE OF TEXAS §

THE COUNTY OF KERR §

BEFORE ME, the undersigned authority, in and for said County and State, on this day personally appeared HERBERT G. BENCH, known to me to be the person and officer whose name is subscribed to the foregoing instrument and acknowledged to me that the same was the act of RIVERHILL CLUB & ESTATES, LTD., by its General Partner, SILCO, INC., a Nevada corporation, authorized to do business in Texas, and that he executed the same as the act of such partnership for the purposes and consideration therein expressed, and in the capacity therein stated.

GIVEN UNDER MY HAND AND SEAL OF OFFICE this the 9th day of August, 1982.

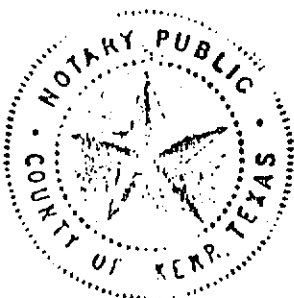

John C. McWhorter  
Notary Public, County of Kerr  
State of Texas  
My commission expires: 16 Apr. '84  
John C. McWhorter Jr  
(Notary Print or Type Name)

# 824278

Riverhill Townhouse  
Tracts # 8

to

The Public

Revestition of right to reside in  
& Replat & Waiver

FILED FOR RECORD

at 4:30 o'clock P.M.

AUG 10 1982

EMMIE M. MUENKER

Clerk County Court, Kerr County, Texas

By Wanda Dea Deputy

Return to:  
Wallace, Jackson & Ables  
attorneys at law

Filed for record August

Recorded August 12, 1982

EMMIE M. MUENKER, Clerk

10, 1982 at 4:30 o'clock P.M.

By Simona Garza Deputy



COVENANTS, CONDITIONS AND RESTRICTIONS

**824277**

THIS SUPPLEMENTAL DECLARATION OF COVENANTS, CONDITIONS AND RESTRICTIONS (this "Supplemental Declaration") made this 9th day of August, 1982, by RIVERHILL CLUB & ESTATES, LTD., a Texas limited partnership ("Declarant");

W I T N E S S E T H:

A. Declarant has heretofore executed and acknowledged that certain Declaration of Covenants, Conditions and Restrictions (the "Declaration"), dated May 27, 1975, covering certain real estate and premises situated in Kerr County, Texas, which is more particularly referred to and described therein, and has caused the Declaration to be filed in the office of the County Clerk of Kerr County, Texas, in Volume 179, Page 822, et seq., of the Deed Records of Kerr County, Texas.

B. Declarant is the owner of certain additional real property (the "Additional Property") being more particularly described as Riverhill Townhouse Tracts No. Eight, a subdivision in Kerr County, Texas, according to the Plat thereof recorded in Volume 4, Page 279 of the Plat Records of Kerr County, Texas, and desires to subject the same to the terms and provisions of the Declaration.

C. Article XII of the Declaration provides that additional property may be included as a part of the Property (as defined in the Declaration) and may be made subject to the Declaration by Declarant's filing of record a Supplemental Declaration of Covenants, Conditions and Restrictions providing for the extension of the covenants, conditions and restrictions of the Declaration to such additional property.

D. Declarant desires to subject the Additional Property to the Declaration, to reaffirm the terms, covenants, conditions, provisions and restrictions of the Declaration, as supplemented, and to subject the Additional Property to further restrictions.

NOW, THEREFORE, the Declarant (i) reaffirms the Declaration and the recitals and declaration contained in the Declaration, (ii) declares that the Additional Property and any permanent improvements thereon are expressly subjected to, and shall be held, transferred, sold, conveyed and occupied subject to, the covenants, conditions, restrictions, easements, charges and liens set forth herein and in the Declaration, as reaffirmed in and as supplemented and added to by this Supplemental Declaration, (iii) supplements and adds to the Declaration as herein provided, and (iv) declares that the Additional Property shall be included as a part of the Property, as defined and specified in the Declaration.

Pursuant to Article XII of the Declaration each of the numbered lots described in the respective plats of the Additional Property shall be designated and deemed to be "Lots" under the Declaration.

Each owner (as defined in the Declaration) of a Lot within the Additional Property for and on behalf of his heirs, executors, administrators, trustees, personal representatives, successors and assigns, agrees to be personally liable for all Maintenance Cost (as defined in the Declaration) imposed under the Declaration and shall be personally bound by all covenants set forth in the Declaration.

In addition to, and not in lieu of or in limitation of, the Declaration, Declarant declares that the Additional Property is and shall be held, transferred, sold, conveyed and occupied subject to the covenants, conditions, restrictions and easements hereinafter set forth.

1. Building Restrictions. The following restrictions shall apply to each respective portion of the Additional Property, as specified:

(a) BLOCK 1 - GOLF COURSE LOTS

- (i) All units and structures shall be built no closer to the golf course and the street than the building set-back line set forth on the plat of the Additional Property. No common or party walls shall be permitted in this block.
- (ii) All units and structures may be built on the Lot line (herein called "zero Lot line") on the left when facing the Lot from Oakland Hills Lane. When using such a zero Lot line, a minimum of 10 feet must remain between the unit and structure and the Lot line on the other side of such Lot (herein called "non-zero Lot line"). The wall on the zero Lot line must be 100% masonry which masonry portion shall not exceed 8 feet above the ground with no windows; provided, that the non-masonry portion of said wall may be any height above said 8 feet and that fixed glass (for light in vaulted rooms) may be placed above said 8 feet. Units and structures adjacent to a non-zero Lot line may erect a masonry wall not to exceed 6 feet in height on the side property line provided it extends no closer to the golf course than the structure.
- (iii) All units and structures may be constructed without using a zero Lot line provided there is a minimum of 5 feet between the left side property line (facing from street) and 10 feet from the right side property line (facing from street).
- (iv) All units and structures on all Lots shall be one story with a maximum ridge height of 17 feet.
- (v) A minimum of 51% masonry is required for all units and structures on all Lots.
- (vi) Each unit and structure shall contain a minimum of 2250 square feet of heated and cooled space. Lot 2 is exempt from this requirement but is otherwise subject to the Declaration and this Supplemental Declaration, including without limitation, the Architectural Control provisions thereof which may include and expressly is provided hereby to include the size of the unit and structure thereon.
- (vii) A decorative masonry or wrought iron fence not to exceed 42 inches in height may be placed from the golf course building line to the property line of the golf course, but no other fence shall be permitted.

- (viii) Roofs shall be cedar shingle, tile, or metal. Metal roofs must be painted, baked on finish, or acidized.

(b) BLOCK 2 - BOUNDED BY ROLLING GREEN, PRESTON TRAIL, OAKLAND HILLS LANE

- (i) All garages must enter from the private access drive. No parking will be allowed at any time on private access drive.
- (ii) All units and structures must be no closer to the street and private drive than the building set-back line shown on the plat of the Additional Property. A minimum of 5 feet must be maintained from side property lines.
- (iii) Units and structures shall be one or two story with a minimum of 2000 square feet of heated and cooled space and shall have a minimum of 51% masonry on the ground floor.
- (iv) Roofs shall be cedar shingle, tile, metal or composition (300 lb/sq or more). Metal roofs must be painted, baked on finish, or acidized.
- (v) A decorative fence, masonry or wrought iron, not to exceed 42 inches in height, may be placed from the street building line to the property line on that side of a Lot, but no other fence shall be permitted.
- (vi) A minimum of 51% masonry is required on the ground floor for all units and structures on all Lots.

(c) BLOCK 3 - FACING HIGHWAY 173

- (i) All units must be no closer to the property line on Highway 173 than the building line shown on the plat of the Additional Property and if no such building set-back line is shown on said plat such building set-back line shall be at least 10 feet and shall be no greater than 40 feet from Highway 173 and shall be as designated and specified by Declarant, its successors and assigns, which designation may vary from Lot to Lot within the limits herein specified. The building set-back line from the street shall be as shown on the plat of the Additional Property and shall be 25 feet from the property line except as shown for Lots 14 through 17; shall be at least five feet from the right side property line (facing from street) and at least 10 feet from the left side property line for Lots 1 through 15; and shall be five feet on each side for Lots 16 through 26.
- (ii) Units and structures shall be one or two story. Each unit and structure shall contain a minimum of 2000 square feet of heated and cooled space.
- (iii) Roofs shall be cedar shingle, tile, metal, or composition (300 lb/sq or more). Metal roofs

must be painted, baked on finish, or acidized.

- (iv) A minimum of 51% masonry is required on the ground floor for all units and structures on all Lots.
  - (v) A decorative fence constructed of cedar, masonry, or wrought iron, not to exceed 48 inches in height, may be placed from the Highway building line to the property line on that side, but no other fence shall be permitted.
2. Dwelling Unit. Each Lot within the Property shall be used exclusively for single family residential purposes, and no more than one residential structure shall be placed on any one Lot.
  3. Utility Easements. The utility easements shown on the plats of the Additional Property shall be easements for installation, maintenance, repair and removal of utilities (including, but not limited to, sewer, water, telephone, power, gas and street lighting) and drainage facilities and floodway easements over, under and across the portions of the Additional Property covered thereby, and are reserved by Declarant for itself, its successors and assigns. Declarant shall have the right to grant easements for such purposes over, under, and across such portions of the Additional Property. Full rights of ingress and egress shall be had by Declarant and its successors and assigns, at all times over the Additional Property for the installation, operation, maintenance, repair or removal of any utility together with the right to remove any obstruction that may be placed in such easement that would constitute interference with the use of such easement, or with the use, maintenance, operation or installation of such utility.
  4. Overhang and Encroachment Easements. Declarant hereby reserves for itself, and each Owner, an easement and right of overhang and encroachment with respect to any unit and structure constructed thereon, for the overhang of the roof of any such originally constructed unit and structure and for the encroachment of any such originally constructed unit and structure upon another adjoining Lot, as a result of the construction, repair, shifting, settlement or movement of any portion of any such originally constructed unit and structure, together with an easement and right of ingress and egress for the maintenance of the portion of such unit and structure so encroaching or overhanging.
  5. Ingress and Egress. Full rights of ingress and egress shall be had, and are hereby reserved, by Declarant, its successors and assigns, at all times over and upon each Lot for the maintenance and repair of each Lot in accordance with the provisions hereof; provided, that any such entry upon any Lot shall be made with as minimum inconvenience to the Owner as practical, and any damage caused thereby shall be repaired at the expense of the party making such entry.
  6. Ingress and Egress Easement. The private drive, golf cart and access easements shown on the plats of the Additional Property may be used by each Owner and

Declarant, and their successors and assigns, for regress, ingress and egress at all times over and upon the portion of the Additional Property covered thereby for access to each Lot and/or streets and the golf course adjacent to the Additional Property, by foot and vehicle; and in addition thereto each Owner, and Declarant, their successors and assigns, shall have the right of ingress and egress over and upon each adjoining Lot for the maintenance and repair of each such Owner's Lot; provided, that any entry upon any such adjoining Lot shall be made with as minimum inconvenience to the Owner of each such adjoining Lot as practical, and any damage caused thereby shall be repaired by each such entering Owner at his expense.

7. Ingress and Egress by Police. The police, fire department, emergency units, ambulance company, utility companies, and any governmental agency or department having jurisdiction, shall have the right of ingress and egress at all times over and upon each Lot, including without limitation streets and sidewalks, for the performance of their respective duties and responsibilities with respect to the Additional Property and in order to service the Additional Property.
8. Duration. The Covenants, Conditions and Restrictions of this Supplemental Declaration shall run with and bind the land subject to this Supplemental Declaration, and shall inure to the benefit of and be enforceable by Declarant and/or the Owners of any land subject to this Supplemental Declaration, their respective legal representatives, heirs, successors and assigns, for the same term as the Declaration.
9. Amendments. The Covenants, Conditions and Restrictions of this Supplemental Declaration may be abolished, amended and/or changed in whole or in part, only with the consent of a majority of the Owners and the Declarant and in each case such amendment shall be evidenced by a document in writing bearing each of their signatures; provided, however, that the Declarant shall have the right to amend this Supplemental Declaration at any time, and from time to time, without the consent of any other Owner, to the extent that such amendments are required by any utility company, financing institution, or any governmental or quasi-governmental authority involved in financing or servicing any improvement, purchase or sale of any of the Lots or the improvements to be constructed thereon. All amendments, if any, shall be recorded in the office of the County Clerk of Kerr County, Texas.
10. Enforcement. Enforcement of these covenants and restrictions shall be by any proceeding at law or in equity against any person or persons violating or attempting to violate them, or to recover damages, or to enforce any lien created by these covenants; and failure by Declarant or any Owner to enforce any covenant or restriction herein contained shall in no event be deemed a waiver of the right to do so thereafter.
11. Severability. Invalidity of any one of these covenants or restrictions by judgment or court order shall in nowise affect any other provision which shall remain in full force and effect.

12. Headings. The headings contained in this Supplemental Declaration are for reference purposes only and shall not in any way affect the meaning or interpretation of this Supplemental Declaration.

IN WITNESS WHEREOF, Declarant has caused this instrument to be executed in its name and on its behalf this 9th day of August, 1982.

## DECLARANT:

RIVERHILL CLUB &amp; ESTATES, LTD.

By: Silco, Inc., General Partner

By: Herbert G. Bench  
Herbert G. Bench, Vice-President

THE STATE OF TEXAS §

THE COUNTY OF KERR §

BEFORE ME, the undersigned authority, in and for said County and State, on this day personally appeared HERBERT G. BENCH, known to me to be the person and officer whose name is subscribed to the foregoing instrument and acknowledged to me that the same was the act of RIVERHILL CLUB & ESTATES, LTD., by its General Partner, SILCO, INC., a Nevada corporation, authorized to do business in Texas, and that he executed the same as the act of such partnership for the purposes and consideration therein expressed, and in the capacity therein stated.

GIVEN UNDER MY HAND AND SEAL OF OFFICE this the 9th day of August, 1982.

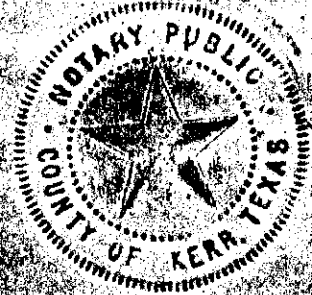

John C. McWhorter, Jr.  
Notary Public, County of Kerr  
State of Texas

My commission expires: 16 Apr. '84

John C. McWhorter, Jr.  
(Notary Print or Type Name)



ABSTRACT AND TITLE CO.

323 Earl Corbett  
Phone 96-4311 P. O. Box 509  
Kerrville, Texas 78028

# 824297

Supplemental Declaration  
of Owners, Condition  
of Restrictions  
Richell Lawrence  
Book # 8

The Public

☐ INDEXED  
☒ COMPARED

FILED FOR RECORD

at 4:30 o'clock P. M.

AUG 10 1982

EMME M. MUENKER

Clerk County Court, Kerr County, Texas  
By Minda Blue Deputy

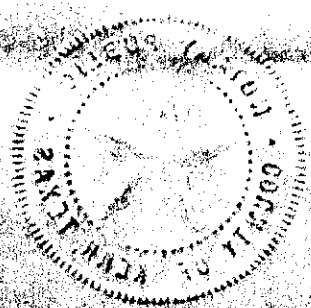

Return to:

Wallace, Jackson & Adams  
attorneys at law

RECORDED  
ABSTRACT CERTIFICATE INDEXED

ASSIGNMENT

This Assignment is entered into by RIVERHILL COUNTRY CLUB, INC., a Texas nonprofit corporation ("Riverhill") to and for the benefit of ASSOCIATION OF PROPERTY OWNERS OF RIVERHILL, a Texas nonprofit corporation ("Association");

## W I T N E S S E T H:

A. The Declarations of Covenants, Conditions and Restrictions (the "Declarations") described in the Articles of Incorporation of the Association (attached hereto and made a part hereof for all purposes) have been recorded and established as therein set forth.

B. Riverhill has agreed to assign its rights under the Declarations to the Association.

NOW, THEREFORE, for and in consideration of the premises, the mutual covenants and benefits herein contained, together with Ten Dollars (\$10.00) and other good and valuable consideration, the receipt and sufficiency of which is hereby acknowledged and confessed, Riverhill does hereby assign, transfer and convey to the Association, all of the rights, benefits, privileges and authorities of Riverhill under the Declarations; so that the Association shall be vested with all such rights, privileges, benefits and authorities of and under the Declarations and shall be the successor to Riverhill as the Declarant and Developer under the Declarations for all purposes.

Riverhill shall be responsible under the Declarations for the discharge and performance of any and all duties and obligations to be performed and/or discharged by the Declarant and Developer thereunder prior to the date hereof, and Riverhill covenants and agrees to promptly discharge all obligations of the Developer and Declarant under the Declarations to be performed and/or discharged thereunder prior to the date hereof and to indemnify, save and hold harmless the Association from and against any and all losses, liabilities, claims, or causes of action existing in favor of or asserted under the Declarations and arising out of, in connection with, or relating to the Declarations prior to the date hereof. Except as set forth in the foregoing the Association shall be responsible under the Declarations for the discharge and performance of all obligations, terms, covenants and conditions of the Declarations on the part of the Declarant and Developer therein required to be performed after the date hereof.

All of the covenants, terms and conditions set forth herein shall be binding upon and shall inure to the benefit of the parties hereto and their respective successors and assigns.



IN WITNESS WHEREOF, the parties hereto have executed this Assignment on this 30th day of January, 1998.

RIVERHILL COUNTRY CLUB, INC.

BY: William G. Kendrick  
Name: William G. Kendrick  
Title: President

ASSOCIATION OF PROPERTY OWNERS OF RIVERHILL

BY: John J. Clemens  
Name: John J. Clemens  
Title: President

THE STATE OF TEXAS §

COUNTY OF KERR §

This instrument was acknowledged before me this 30th day of January, 1998, by William G. Kendrick, President of RIVERHILL COUNTRY CLUB, INC., a Texas nonprofit corporation, on behalf of said corporation.

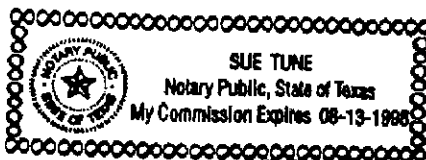

THE STATE OF TEXAS §

COUNTY OF KERR §

This instrument was acknowledged before me this 31st day of January, 1998, by John J. Clemens, President of ASSOCIATION OF PROPERTY OWNERS OF RIVERHILL, a Texas nonprofit corporation, on behalf of said corporation.



Sandra Shay Hale  
Notary Public, State of Texas

ARTICLES OF INCORPORATION  
OF

ASSOCIATION OF PROPERTY OWNERS OF RIVERHILL Corporations Section.

FILED  
in the Office of the  
Secretary of State of Texas

DEC 3 1997

We, the undersigned natural persons of the age of twenty-one (21) years or more, at least two of whom are citizens of the State of Texas, acting as incorporators of a corporation (hereinafter called the "Corporation") under the Texas Non-Profit Corporation Act (hereinafter called the "Act"), do hereby adopt the following Articles of Incorporation for the Corporation.

ARTICLE I.

The name of the Corporation is ASSOCIATION OF PROPERTY OWNERS OF RIVERHILL.

ARTICLE II.

The Corporation is a non-profit corporation.

ARTICLE III.

The period of its duration is perpetual.

ARTICLE IV.

This Corporation does not contemplate pecuniary gain or profit to the members thereof, and the specific purposes for which it is formed are the following which shall be in addition to, and the Corporation is organized for, any other lawful purpose permitted by applicable law:

- a. To exercise all of the powers and privileges and to perform all of the duties and obligations of the Declarant and Developer under and as set forth in the following covenant, restrictions and declarations and the plats of the land encumbered thereby (collectively, "Declarations"), which terms will include those other and additional areas, restrictions, etc., approved by the Board from time to time:

Riverhill Cottages: Volume 179, Page 806, Volume 179, Page 822, and corrected by Volume 180, Page 584, Volume 308, Page 263 and Volume 303, Page 833, Deed Records, Kerr County, Texas, Volume 346, Page 726, Volume 391, Page 672, and Volume 392, Page 190, Real Property Records, Kerr County, Texas.

Riverhill Estates No. One: Volume 130, Page 407 and Volume 148, Page 390, amended by Volume 174, Page 556, Volume 179, Page 759, Deed Records, Kerr County, Texas.

Riverhill Estates No. One (Lot 2A, Block K): Volume 238, Page 611, Deed Records, Kerr County, Texas.

Riverhill Estates No. One (Lots 3A and 3B, Block K): Volume 238, Page 617, Deed Records, Kerr County, Texas.

Riverhill Estates No. One (Lot K1, Block K): Volume 238, Page 614, Deed Records, Kerr County, Texas.

Riverhill Estates No. One (Lot 9, Block L): Volume 243, Page 846, Deed Records, Kerr County, Texas.

Riverhill Estates No. Two, SAVE AND EXCEPT Lots 1-7, Block R: Volume 179, Page 765, Deed Records, Kerr County, Texas.

Riverhill Estates No. Two, Lots 1-7, Block R: Volume 179, Page 806, Volume 179, Page 822, being corrected by Volume 180, Page 584, Deed Records, Kerr County, Texas.

Riverhill Estates No. Three: Volume 179, Page 786, Deed Records, Kerr County, Texas.

Riverhill Las Casitas: Volume 179, Page 806, Volume 179, Page 822, being corrected by Volume 180, Page 584, and supplemented by Volume 204, Page 277, Deed Records, Kerr County, Texas.

Riverhill Los Adobes: Volume 179, Page 806, Volume 179, Page 822, being corrected by Volume 180, Page 584, and supplemented by Volume 236, Page 245, Deed Records, Kerr County, Texas.

Riverhill Townhouse Tracts No. One: Volume 179, Page 806, Volume 179, Page 822, being corrected by Volume 180, Page 584, Deed Records, Kerr County, Texas.

Riverhill Townhouse Tracts No. One, Lots 41-44: Volume 192, Page 271, and Volume 243, Page 841, Deed Records, Kerr County, Texas.

Riverhill Townhouse Tracts No. One, Lots 1-2: Volume 278, Page 6, Deed Records, Kerr County, Texas.

Riverhill Townhouse Tracts No. Two: Volume 179, Page 806, Volume 179, Page 822, being corrected by Volume 180, Page 584, Deed Records, Kerr County, Texas, Volume 189, Page 617, Deed Records, Kerr County, Texas.

Riverhill Townhouse Tracts No. Three: Volume 179, Page 806, Deed records, Kerr County, Texas.

Riverhill Townhouse Tracts No. Four, Section One: Volume 179, Page 806, Volume 179, Page 822, being corrected by Volume 180, Page 584, Deed Records, Kerr County, Texas, and supplemented by Volume 242, Page 362, Volume 242, Page 365, and Volume 242, Page 370, Deed Records, Kerr County, Texas.

Riverhill Townhouse Tracts No. Four, Section Two: Volume 179, Page 806, Volume 179, Page 822, being corrected by Volume 180, Page 584, Deed Records, Kerr County, Texas, and supplemented by Volume 242, Page 362, Volume 242, Page 365, Volume 242, Page 370, and Volume 256, Page 548, Deed Records, Kerr County, Texas.

Riverhill Townhouse Tracts No. Five: Volume 179, Page 806, Volume 179, Page 822, being corrected by Volume 180, Page 584, and supplemented by Volume 200, Page 127, Deed Records, Kerr County, Texas.

Riverhill Townhouse Tracts No. Six: Volume 179, Page 806, Volume 179, Page 822, being corrected by Volume 180, Page 584, and supplemented by Volume 214, Page 751, Deed Records, Kerr County, Texas.

Riverhill Townhouse Tracts No. Six, Section Two: Volume 179, Page 806, Volume 179, Page 822, corrected by Volume 180, Page 584, and supplemented by Volume 226, Page 176, Deed Records, Kerr County, Texas.

Riverhill Townhouse Tracts No. Six, Section Two, (Lots 49-55): Volume 329, Page 583, Real Property Records, Kerr County, Texas.

Riverhill Townhouse Tracts No. Seven: Volume 179, Page 806, Volume 179, Page 822, corrected by Volume 180, Page 584, and supplemented by Volume 252, Page 408, Volume 252, Page 411, and Volume 252, Page 414, Deed Records, Kerr County, Texas.

Riverhill Townhouse Tracts No. Eight: Volume 179, Page 806, Volume 179, Page 822, corrected by Volume 180, Page 584, and supplemented by Volume 264, Page 456, and Volume 274, Page 367, and Volume 264, Page 462, Deed Records, Kerr County, Texas.

The Meadows of Riverhill, Section Two of The Meadows of Riverhill (Lot 21 only), The Meadows of Riverhill Section Three: Volume 179, Page 806, Volume 179, Page 822, corrected by Volume 180, Page 584, supplemented by Volume 259, Page 391, Deed Records, Kerr County, Texas.

The Fairways: Volume 179, Page 806, Deed Records, Kerr County, Texas.

Fairway Plaza Volume 179, Page 806, Deed Records, Kerr County, Texas.

4 Townhouses on Fairway Court: Volume 130, Page 407, Volume 148, Page 390, and Volume 158, Pages 383-398, Deed Records, Kerr County, Texas.

- b. To pay all administrative expenses incident to the conduct of the business of the Corporation, including any licenses, taxes or governmental charges which may be levied or imposed against the Corporation or any property it may own;
- c. Insofar as permitted by law, to do any other thing that, in the opinion of the Board of Directors, will promote the common benefit and enjoyment of the residents of the property covered by the Declarations; provided, that no part of the net earnings of the Corporation shall inure to the benefit of or be distributable to any member, director or officer of the Corporation, or any private individual (except that reasonable compensation may be paid for services rendered to or for the Corporation effecting one or more of its purposes), and no member, director or officer of the Corporation, or any private individual, shall be entitled to share in the distribution of any of the corporate assets on dissolution of the Corporation; and provided, further, that no part of the activities of the Corporation shall be carrying on propaganda, or otherwise attempting, to influence legislation, or participating in, or intervening in (including the publication or distribution of statements), any political campaign on behalf of any candidate for public use.

#### ARTICLE V.

The street address of the initial registered office of the Corporation is 100 Riverhill Club Lane, Kerrville, Texas 78028, and the name of its initial registered agent at such address is BRYAN ROE.

#### ARTICLE VI.

Section 1. The number of Directors constituting the initial Board of Directors of the Corporation is three (3), all of whom are residents of the State of Texas.

Section 2. The names and addresses of persons who are elected to serve as directors until their successors shall have been

elected and qualified are:

<u>NAME</u>	<u>ADDRESS</u>
W. TOM SPURLOCK	512 Rolling Green Drive Kerrville, Texas 78028
RICHARD A. RAIDT	362 Englewood Drive Kerrville, Texas 78028
OLLIE D. BROWN, JR.	510 Preston Trail Drive Kerrville, Texas 78028

Section 3. The number of Directors may be increased or decreased from time to time by amendment to the By-Laws, but no decrease shall have the effect of shortening the term of any incumbent director, and the number of directors shall not be decreased to less than three (3) directors. In absence of a by-law fixing the number of directors, the number shall be three (3).

#### ARTICLE VII.

Upon dissolution of the Corporation, other than incident to a merger or consolidation, the assets both real and personal of the Corporation shall be dedicated to an appropriate public agency to be devoted to purposes as nearly as practicable the same as those to which they were required to be devoted by the Corporation. In the event that such dedication is refused acceptance, such assets shall be granted, conveyed and assigned to any non-profit corporation, association, trust or other organization engaged in activities substantially similar to those of the Corporation and which are qualified as exempt organizations under the Internal Revenue Code of 1954, or the corresponding provisions of any future United States Internal Revenue law.

#### ARTICLE VIII.

The Corporation shall have Members and the qualification, designation and rights of the Members shall be set forth in the Bylaws of the Corporation.

#### ARTICLE IX.



The name and street address of each incorporator is:

<u>Name</u>	<u>Address</u>
W. TOM SPURLOCK	512 Rolling Green Drive Kerrville, Texas 78028

RICHARD A. RAIDT

362 Englewood Drive  
Kerrville, Texas 78028

OLLIE D. BROWN, JR.

510 Preston Trail Drive  
Kerrville, Texas 78028EXECUTED this 1st day of December, 1997.  
W. TOM SPURLOCK  
RICHARD A. RAIDT  
OLLIE D. BROWN, JR.

6\REV\AR2

FILED FOR RECORD

at 12:11 o'clock P.M

FEB 2 1998

BILLIE G. MEEKER

Clerk County Court, Kerr County, Texas  
*Mary Ann McDaniel* Deputy

Filed by + return to:  
Richard A. Raidt  
P.O. Box 33895  
362 Englewood Dr.  
Kerrville Tx 78028

Provisions herein which restrict the sale, rental or use of the described property because of color or race is invalid and unenforceable under Federal Law.  
THE STATE OF TEXAS  
COUNTY OF KERR

I hereby certify that this instrument was FILED in the File Number Sequence on the date and at the time stamped hereon by me and was duly RECORDED in the Official Public Records of Real Property of Kerr County, Texas on

FEB 03 1998

RECORD Real Property  
VOL 925 PG 344  
RECORDING DATE

FEB 03 1998

  
COUNTY CLERK, KERR COUNTY, TEXAS  
COUNTY CLERK, KERR COUNTY, TEXAS

6

## RECORDER'S NOTE

AT TIME OF RECORDATION INSTRUMENT FOUND TO BE INADEQUATE FOR BEST PHOTOGRAPHIC REPRODUCTION DUE TO DEPTH & DARKNESS OF PRINT, COLOR OF PRINT OR INK, BACKGROUND OF PAPER, ILLEGIBILITY, CARBON OR PHOTO COPY, ETC.





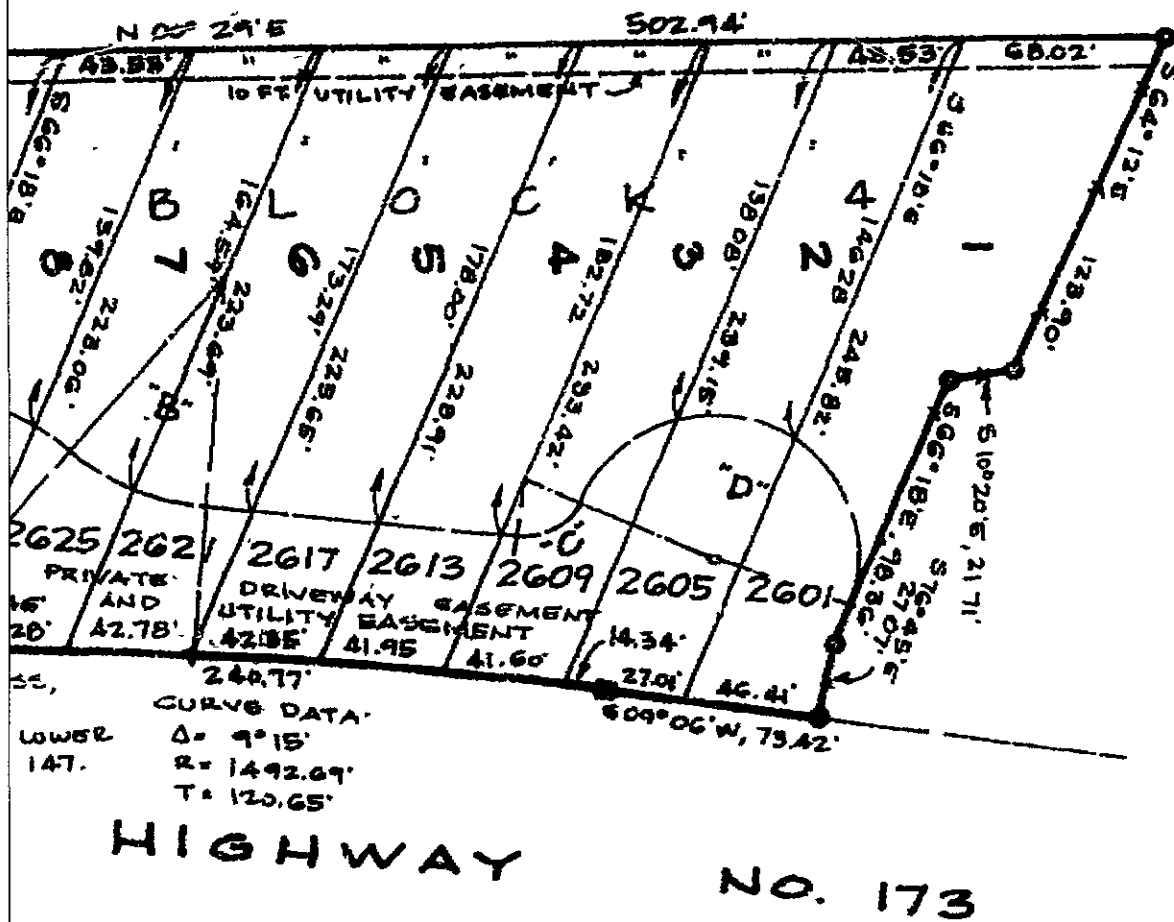

SUPPLEMENTAL DECLARATION OF  
COVENANTS, CONDITIONS AND RESTRICTIONS

832532

VOL. 274 PAGE 367

THIS SUPPLEMENTAL DECLARATION OF COVENANTS, CONDITIONS AND RESTRICTIONS (this "Supplemental Declaration") made this 9th day of AUGUST, 1982, by RIVERHILL CLUB, INC., a Texas limited partnership ("Declarant"), and amended February 27, 1983;

W I T N E S S E T H:

A. Declarant has heretofore executed and acknowledged that certain Declaration of Covenants, Conditions and Restrictions (the "Declaration"), dated May 27, 1975, covering certain real estate and premises situated in Kerr County, Texas, which is more particularly referred to and described therein, and has caused the Declaration to be filed in the office of the County Clerk of Kerr County, Texas, in Volume 179, Page 822, et seq., of the Deed Records of Kerr County, Texas.

B. Declarant is the owner of certain additional real property (the "Additional Property") being more particularly described as Riverhill Townhouse Tracts No. Eight, a subdivision in Kerr County, Texas, according to the Plat thereof recorded in Volume 4, Page 279 of the Plat Records of Kerr County, Texas, and desires to subject the same to the terms and provisions of the Declaration. These restrictions apply to Lots 1-15, Block 1; Lots 1-21, Block 2; Lots 2-26, Block 3, described as Riverhill Townhouse Tract No. Eight, (the "Additional Property").

C. Article XII of the Declaration provides that additional property may be included as a part of the Property (as defined in the Declaration) and may be made subject to the Declaration by Declarant's filing of record a Supplemental Declaration of Covenants, Conditions and Restrictions providing for the extension of the covenants, conditions and restrictions of the Declaration to such additional property.

D. Declarant desires to subject the Additional Property to the Declaration, to reaffirm the terms, covenants, conditions, provisions and restrictions of the Declaration, as supplemented, and to subject the Additional Property to further restrictions.

NOW, THEREFORE, the Declarant (i) reaffirms the Declaration and the recitals and declaration contained in the Declaration, (ii) declares that the Additional Property and any permanent improvements thereon are expressly subjected to, and shall be held, transferred, sold, conveyed and occupied subject to, the covenants, conditions, restrictions, easements, charges and liens set forth herein and in the Declaration, as reaffirmed in and as supplemented and added to by this Supplemental Declaration, (iii) supplements and adds to the Declaration as herein provided, and (iv) declares that the Additional Property shall be included as a part of the Property, as defined and specified in the Declaration.

Pursuant to Article XII of the Declaration each of the numbered lots described in the respective plats of the Additional Property shall be designated and deemed to be "Lots" under the Declaration.

Each owner (as defined in the Declaration) of a Lot within the Additional Property for and on behalf of his heirs, executors, administrators, trustees, personal representatives, successors and assigns, agrees to be personally liable for all Maintenance Cost (as defined in the Declaration) imposed under the Declaration and shall be personally bound by all covenants set forth in the Declaration.

In addition to, and not in lieu of or in limitation of, the Declaration, Declarant declares that the Additional Property is and shall be held, transferred, sold, conveyed and occupied subject to the covenants, conditions, restrictions and easements hereinafter set forth.

1. Building Restrictions. The following restrictions shall apply to each respective portion of the Additional Property, as specified:

(a) BLOCK 1 - GOLF COURSE LOTS 1-15, BLOCK 1

- (i) All units and structures shall be built no closer to the golf course and the street than the building set-back line set forth on the plat of the Additional Property. No common or party walls shall be permitted in this block. Permission may be given to build 1 Townhouse on 1 1/2 or 2 lots by Declarant.
- (ii) All units and structures may be built on the Lot line (herein called "zero Lot line") on the left when facing the Lot from Oakland Hills Lane. When using such a zero Lot line, a minimum of 10 feet must remain between the unit and structure and the Lot line on the other side of such Lot (herein called "non-zero Lot line"). The wall on the zero Lot line must be 100% masonry, which masonry portion must exceed 8 feet above the foundation with no windows; provided, that the non-masonry portion of said wall may be any height above said 8 feet and that fixed glass (for light in vaulted rooms) may be placed above said 8 feet. Units and structures adjacent to a non-zero Lot line may erect a masonry wall not to exceed 5 feet in height on the side property line provided it extends no closer to the golf course than the structure, or closer to the street than that side of the townhouse.
- (iii) All units and structures may be constructed without using a zero Lot line provided there is a minimum of 5 feet between the left side property line (facing from street) and 10 feet from the right side property line (facing from street).
- (iv) A minimum of 51% masonry is required for all units and structures on all Lots.
- (v) Each unit and structure shall contain a minimum of 2250 square feet of heated and cooled space.
- (vi) A decorative masonry and wrought iron fence not to exceed 42 inches in height may be placed from the golf course building line to the property line of the golf course, but no other fence shall be permitted. Note: Details of fence must be shown on original site plan, or be submitted to the Architectural Control Committee.
- (vii) Roofs shall be cedar shingle, tile, or metal. Metal roofs must be painted, baked on finish, or acidized.
- (viii) Height Regulations:
  - If roof ridge line parallels the street, the unit must be one story, with a ridge height of 17' (max) from foundation.
  - If roof ridge line is perpendicular to the street, one and one half (1 1/2) stories are allowed. (Example: Loft room built into attic space with dormer windows).
  - If 10' sideyard on right side and 5' (min) sideyard is on the left side, than a two (2) story townhouse is allowed.

VOL 274 PAGE 369

- (ix) All siding must be solid wood, masonite siding, or equal. No plywood siding is allowed. All siding must be stained or painted. Colors must be earthtones, or natural tones. Any variation in color must be submitted to the Architectural Control Committee.
- (x) The Architectural Control Committee is empowered to waive the stated masonry requirements when clear heart grade redwood, or equal, is proposed as outside wood siding in lieu of masonry in order to follow the existing Riverhill Club House architectural style (this includes standing seam roof). Glass may be included in a masonry wall in figuring the percent of masonry, at the sole discretion of the Architectural Control Committee.
- (b) BLOCK 2 - BOUNDED BY ROLLING GREEN, PRESTON TRAIL, OAKLAND HILLS LANE, LOTS 1-21.
  - (i) All garages must enter from the private access drive, except corner lots. No parking will be allowed at any time on private access drive. Off street parking for 2 cars must be provided.
  - (ii) All units and structures must be no closer to the street and private drive than the building set-back line shown on the plat of the Additional Property. A minimum of 5 feet must be maintained from side property lines.
  - (iii) Units and structures shall be one or two story with a minimum of 2000 square feet of heated and cooled space and shall have a minimum of 51% masonry on the ground floor.
  - (iv) Roofs shall be cedar shingle, tile, metal or composition (300 lb/sq or more). Metal roofs must be painted, baked on finish, or acidized.
  - (v) A decorative fence, masonry or wrought iron, not to exceed 42 inches in height, may be placed from the street building line to the property line on that side of a Lot, but no other fence shall be permitted.
  - (vi) All siding must be solid wood, masonite siding, or equal. No plywood siding is allowed. All siding must be stained or painted. Colors must be earthtones, or natural tones. Any variation in color must be submitted to the Architectural Control Committee.
  - (vii) The Architectural Control Committee is empowered to waive the stated masonry requirements when clear heart grade redwood, or equal, is proposed as outside wood siding in lieu of masonry in order to follow the existing Riverhill Club House architectural style (this includes standing seam roof). Glass may be included in a masonry wall in figuring the percent of masonry, at the sole discretion of the Architectural Control Committee.

(c) BLOCK 3 - FACING HIGHWAY 173, LOTS 2-26

- (i) All units must be no closer to the property line on Highway 173 than the building line shown on the plat of the Additional Property and if no such building set-back line is shown on said plat such building set-back line shall be at least 10 feet. The designation may vary from Lot to Lot within the limits herein specified. The building set-back line from the street shall be as shown on the plat of the Additional Property and shall be 25 feet from the property line except as shown for Lots 14 through 17; shall be at least five feet from the property lines on each side.
  - (ii) Units and structures shall be one or two story. Each unit and structure shall contain a minimum of 2000 square feet of heated and cooled space.
  - (iii) Roofs shall be cedar shingle, tile, metal, or composition (300 lb/sq or more). Metal roofs must be painted, baked or finish, or acidized.
  - (iv) A minimum of 51% masonry is required on the ground floor for all units and structures on all Lots.
  - (v) All siding must be solid wood, masonite siding, or equal. No plywood siding is allowed. All siding must be stained or painted. Colors must be earthtones, or natural tones. Any variation in color must be submitted to the Architectural Control Committee.
  - (vi) The Architectural Control Committee is empowered to waive the stated masonry requirements when clear heart grade redwood, or equal, is proposed as outside wood siding in lieu of masonry in order to follow the existing Riverhill Club House architectural style (this includes standing seam roof). Glass may be included in a masonry wall in figuring the percent of masonry, at the sole discretion of the Architectural Control Committee.
2. Dwelling Unit. Each Lot within the Property shall be used exclusively for single family residential purposes, and no more than one residential structure shall be placed on any one Lot.
  3. Utility Easements. The utility easements shown on the plats of the Additional Property shall be easements for installation, maintenance, repair and removal of utilities (including, but not limited to, sewer, water, telephone, power, gas and street lighting) and drainage facilities and floodway easements over, under and across the portions of the Additional Property covered thereby, and are reserved by Declarant for itself, its successors and assigns. Declarant shall have the right to grant easement for such purposes over, under, and across such portions of the Additional Property. Full rights of ingress and egress shall be had by Declarant and its successors and assigns, at all times over the Additional Property for the installation, operation, maintenance, repair or removal of any utility together with the right to remove any obstruction that may be placed in such easement that would constitute interference with the use of such easement, or with the use, maintenance, operation or installation of such utility.

4. Overhang and Encroachment Easements. Declarant hereby reserves for itself, and each Owner, an easement and right of overhang and encroachment with respect to any unit and structure constructed thereon, for the overhang of the roof of any such originally constructed unit and structure and for the encroachment of any such originally constructed unit and structure upon another adjoining Lot, as a result of the construction, repair, shifting, settlement or movement of any portion of any such originally constructed unit and structure, together with an easement and right of ingress and egress for the maintenance of the portion of such unit and structure so encroaching or overhanging. Fireplace projections of 2' will be allowed inside yard.
5. Ingress and Egress. Full rights of ingress and egress shall be had, and are hereby reserved, by Declarant, its successors and assigns, at all times over and upon each Lot for the maintenance and repair of each Lot in accordance with the provisions hereof; provided, that any such entry upon any Lot shall be made with as minimum inconvenience to the Owner as practical, and any damage caused thereby shall be repaired at the expense of the party making such entry.
6. Ingress and Egress Easement. The private drive, golf cart and access easements shown on the plats of the Additional Property may be used by each Owner and Declarant, and their successors and assigns, for regress, ingress and egress at all times over and upon the portion of the Additional Property covered thereby for access to each Lot and/or streets and the golf course adjacent to the Additional Property, by foot and vehicle; and in addition thereto each Owner, and Declarant, their successors and assigns, shall have the right of ingress and egress over and upon each adjoining Lot for the maintenance and repair of each such Owner's Lot; provided, that any entry upon any such adjoining Lot shall be made with as minimum inconvenience to the Owner of each such adjoining Lot as practical, and any damage caused thereby shall be repaired by each such entering Owner at his expense.
7. Ingress and Egress by Police. The police, fire department, emergency units, ambulance company, utility companies, and any governmental agency or department having jurisdiction, shall have the right of ingress and egress at all times over and upon each Lot, including without limitation streets and sidewalks, for the performance of their respective duties and responsibilities with respect to the Additional Property and in order to service the Additional Property.
8. Duration. The Covenants, Conditions and Restrictions of this Supplemental Declaration shall run with and bind the land subject to this Supplemental Declaration, and shall inure to the benefit of and be enforceable by Declarant and/or the Owners of any land subject to this Supplemental Declaration, their respective legal representatives, heirs, successors and assigns, for the same term as the Declaration.
9. Amendments. The Covenants, Conditions and Restrictions of this Supplemental Declaration may be abolished, amended and/or changed in whole or in part, only with the consent of a majority of the Owners and the Declarant and in each case such amendment shall be evidenced by a document in writing bearing each of their signatures; provided, however, that the Declarant shall have the right to amend this Supplemental Declaration at any time, and from time to time, without the consent of any other Owner, to the extent that such amendments are required by any utility company, financing institution, or any governmental or quasi-governmental authority involved in financing or servicing any improvement, purchase or sale of any of the Lots or the improvements to be constructed thereon. All amendments, if any, shall be recorded in the office of the County Clerk of Kerr County, Texas.
10. Enforcement. Enforcement of the covenants and restrictions shall be by any proceeding at law or in equity against any person or persons violating or attempting to violate them, or to recover damages, or to enforce any lien created by these covenants; and failure by Declarant or any Owner to enforce any covenant or restriction herein contained shall in no event be deemed a waiver of the right to do so thereafter.

11. Severability. Invalidation of any one of these covenants or restrictions by judgment or court order shall in nowise affect any other provision which shall remain in full force and effect.
12. Headings. The headings contained in this Supplemental Declaration are for reference purposes only and shall not in any way affect the meaning or interpretation of this Supplemental Declaration.

IN WITNESS WHEREOF, Declarant has caused this instrument to be executed in its name and on its behalf this 9th day of August, 1982 and amended 28th day of February, 1983, so that this instrument shall amend and supersede in its entirety the Supplemental Declaration recorded in Volume 264, Page 456, Deed Records of Kerr County, Texas.

The undersigned Owner's represent a majority of the Lot ownership in the Riverhill Townhouse Tract #8:

## DECLARANT:

RIVERHILL CLUB, INC.

By: George M. Underwood, Jr.

By: George M. Underwood, Jr.  
 George M. Underwood, Jr., President  
 Owner of 23 Lots in Riverhill  
 TH Tract #8.

By: Ron Coryell  
 Ron Coryell  
 Owner of 4 Lots in Riverhill  
 TH Tract #8.

By: Gene Huggins  
 Gene Huggins  
 Owner of 1 Lot in Riverhill  
 TH Tract #8.

## FILED FOR RECORD

on 10th day of March 1983

MAR 30 1983

PATRICIA DYE

Clerk County Court, Kerr County, Texas  
Patricia Dye (Personal Seal)

THE STATE OF TEXAS |

THE COUNTY OF KERR |

BEFORE ME, the undersigned authority, in and for said County and State, on this day personally appeared George M. Underwood, Jr., Ron Coryell and Gene Huggins, known to me to be the person and officer whose name is subscribed to the foregoing instrument and acknowledged to me that the same was the act of RIVERHILL CLUB, INC.

GIVEN UNDER MY HAND AND SEAL OF OFFICE this the 11th day of March, 1983.



Joyce Dudley  
 Notary Public, County of Kerr  
 State of Texas

My commission expires: 11-29-86

Joyce Dudley  
 (Notary Print or Type Name)

SUPPLEMENTAL DECLARATION OF  
COVENANTS, CONDITIONS & RESTRICTIONS

VOL 274 PAGE 373

OF  
RIVERHILL CLUB, INC.

#832532 RC

*Riverhill Tract No. 8*

*20  
The Public*

FILED FOR RECORD

*10:38 A.M.*

MAR 30 1983

PATRICIA DYE

Clerk County Court, Hart County, Texas

By *Melinda Adams*, Deputy

Return to: *Mary @*

✓ WALLACE, JACKSON & ABLES  
A PROFESSIONAL CORPORATION  
ATTORNEYS AT LAW  
829 JEFFERSON STREET  
KENNEDYVILLE, TEXAS 76026

Filed for record March 30, 1983 At 10:38 O'Clock A.M.  
Recorded April 5, 1983  
PATRICIA DYE, Clerk By *Melinda Adams* Deputy