

SITE PLAN



Rendering by Floor Plan Visuals.
All measurements are approximate. While deemed reliable, no information on these floor plans should be relied upon without independent verification.

185 GILMARTIN DRIVE | TIBURON, CA 94920



**MAIN RESIDENCE
MAIN LEVEL**
4,915 SQ FT



Rendering by Floor Plan Visuals.
All measurements are approximate. While deemed reliable, no information on these floor plans should be relied upon without independent verification.

Lydia Sarkissian
Tel: 415.517.7720
Email: l.sarkissian@deckerbullocksir.com

Bill Bullock
415.868.9700
b.bullock@deckerbullocksir.com

185 GILMARTIN DRIVE | TIBURON, CA 94920

Estimated Total Finished Square Footage: 13,185 SQ FT

Above-Grade: 9,460 SQ FT Below-Grade: 3,725 SQ FT
 Plus 925 SQ FT 4-Car Garage in Lower Level
 Plus 80 SQ FT Mech Room on Lower Level
 Plus 525 SQ FT Unfinished Storage (Au Pair Apartment)
 Calculated per ANSI Standard Z765-2003

• **Main Residence: 10,690 SQ FT**

Main Level: 4,915 SQ FT
 Upper Level: 2,935 SQ FT
 Lower Level: 2,840 SQ FT

• **Guest House : 1,970 SQ FT**

Main Level: 1,085 SQ FT
 Lower Level: 885 SQ FT

• **Au Pair Apartment: 525 SQ FT**

Main Level: 525 SQ FT
 Lower Level: N/A

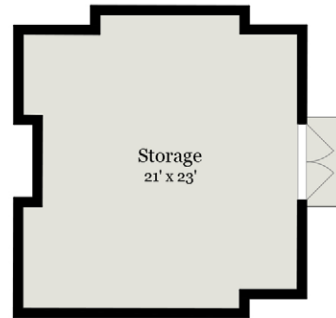

185 GILMARTIN DRIVE | TIBURON, CA 94920

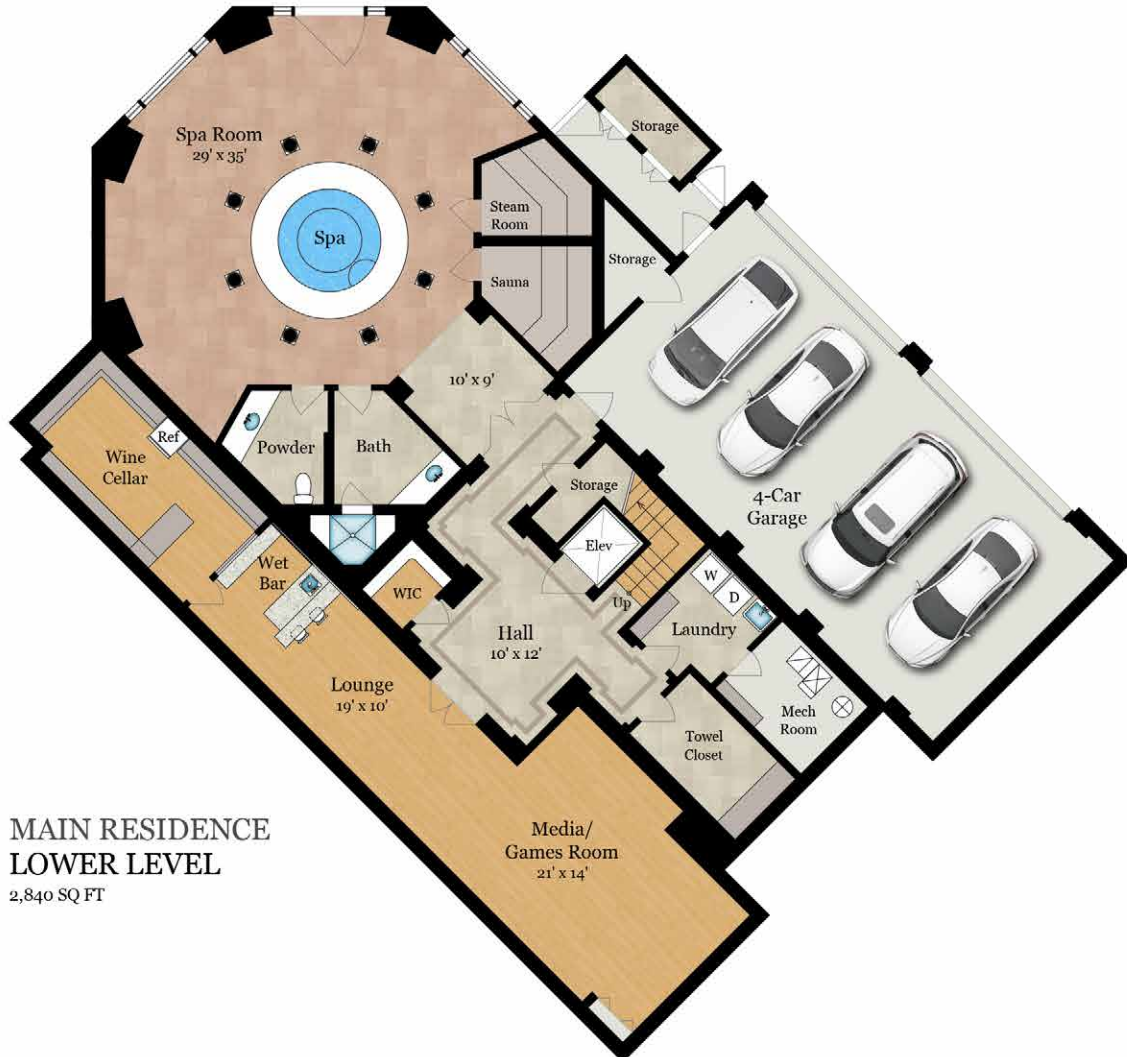

**MAIN RESIDENCE
LOWER LEVEL**
2,840 SQ FT



**GUEST HOUSE
MAIN LEVEL**
1,085 SQ FT



**GUEST HOUSE
LOWER LEVEL**
885 SQ FT



Rendering by Floor Plan Visuals.
All measurements are approximate. While deemed reliable, no information on these floor plans should be relied upon without independent verification.

Lydia Sarkissian
Tel: 415.517.7720
Email: l.sarkissian@deckerbullocksir.com

Bill Bullock
415.868.9700
b.bullock@deckerbullocksir.com