

HOME OF THE WEEK

Nautical nuance on the Strand

DINAH ENG

A sculpted steel-and-glass home, designed with the curved lines of an ocean liner, sits on the Strand in Manhattan Beach, steps from the beach and an ocean view that extends from the Palos Verdes Peninsula to Malibu.

The house, owned by Filimation co-founder Lou Scheimer, who co-created the cartoons "Fat Albert and the Cosby Kids" and "He-Man and the Masters of the Universe," was designed in 1988 by Ray Kappe, architect and co-founder of the Southern California Institute of Architecture.

"My parents built it as a weekend retreat, tearing down a funky house that was on the lot back then," says Erika Scheimer, the couple's daughter. "The house

changed the face of Manhattan Beach because Dad loved to create new pieces of art, and they wanted a round house on the beach."

The contemporary design features a 12-foot stainless-steel front door with sculptural facade that pivots open to an entry of sand-blasted concrete walls and granite floors. A three-story atrium filled with greenery is paneled in teak and curves around a hidden powder room.

A few steps up is the main level of the house, featuring the living room, a dining area, a built-in 18-foot bar and a kitchen. The front-facing walls and windows are curved, creating the feel of being on a ship.

In the dining area, a Fasar cooktop is built into the counter to keep food warm, supplementing the Jenn-Air cooktop in the kitchen. Behind the kitchen is a laundry area, a half-bathroom, a wine storage room and a three-car garage. A sound system pipes music throughout the house.

Below the main level is a family room that offers a ground-level view of the beach. Two bedrooms and two bathrooms, separated by the atrium, are off the family room.

Upstairs, a glass catwalk leads to the master suite, a loft-like space that features an overhead retractable screen, an outdoor deck and views of the beach.

A hallway leads to two walk-in closets and the master bathroom, which has a spa tub, two toilets and a steam room with a double-shower and built-in bench.

A spiral staircase leads from the master bathroom area to a pool on the roof and three deck areas.

A bathroom for the pool is tucked behind the spiral staircase. A second staircase from the master bedroom also leads to the pool deck. There's a one-person elevator from the ground level to the roof.

To submit a candidate for Home of the Week, send high-resolution color photos on a CD, caption information, the name of the photographer and a description of the house to Lauren Beale, Business, Los Angeles Times, 202 W. 1st St., L.A., CA 90012. Questions may be sent to homeoftheweek@latimes.com.

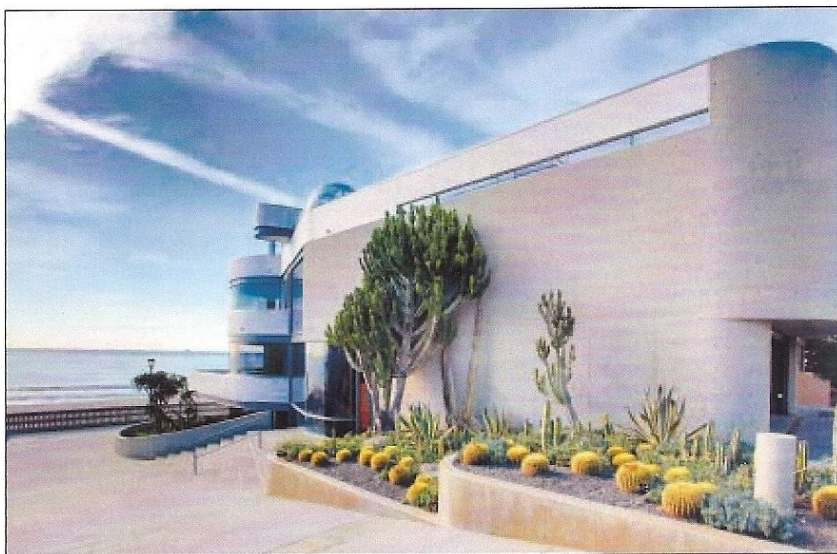

Photographs by SCOTT MAYORAL

STEADY AS SHE GOES: The curved lines of this 1988 sculpted steel-and-glass home in Manhattan Beach, designed by Ray Kappe, evoke a majestic ship. The home is listed at \$13.5 million.

Beach cruise

Location: 1600 the Strand, Manhattan Beach 90266

Asking price: \$13.5 million

Lot purchased for: \$555,000 in the early 1980s

Size: There are three bedrooms, four full bathrooms and two half-baths in about 5,226 square feet.

Additional features: Alarm system, KitchenAid double oven, three fireplaces, cactus garden.

Around the neighborhood:

Through 2009, 289 single-family homes sold in the 90266 ZIP Code, according to MDA DataQuick, at a median price of \$1,375,000. That was a 14.1% price drop from 2008.

Listing agents: Crosby Doe, Crosby Doe Associates, Beverly Hills, (310) 428-6755, and Gerard Bisignano, Peninsula Sotheby's International Realty, Manhattan Beach, (310) 990-4727.

latimes.com/realestate

Home of the Week

Check out more photos of this and previously featured homes.

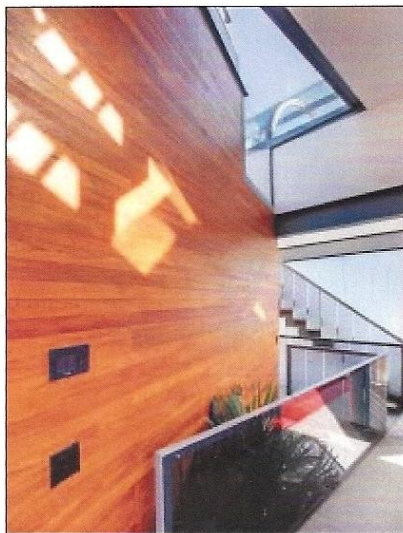

CENTRAL CORE: The three-story atrium features greenery and is paneled with teak.

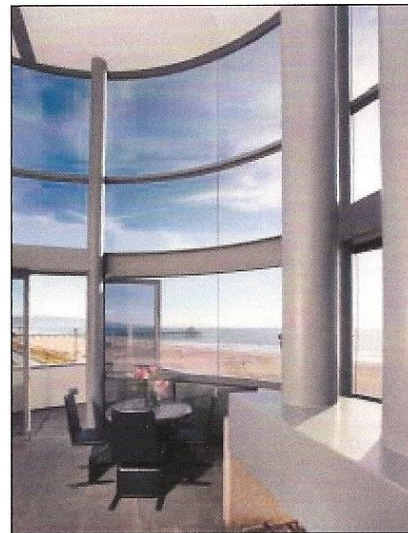

MAX HEADROOM: A corner of the main entertainment/living area has higher ceilings.

