

Buyer Info Packet

279 MARION ST INDIAN HARBOUR BEACH FL 32937

<i>SPD</i>	<i>2</i>
<i>LBPD</i>	<i>6</i>
<i>Complying with the Lead-Based Paint Law</i>	<i>7</i>
<i>Flood Disclosure (FD-2)</i>	<i>9</i>
<i>Property Information Sheet</i>	<i>10</i>
<i>Property Inventory</i>	<i>11</i>
<i>Floor Plan</i>	<i>12</i>

Seller's Property Disclosure – Residential

Notice to Licensee and Seller: Only the Seller should fill out this form.

Notice to Seller: Florida law¹ requires a **Seller** of a home to disclose to the **Buyer** all known facts that materially affect the value of the property being sold and that are not readily observable or known by the **Buyer**. This disclosure form is designed to help you comply with the law. However, this disclosure form may not address every significant issue that is unique to the Property. You should think about what you would want to know if you were buying the Property today; and if you need more space for additional information, comments, or explanations, check the Paragraph 12 checkbox and attach an addendum.

Notice to Buyer: The following representations are made by **Seller** and **not** by any real estate licensee. This disclosure is not a guaranty or warranty of any kind. It is not a substitute for any inspections, warranties, or professional advice you may wish to obtain. It is not a substitute for your own personal judgment and common sense. The following information is based only upon **Seller's** actual knowledge of the Property's condition. **Sellers** can disclose only what they actually know. **Seller** may not know about all material or significant items. You should have an independent, professional home inspection to verify the condition of the Property and determine the cost of repairs, if any. This disclosure is not a contract and is not intended to be a part of any contract for sale and purchase.

Seller makes the following disclosure regarding the property described as: 279 MARION ST INDIAN HARBOUR BEACH FL 32937 (the "Property")

The Property is owner occupied tenant occupied unoccupied (If unoccupied, how long has it been since **Seller** occupied the Property? _____)

	<u>Yes</u>	<u>No</u>	<u>Don't Know</u>
1. Structures; Systems; Appliances			
(a) Are the structures including roofs; ceilings; walls; doors; windows; foundation; and pool, hot tub, and spa, if any, structurally sound and free of leaks?	<input checked="" type="checkbox"/>	<input type="checkbox"/>	<input type="checkbox"/>
(b) Is seawall, if any, and dockage, if any, structurally sound?	<input checked="" type="checkbox"/>	<input type="checkbox"/>	<input type="checkbox"/>
(c) Are existing major appliances and heating, cooling, mechanical, electrical, security, and sprinkler systems, in working condition, i.e., operating in the manner in which the item was designed to operate?	<input checked="" type="checkbox"/>	<input type="checkbox"/>	<input type="checkbox"/>
(d) Does the Property have aluminum wiring other than the primary service line?	<input type="checkbox"/>	<input checked="" type="checkbox"/>	<input type="checkbox"/>
(e) Are any of the appliances leased? If yes, which ones: _____	<input type="checkbox"/>	<input checked="" type="checkbox"/>	<input type="checkbox"/>
(f) If any answer to questions 1(a) – 1(c) is no, please explain: _____			
2. Termites; Other Wood-Destroying Organisms; Pests			
(a) Are termites; other wood-destroying organisms, including fungi; or pests present on the Property or has the Property had any structural damage by them?	<input type="checkbox"/>	<input checked="" type="checkbox"/>	<input type="checkbox"/>
(b) Has the Property been treated for termites; other wood-destroying organisms, including fungi; or pests?	<input type="checkbox"/>	<input checked="" type="checkbox"/>	<input type="checkbox"/>
(c) If any answer to questions 2(a) - 2(b) is yes, please explain: _____			
3. Water Intrusion; Drainage; Flooding			
(a) Has past or present water intrusion affected the Property?	<input type="checkbox"/>	<input checked="" type="checkbox"/>	<input type="checkbox"/>
(b) Have past or present drainage or flooding problems affected the Property?	<input type="checkbox"/>	<input checked="" type="checkbox"/>	<input type="checkbox"/>
(c) Is any of the Property located in a special flood hazard area?	<input type="checkbox"/>	<input checked="" type="checkbox"/>	<input type="checkbox"/>
(d) Is any of the Property located seaward of the coastal construction control line?	<input type="checkbox"/>	<input checked="" type="checkbox"/>	<input type="checkbox"/>
(e) Does your lender require flood insurance?	<input type="checkbox"/>	<input checked="" type="checkbox"/>	<input type="checkbox"/>
(f) Do you have an elevation certificate? If yes, please attach a copy.	<input type="checkbox"/>	<input checked="" type="checkbox"/>	<input type="checkbox"/>
(g) If any answer to questions 3(a) - 3(d) is yes, please explain: _____			

¹ Johnson v. Davis, 480 So.2d 625 (Fla. 1985).

Seller   and Buyer (____) (____) acknowledge receipt of a copy of this page, which is Page 1 of 4
SPDR-4x Rev 3/25

	<u>Yes</u>	<u>No</u>	<u>Don't Know</u>
4. Plumbing			
(a) What is your drinking water source? <input checked="" type="checkbox"/> public <input type="checkbox"/> private <input type="checkbox"/> well <input type="checkbox"/> other			
(b) Have you ever had a problem with the quality, supply, or flow of potable water?	<input type="checkbox"/>	<input checked="" type="checkbox"/>	<input type="checkbox"/>
(c) Do you have a water treatment system? If yes, is it <input type="checkbox"/> owned <input type="checkbox"/> leased?	<input type="checkbox"/>	<input checked="" type="checkbox"/>	<input type="checkbox"/>
(d) Do you have a <input checked="" type="checkbox"/> sewer or <input type="checkbox"/> septic system? If septic system, describe the location of each system: _____			
(e) Are any septic tanks, drain fields, or wells that are not currently being used located on the Property?	<input type="checkbox"/>	<input checked="" type="checkbox"/>	<input type="checkbox"/>
(f) Are there or have there been any defects to the water system, septic system, drain fields or wells?	<input type="checkbox"/>	<input checked="" type="checkbox"/>	<input type="checkbox"/>
(g) Have there been any plumbing leaks since you have owned the Property?	<input type="checkbox"/>	<input checked="" type="checkbox"/>	<input type="checkbox"/>
(h) Are any polybutylene pipes on the Property?	<input type="checkbox"/>	<input checked="" type="checkbox"/>	<input type="checkbox"/>
(i) If any answer to questions 4(b), 4(c), and 4(e) - 4(h) is yes, please explain: _____			

5. Roof and Roof-Related Items			
(a) To your knowledge, is the roof structurally sound and free of leaks?	<input checked="" type="checkbox"/>	<input type="checkbox"/>	<input type="checkbox"/>
(b) The age of the roof is <u> 0 </u> years OR date installed <u> May 7, 2026 </u>			
(c) Has the roof ever leaked during your ownership?	<input type="checkbox"/>	<input checked="" type="checkbox"/>	<input type="checkbox"/>
(d) To your knowledge, has there been any repair, restoration, replacement (indicate full or partial) or other work undertaken on the roof? If yes, please explain: _____	<input type="checkbox"/>	<input checked="" type="checkbox"/>	<input type="checkbox"/>
(e) Are you aware of any defects to the roof, fascia, soffits, flashings or any other component of the roof system? If yes, please explain: _____	<input type="checkbox"/>	<input checked="" type="checkbox"/>	<input type="checkbox"/>

6. Pools; Hot Tubs; Spas			
Note: Florida law requires swimming pools, hot tubs, and spas that received a certificate of completion on or after October 1, 2000, to have at least one safety feature as specified by Section 515.27, Florida Statutes.			
(a) If the Property has a swimming pool, hot tub, or spa that received a certificate of completion on or after October 1, 2000, indicate the existing safety feature(s): <input type="checkbox"/> enclosure that meets the pool barrier requirements <input type="checkbox"/> approved safety pool cover <input type="checkbox"/> required door and window exit alarms <input type="checkbox"/> required door locks <input type="checkbox"/> none			
(b) Has an in-ground pool on the Property been demolished and/or filled?	<input type="checkbox"/>	<input checked="" type="checkbox"/>	<input type="checkbox"/>

7. Sinkholes			
Note: When an insurance claim for sinkhole damage has been made by the seller and paid by the insurer, Section 627.7073(2)(c), Florida Statutes, requires the seller to disclose to the buyer that a claim was paid and whether or not the full amount paid was used to repair the sinkhole damage.			
(a) Does past or present settling, soil movement, or sinkhole(s) affect the Property or adjacent properties?	<input type="checkbox"/>	<input checked="" type="checkbox"/>	<input type="checkbox"/>
(b) Has any insurance claim for sinkhole damage been made? If yes, was the claim paid? <input type="checkbox"/> yes <input type="checkbox"/> no If the claim was paid, were all the proceeds used to repair the damage? <input type="checkbox"/> yes <input type="checkbox"/> no	<input type="checkbox"/>	<input checked="" type="checkbox"/>	<input type="checkbox"/>
(c) If any answer to questions 7(a) - 7(b) is yes, please explain: _____			

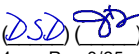
Seller  and Buyer (____) (____) acknowledge receipt of a copy of this page, which is Page 2 of 4
SPDR-4x Rev 3/25

	<u>Yes</u>	<u>No</u>	<u>Don't Know</u>
8. Homeowners' Association Restrictions; Boundaries; Access Roads			
(a) Is membership in a homeowner's association mandatory or do any covenants, conditions or restrictions (CCRs) affect the Property? (CCRs include deed restrictions, restrictive covenants and declaration of covenants.) Notice to Buyer: If yes, you should read the association's official records and/or the CCRs before making an offer to purchase. These documents contain information on significant matters, such as recurring dues or fees; special assessments; capital contributions, penalties; and architectural, building, landscaping, leasing, parking, pet, resale, vehicle and other types of restrictions.	<input type="checkbox"/>	<input checked="" type="checkbox"/>	<input type="checkbox"/>
(b) Are there any proposed changes to any of the restrictions?	<input type="checkbox"/>	<input checked="" type="checkbox"/>	<input type="checkbox"/>
(c) Are any driveways, walls, fences, or other features shared with adjoining landowners?	<input type="checkbox"/>	<input checked="" type="checkbox"/>	<input type="checkbox"/>
(d) Are there any encroachments on the Property or any encroachments by the Property's improvements on other lands?	<input type="checkbox"/>	<input checked="" type="checkbox"/>	<input type="checkbox"/>
(e) Are there boundary line disputes or easements affecting the Property?	<input type="checkbox"/>	<input checked="" type="checkbox"/>	<input type="checkbox"/>
(f) Are you aware of any existing, pending or proposed legal or administrative action affecting homeowner's association common areas (such as clubhouse, pools, tennis courts or other areas)?	<input type="checkbox"/>	<input checked="" type="checkbox"/>	<input type="checkbox"/>
(g) Have any subsurface rights, as defined by Section 689.29(3)(b), Florida Statutes, been severed from the Property? If yes, is there a right of entry? <input type="checkbox"/> yes <input type="checkbox"/> no	<input type="checkbox"/>	<input checked="" type="checkbox"/>	<input type="checkbox"/>
(h) Are access roads <input type="checkbox"/> private <input checked="" type="checkbox"/> public? If private, describe the terms and conditions of the maintenance agreement: _____ _____			
(i) If any answer to questions 8(a) - 8(g) is yes, please explain: _____ _____			
9. Environmental			
(a) Was the Property built before 1978? If yes, please see Lead-Based Paint Disclosure.	<input checked="" type="checkbox"/>	<input type="checkbox"/>	<input type="checkbox"/>
(b) Does anything exist on the Property that may be considered an environmental hazard, including but not limited to, lead-based paint; asbestos; mold; urea formaldehyde; radon gas; methamphetamine contamination; defective drywall; fuel, propane, or chemical storage tanks (active or abandoned); or contaminated soil or water?	<input type="checkbox"/>	<input checked="" type="checkbox"/>	<input type="checkbox"/>
(c) Has there been any damage, clean up, or repair to the Property due to any of the substances or materials listed in subsection (b) above?	<input type="checkbox"/>	<input checked="" type="checkbox"/>	<input type="checkbox"/>
(d) Are any mangroves, archeological sites, or other environmentally sensitive areas located on the Property?	<input type="checkbox"/>	<input checked="" type="checkbox"/>	<input type="checkbox"/>
(e) If any answer to questions 9(b) - 9(d) is yes, please explain: _____ _____			
10. Governmental, Claims and Litigation			
(a) Are there any existing, pending or proposed legal or administrative claims affecting the Property?	<input type="checkbox"/>	<input checked="" type="checkbox"/>	<input type="checkbox"/>
(b) Are you aware of any existing or proposed municipal or county special assessments affecting the Property?	<input type="checkbox"/>	<input checked="" type="checkbox"/>	<input type="checkbox"/>
(c) Is the Property subject to any Qualifying Improvements assessment per Section 163.081, Florida Statutes?	<input type="checkbox"/>	<input checked="" type="checkbox"/>	<input type="checkbox"/>
(d) Are you aware of the Property ever having been, or is it currently, subject to litigation or claim, including but not limited to, defective building products, construction defects and/or title problems?	<input type="checkbox"/>	<input checked="" type="checkbox"/>	<input type="checkbox"/>
(e) Have you ever had any claims filed against your homeowner's Insurance policy?	<input type="checkbox"/>	<input checked="" type="checkbox"/>	<input type="checkbox"/>

- (f) Are there any zoning violations or nonconforming uses?
- (g) Are there any zoning restrictions affecting improvements or replacement of the Property?
- (h) Do any zoning, land use or administrative regulations conflict with the existing use of the Property?
- (i) Do any restrictions, other than association or flood area requirements, affect improvements or replacement of the Property?
- (j) Are any improvements located below the base flood elevation?
- (k) Have any improvements been constructed in violation of applicable local flood guidelines?
- (l) Have any improvements to the Property, whether by your or by others, been constructed in violation of building codes or without necessary permits?
- (m) Are there any active permits on the Property that have not been closed by a final inspection?
- (n) Is there any violation or non-compliance regarding any unrecorded liens; code enforcement violations; or governmental, building, environmental and safety codes, restrictions or requirements?
- (o) If any answer to questions 10(a) - 10(n) is yes, please explain: _____

- (p) Is the Property located in a historic district?
- (q) Is the Seller aware of any restrictions as a result of being located in a historic district?
- (r) Are there any active or pending applications or permits with a governing body over the historic district?
- (s) Are there any violations of the rules applying to properties in a historic district?
- (t) If the answer to 10(q) – 10(s) is yes, please explain: _____

11. Foreign Investment in Real Property Tax Act ("FIRPTA")

- (a) Is the Seller subject to FIRPTA withholding per Section 1445 of the Internal Revenue Code?
If yes, Buyer and Seller should seek legal and tax advice regarding compliance.

12. (If checked) **Other Matters; Additional Comments:** The attached addendum contains additional information, explanation, or comments.

Seller represents that the information provided on this form and any attachments is accurate and complete to the best of **Seller's** knowledge on the date signed by **Seller**. **Seller** authorizes listing broker to provide this disclosure statement to real estate licensees and prospective buyers of the Property. **Seller** understands and agrees that **Seller** will promptly notify **Buyer** in writing if any information set forth in this disclosure statement becomes inaccurate or incorrect.

Seller: David Dow / David Dow Date: April 30, 2026
 (signature) (print)

Seller: Jennifer Dow / Jennifer Dow Date: April 28, 2026
 (signature) (print)

Buyer acknowledges that **Buyer** has read, understands, and has received a copy of this disclosure statement.

Buyer: _____ / _____ Date: _____
 (signature) (print)

Buyer: _____ / _____ Date: _____
 (signature) (print)

Seller (Signature) and Buyer (_____) (_____) acknowledge receipt of a copy of this page, which is Page 4 of 4
SPDR-4x Rev 3/25

Comprehensive Rider to the Residential Contract For Sale And Purchase

THIS FORM HAS BEEN APPROVED BY THE FLORIDA REALTORS AND THE FLORIDA BAR

If initialed by all parties, the clauses below will be incorporated into the Florida Realtors®/Florida Bar Residential Contract For Sale And Purchase between David Dow (SELLER) and Jennifer Dow (BUYER) concerning the Property described as 279 MARION ST INDIAN HARBOUR BEACH FL 32937

Buyer's Initials _____ Seller's Initials DSD JD

P. LEAD-BASED PAINT DISCLOSURE (Pre-1978 Housing)

Lead-Based Paint Warning Statement

"Every purchaser of any interest in residential real property on which a residential dwelling was built prior to 1978 is notified that such property may present exposure to lead from lead-based paint that may place young children at risk of developing lead poisoning. Lead poisoning in young children may produce permanent neurological damage, including learning disabilities, reduced intelligence quotient, behavioral problems, and impaired memory. Lead poisoning also poses a particular risk to pregnant women. The seller of any interest in residential real property is required to provide the buyer with any information on lead-based paint hazards from risk assessments or inspection in the seller's possession and notify the buyer of any known lead-based paint hazards. A risk assessment or inspection for possible lead-based paint hazards is recommended prior to purchase."

Seller's Disclosure (INITIAL)

- DSD (a) Presence of lead-based paint or lead-based paint hazards (CHECK ONE BELOW):
 - Known lead-based paint or lead-based paint hazards are present in the housing.
 - Seller has no knowledge of lead-based paint or lead-based paint hazards in the housing.
- DSD (b) Records and reports available to the Seller (CHECK ONE BELOW):
 - Seller has provided the Buyer with all available records and reports pertaining to lead-based paint or lead-based paint hazards in the housing. List documents: _____
 - Seller has no reports or records pertaining to lead-based paint or lead-based paint hazards in the housing.

Buyer's Acknowledgement (INITIAL)

- _____ (c) Buyer has received copies of all information listed above.
- _____ (d) Buyer has received the pamphlet *Protect Your Family from Lead in Your Home*.
- _____ (e) Buyer has (CHECK ONE BELOW):
 - Received a 10-day opportunity (or other mutually agreed upon period) to conduct a risk assessment or inspection for the presence of lead-based paint or lead-based paint hazards; or
 - Waived the opportunity to conduct a risk assessment or inspection for the presence of lead-based paint or lead-based paint hazards.

Licensee's Acknowledgement (INITIAL)

- EF (f) Licensee has informed the Seller of the Seller's obligations under 42 U.S.C.4852(d) and is aware of Licensee's responsibility to ensure compliance.

Certification of Accuracy

The following parties have reviewed the information above and certify, to the best of their knowledge, that the information they have provided is true and accurate.

<u>David Dow</u>	_____	_____	_____
SELLER	Date	BUYER	Date
<u>Jennifer Dow</u>	_____	_____	_____
SELLER	Date	BUYER	Date
<u>Erin Fernandez</u>	_____	_____	_____
Listing Licensee	Date	Selling Licensee	Date

Any person or persons who knowingly violate the provisions of the Residential Lead-Based Paint Hazard Reduction Act of 1992 may be subject to civil and criminal penalties and potential triple damages in a private civil lawsuit.

Complying With the Lead-based Paint Law: Licensee Notice to Seller/Landlord



I am notifying you of your responsibilities under the Lead-Based Paint Hazard Reduction Act of 1992 and its implementing regulations. As the owner of a residential dwelling unit built in 1977 or earlier, you have the following disclosure and other requirements (for purposes of this document, "LBP" will mean lead-based paint and "LBPH" will mean lead-based paint hazards, which are conditions that cause exposure to lead from lead-contaminated dust, soil or paint that is deteriorated or present in accessible surfaces or surfaces that rub together, like doors and windows):

1. Before You Sign a Contract/Lease. Before a buyer or tenant becomes obligated by contract to buy or lease your housing, you must complete the activities listed in A-D below. If you receive an offer before you provide the required information, you cannot accept the offer until after the information is given. This may be accomplished by making a counter offer that allows the buyer or tenant an opportunity to review the information and amend the offer if he or she so chooses. You must:

A. Disclose to each licensee or other agent (for purposes of this law, anyone who enters into a contract with you or your representative for the purpose of selling your home, except for buyer's agents who are paid solely by the buyer and not by you or your representative, is considered an "agent") involved in the transaction:

- (1) the presence of any LBP/LBPH about which you know;
- (2) any additional information available concerning the LBP/LBPH, including the basis for determining that LBP/LBPH exists, the location of the LBP/LBPH and the condition of the painted surfaces; and
- (3) the existence of any available records or reports pertaining to LBP/LBPH.

B. Provide the buyer or tenant with:

- (1) an EPA-approved lead hazard information pamphlet. This means either the EPA document entitled "Protect Your Family From Lead in Your Home" or an equivalent pamphlet approved by the EPA for use in Florida; and
- (2) any records or reports available to you concerning LBP/LBPH in the unit, including records and reports regarding any common areas. If the unit is in multifamily housing that you own and you had an evaluation or reduction of LBP/LBPH in the housing as a whole, you must provide available records and reports regarding other residential dwellings in that housing.

C. Disclose to the buyer or tenant:

- (1) the presence of any known LBP/LBPH in the unit; and
- (2) any additional information available concerning the LBP/LBPH, such as the basis for determining that LBP/LBPH exists, the location of the LBP/LBPH and the condition of the painted surfaces.

D. Allow the buyer time to conduct a risk assessment or inspection for the presence of LBP/LBPH. You must give the buyer a 10 day period unless you agree with the buyer, in writing, to another period of time (such as within the time allowed for property inspections) or unless the buyer indicates in writing that he or she waives the right to conduct the risk assessment or inspection. This inspection requirement does not apply to tenants.

2. Sales Contract Requirements. You must ensure that the sales contract has an attachment having the following elements:

A. The following Lead Warning Statement: "Every purchaser of any interest in residential real property on which a residential dwelling was built prior to 1978 is notified that such property may present exposure to lead from lead-based paint that may place young children at risk of developing lead poisoning. Lead poisoning in young children may produce permanent neurological damage, including learning disabilities, reduced intelligence quotient, behavioral problems, and impaired memory. Lead poisoning also poses a particular risk to pregnant women. The seller of any interest in residential real property is required to provide the buyer with any information on lead-based paint hazards from risk assessments or inspection in the seller's possession and notify the buyer of any known lead-based paint hazards. A risk assessment or inspection for possible lead-based paint hazards is recommended prior to purchase."

B. A statement by you disclosing the presence of known LBP/LBPH in the home and any additional information available concerning the LBP/LBPH, such as the basis for determining that it exists, its location and the condition of the painted surfaces; OR indicating that you have no knowledge of the presence of LBP/LBPH in the home.

C. A list of any records or reports described in 1.B.(2) that are available to you and that you have provided to the buyer; OR a statement that no such records or reports are available to you.

D. A statement by the buyer:

- (1) affirming receipt of the information in 2.B and C above;
- (2) affirming receipt of the lead hazard information pamphlet noted in 1.B.(1) above; and
- (3) that he or she has either had the opportunity to conduct the risk assessment or inspection required as noted in 1. D. above or waived the opportunity.

E. A statement by each real estate licensee/agent involved in the transaction that:

- (1) the licensee/agent has informed you of your legal obligations; and
- (2) the licensee/agent is aware of his or her duty to ensure compliance with the law.

F. Signatures of you, the licensees/agents and the buyers certifying to the accuracy of their statements to the best of their knowledge, and the dates of the signatures.

Seller  (____) or Landlord (____) (____) acknowledge receipt of a copy of this page, which is Page 1 of 2 Pages.

Flood Disclosure

Florida Statute 689.302 requires a seller to complete and provide a flood disclosure to a purchaser of residential real property **at or before** the time the sales contract is executed.

Seller, David Dow Jennifer Dow, provides Buyer the following flood disclosure **at or before** the time the sales contract is executed.

Property address: 279 MARION ST INDIAN HARBOUR BEACH FL 32937

Seller, please check the applicable boxes in paragraphs (1) through (3) below.

FLOOD DISCLOSURE

Flood Insurance: Homeowners' insurance policies do not include coverage for damage resulting from floods. Buyer is encouraged to discuss the need to purchase separate flood insurance coverage with Buyer's insurance agent.

- (1) Seller has has no knowledge of any flooding that has damaged the property during Seller's ownership of the property.
- (2) Seller has has not filed a claim with an insurance provider relating to flood damage on the property, including, but not limited to, a claim with the National Flood Insurance Program.
- (3) Seller has has not received assistance for flood damage to the property, including, but not limited to, assistance from the Federal Emergency Management Agency.
- (4) For the purposes of this disclosure, the term "flooding" means a general or temporary condition of partial or complete inundation of the property caused by any of the following:
 - a. The overflow of inland or tidal waters.
 - b. The unusual and rapid accumulation of runoff or surface waters from any established water source, such as a river, stream, or drainage ditch.
 - c. Sustained periods of standing water resulting from rainfall.

Seller: David Dow

Date: April 30, 2026

Seller: JDS

Date: April 28, 2026

Copy provided to Buyer on _____ by email facsimile mail personal delivery.

Property Inventory



**COASTAL
ESTATE TEAM**

COMPASS

Owner(s): David Dow Jennifer Dow

Property Address: 279 MARION ST INDIAN HARBOUR BEACH FL 32937

Water: City Well

Irrigation: City Well Reclaimed

*If any items below are leased please make a note

ITEM	CONVEYS		
	Y	N	N/A
Appliances			
Built-In Grill			<input checked="" type="checkbox"/>
Built-In Microwave	<input checked="" type="checkbox"/>		
Cook Top	<input checked="" type="checkbox"/>		
Dishwasher	<input checked="" type="checkbox"/>		
Dryer (Electric <input checked="" type="checkbox"/> Gas)		<input checked="" type="checkbox"/>	
Freezer			<input checked="" type="checkbox"/>
Garbage Disposal	<input checked="" type="checkbox"/>		
Ice Maker			<input checked="" type="checkbox"/>
Range/Oven (Electric <input checked="" type="checkbox"/> Gas)	<input checked="" type="checkbox"/>		
Refrigerator - Kitchen	<input checked="" type="checkbox"/>		
Refrigerator - Secondary Full Size	<input checked="" type="checkbox"/>		
Trash Compactor			<input checked="" type="checkbox"/>
Undercounter Refrigerator			<input checked="" type="checkbox"/>
Wall Oven	<input checked="" type="checkbox"/>		
Washer		<input checked="" type="checkbox"/>	
Wine / Drink Refrigerator			<input checked="" type="checkbox"/>
Other:			
Cooling / Heating Systems			
Ceiling Fan(s) #	<input checked="" type="checkbox"/>		
Central A/C # 1 Heat (Gas Elec <input checked="" type="checkbox"/>)	<input checked="" type="checkbox"/>		
Fireplace (Gas Wood Burning)	<input checked="" type="checkbox"/>		
Water Heater(s) # (Gas Elec <input checked="" type="checkbox"/>)	<input checked="" type="checkbox"/>		
Window A/C # 1	<input checked="" type="checkbox"/>		
Other:			
Home Systems			
Central Vacuum			<input checked="" type="checkbox"/>
Generator			<input checked="" type="checkbox"/>
Intercom			<input checked="" type="checkbox"/>
Security System			<input checked="" type="checkbox"/>
Smoke Detector(s) # 4	<input checked="" type="checkbox"/>		
Speaker(s) # Location:			<input checked="" type="checkbox"/>
Surround Sound (components)			<input checked="" type="checkbox"/>
Surround Sound (wiring)			<input checked="" type="checkbox"/>
Water Softener			<input checked="" type="checkbox"/>
Other:			
Miscellaneous Interior			
Chandelier(s) # / Hanging Lamp(s) #	<input checked="" type="checkbox"/>		
Draperies & Rods	<input checked="" type="checkbox"/>		

ITEM	CONVEYS		
	Y	N	N/A
Sconce(s) #	<input checked="" type="checkbox"/>		
Shades & Blinds			<input checked="" type="checkbox"/>
Other:			
Garage / Gate / Mailbox			
Garage Door Remote(s) #			<input checked="" type="checkbox"/>
Gate Remote(s) #			<input checked="" type="checkbox"/>
Mailbox Number Mailbox Key(s) #			<input checked="" type="checkbox"/>
Other:			
Pool			
Hot Tub / Spa			<input checked="" type="checkbox"/>
Pool (Inground <input checked="" type="checkbox"/> Above Ground)	<input checked="" type="checkbox"/>		
Pool Barrier Fence			<input checked="" type="checkbox"/>
Pool Equipment	<input checked="" type="checkbox"/>		
Pool Pump	<input checked="" type="checkbox"/>		
Pool Salt Water System			<input checked="" type="checkbox"/>
Pool / Spa Heater (Gas Elec Solar)			<input checked="" type="checkbox"/>
Other:			
Outdoor Systems			
Drinking Water Well / Pump			<input checked="" type="checkbox"/>
Irrigation System			<input checked="" type="checkbox"/>
Irrigation Well / Pump			<input checked="" type="checkbox"/>
Landscape Lighting			<input checked="" type="checkbox"/>
Propane Gas Tank (Loc:)			<input checked="" type="checkbox"/>
Satellite Dish			<input checked="" type="checkbox"/>
Other:			
Miscellaneous Outdoor			
Awnings (Elec Manual)			<input checked="" type="checkbox"/>
Boat Dock / Boat Lift (lbs.)			<input checked="" type="checkbox"/>
Fence	<input checked="" type="checkbox"/>		
Lawn / Patio Furniture			<input checked="" type="checkbox"/>
Shed(s) #	<input checked="" type="checkbox"/>		
Storm Shutters / Panels (Elec Manual)			<input checked="" type="checkbox"/>
Summer Kitchen / Barbecue			<input checked="" type="checkbox"/>
Other:			
Other Items Not Listed			

David Dow April 30, 2026

Seller Date

[Signature] April 28, 2026

Seller Date

Buyer Date

Buyer Date

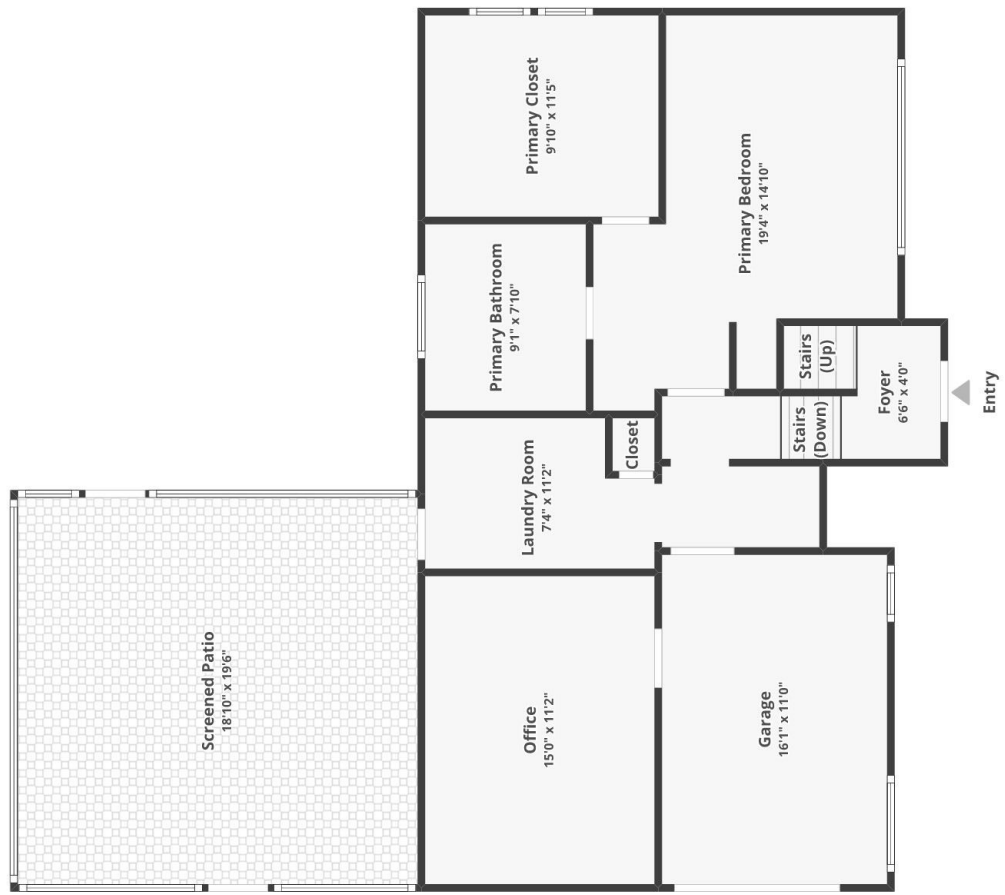

Floor plans/tour cannot be used for building or design purposes. Sizes and dimensions are approximate.

279 Marion St, Indian Harbour Beach, FL 32937