



HIDDEN HARBOR ESTATES

1245 W. Eau Gallie Blvd. Melbourne, FL 32935

AREA TABULATION UNITS A-D

FIRST FLOOR LIVING	792 SF
SECOND FLOOR LIVING	1,204 SF
TOTAL LIVING	2,096 SF
GARAGE	452 SF
ENTRY	28 SF
COVERED PORCH	66 SF
BALCONY (UNCOVERED)	44 SF
GRAND TOTAL	2,648 SF

AREA TABULATION UNITS B-C

FIRST FLOOR LIVING	828 SF
SECOND FLOOR LIVING	1,204 SF
TOTAL LIVING	2,092 SF
GARAGE	410 SF
ENTRY	32 SF
COVERED PORCH	66 SF
BALCONY (UNCOVERED)	44 SF
GRAND TOTAL	2,644 SF

BUILDING PLAN

First Floor

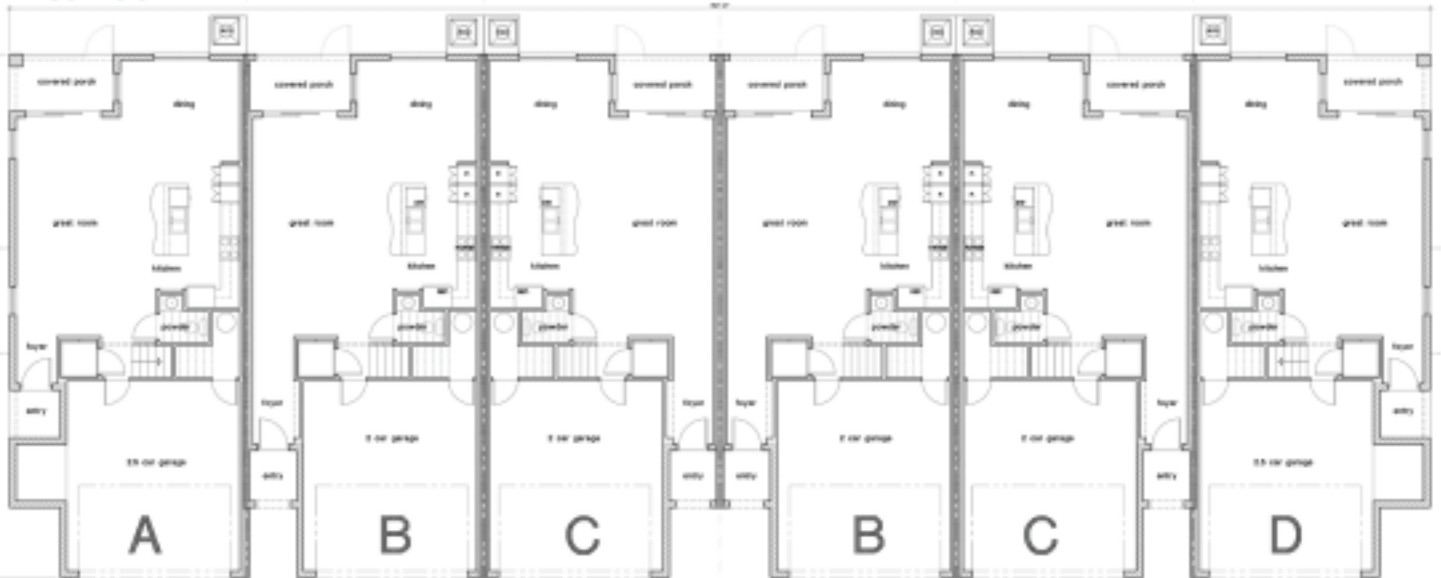

OVERALL FIRST FLOOR PLAN

Second Floor



OVERALL SECOND FLOOR PLAN

All dimensions and specifications (including square footages) are approximate and provided for comparison purposes only and are subject to change in the sole discretion of the developer and should not be relied upon when making a decision to purchase a home. Actual areas may be smaller. Maps, site plans, floor plans, sketches, drawings and elevations are artist renderings and are for informational purposes only and subject to change without notice.