

106 Norcross Lane (4720.7 sf HLA)

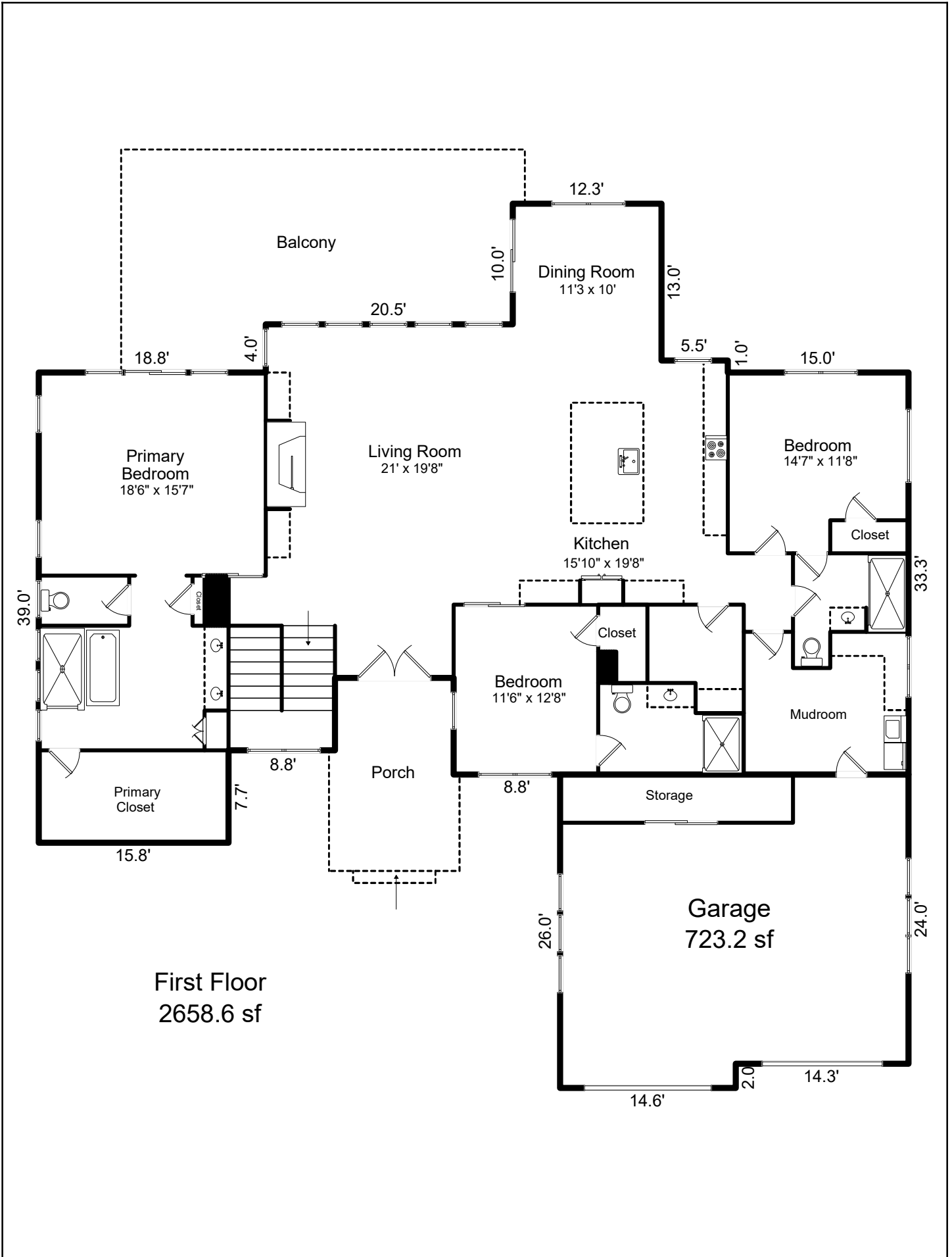

106 Norcross Lane (4720.7 sf HLA)

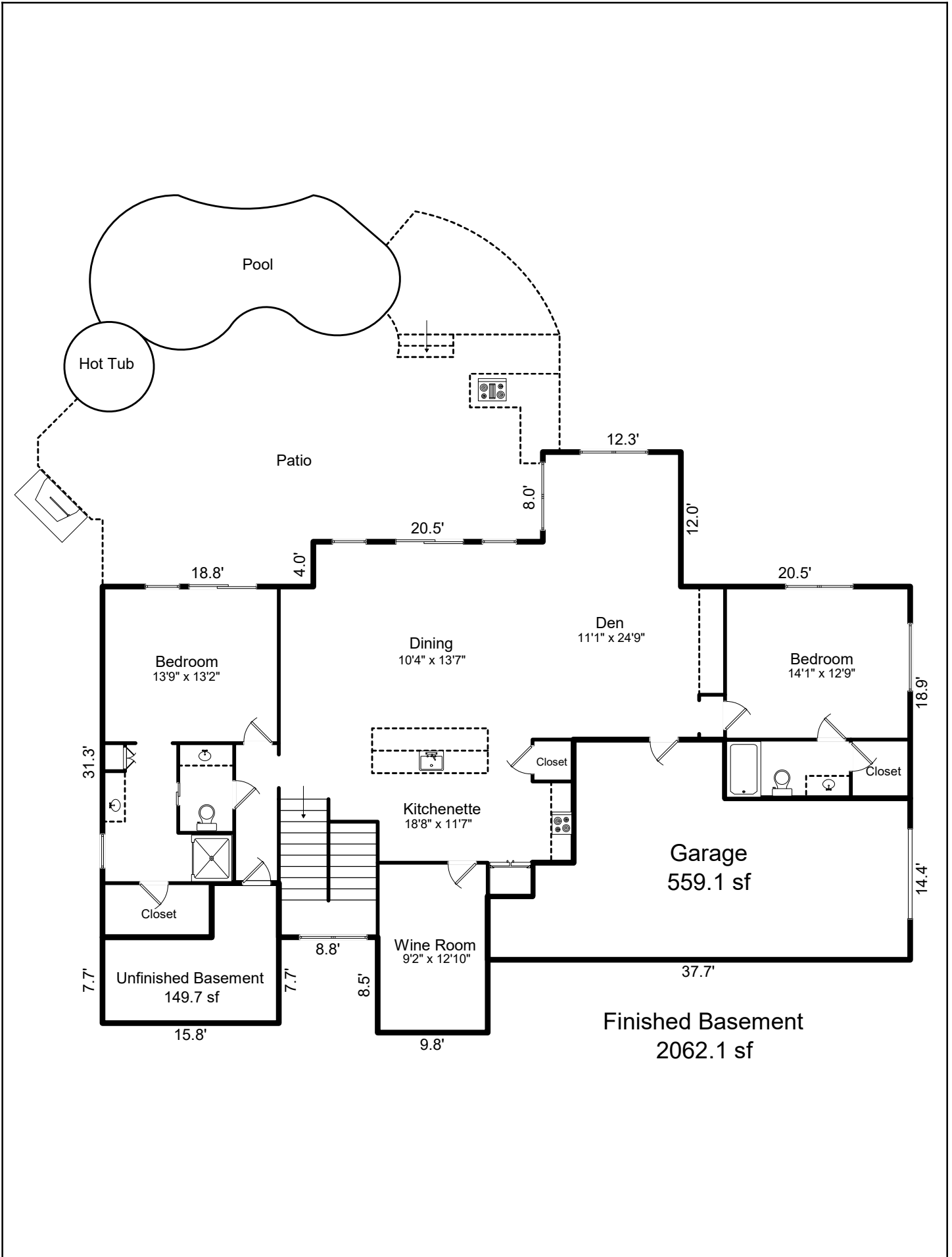

SKETCH/AREA TABLE ADDENDUM

SUBJECT INFO

File No.:	Parcel No.:		
Property Address: 106 Norcross Ln			
City:	County:	State:	ZipCode:
Owner:			
Client:		Client Address:	
Appraiser Name:		Inspection Date:	

SKETCH

Balcony (P/P)

33.50 x	4.50 =	150.75
32.50 x	10.00 =	325.00
12.00 x	4.00 =	48.00
Total area:		523.75

Garage (GAR)

28.92 x	24.00 =	694.00
14.58 x	2.00 =	29.17
Total area:		723.17

Porch (P/P)

16.00 x	9.83 =	157.33
10.00 x	0.50 =	5.00
8.00 x	0.50 =	4.00
Total area:		166.33

First Floor (GLA1)

14.00 x	12.33 =	172.67
5.50 x	1.00 =	5.50
20.50 x	4.00 =	82.00
31.33 x	0.50 =	15.67
47.58 x	25.33 =	1205.44
31.33 x	24.08 =	754.61
37.75 x	8.00 =	302.00
15.75 x	7.67 =	120.75
Total area:		2658.64

Unfinished Basement (BSMT)

15.75 x	7.67 =	120.75
6.00 x	4.83 =	29.00
Total area:		149.75

Finished Basement (BSMT)

12.00 x	1.50 =	18.00
12.00 x	10.83 =	130.00
20.50 x	4.00 =	82.00
33.33 x	9.83 =	327.78
27.67 x	4.00 =	110.67
9.83 x	6.50 =	63.92
24.67 x	3.67 =	90.44
31.33 x	8.83 =	276.78
30.08 x	13.67 =	411.09
26.50 x	15.75 =	417.38
16.55 x	5.25 =	86.89
9.75 x	4.83 =	47.13
Total area:		2062.06

Garage (GAR)

17.20 x	8.67 =	149.04
13.53 x	11.00 =	148.83
5.67 x	4.00 =	22.67
16.55 x	14.42 =	238.60
Total area:		559.13