

Regent Place

► Comparative Market Analysis, August 2023

ACTIVE
PENDING
SOLD

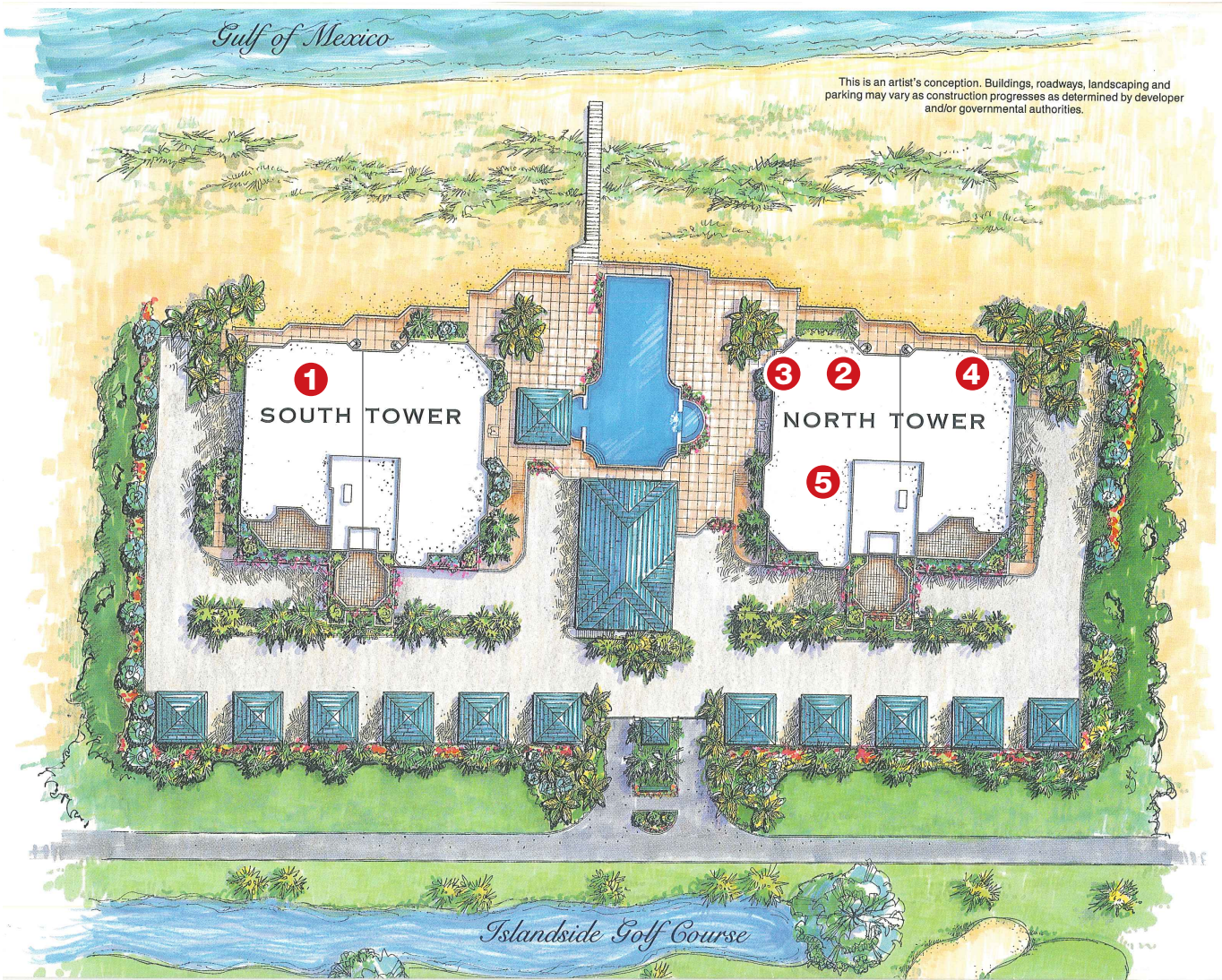

ACTIVE LISTINGS

Address	Unit	Furnishings	Sq Ft	Parking	List Price	LP/SqFt
There are currently no active listings.						

SALE PENDING

Address	Unit	Furnishings	Parking	Sq Ft	Listed Price	LP/SqFt
There are currently no pending sales.						

SOLD PROPERTIES (last 24 months)

	Address	Unit	Furnishings	Parking	Sq Ft	Sold Price	SP/SqFt	Sold Date	DTS
1	655 Longboat Club Rd	14B	Unfurnished	2	3,139	\$4,000,000	\$1,274	5/13/2022	28
2	675 Longboat Club Rd	22B	Unfurnished	2	3,258	\$4,250,000	\$1,304	9/9/2022	84
3	675 Longboat Club Rd	24A	Furnished	2	3,564	\$4,000,000	\$1,122	4/20/2022	30
4	675 Longboat Club Rd	24B	Unfurnished	2	3,139	\$4,695,000	\$1,496	2/22/2023	49
5	675 Longboat Club Rd	26A	Unfurnished	2	3,564	\$4,550,000	\$1,277	11/23/2022	1



View our properties on: pettingell.com

Non-Solicitation Disclaimer
If your property is currently listed, please disregard. It is not our intention to solicit properties that are already represented by another broker.

The property information herein is derived from various sources that may include, but not be limited to, county records and the Multiple Listing Service, and it may include approximations. Although the information is believed to be accurate, it is not warranted and you should not rely upon it without personal verification. Affiliated real estate agents are independent contractor sales associates, not employees. ©2023 Coldwell Banker. All Rights Reserved. Coldwell Banker and the Coldwell Banker logo are trademarks of Coldwell Banker Real Estate LLC. The Coldwell Banker® System is comprised of company owned offices which are owned by a subsidiary of Anywhere Advisors LLC and franchised offices which are independently owned and operated. The Coldwell Banker System fully supports the principles of the Fair Housing Act and the Equal Opportunity Act. Based on information from the Multiple Listing Service for the period August 23, 2022 through August 23, 2023.