

505 W. SAN ANTONIO ST.

FREDERICKSBURG, TEXAS | GILLESPIE COUNTY | 0.46± ACRES





FREDERICKSBURG REALTY TEXAS RANCH REALTY

505 W. San Antonio St. | Fredericksburg, Texas 78624 | Gillespie County

0.46+/- Acres

\$990,000.00

Agent

Justin Cop

Property Highlights

- 0.46± acre oversized lot in Fredericksburg city limits
- R-2 zoning with Historic District (HSD) overlay
- Built in 1907 with thoughtful updates and preserved character
- Approx. 2,567± SF total living area
- 4 bedrooms | 3 bathrooms
- Functional two-story layout with multiple living areas
- Original living space with wood ceilings and historic character
- 2014 addition includes expansive second living area and open-concept flow
- Flexible upper level with bedrooms, en-suite baths, and bonus space
- Dedicated office, den, and main-level laundry for everyday convenience
- Spacious kitchen with ample cabinetry and workspace
- Covered front porch (~225 SF)
- Screened-in back porch (~150 SF)
- Multiple outdoor living areas including concrete and rock patios
- Mature trees providing shade and established landscape character
- Two storage buildings (~247 SF & ~188 SF)
- Additional lean-to and utility/storage structures
- Water softener storage in place
- Large yard with room for expansion or customization
- Located just one block from Main Street, shopping, dining, and Fredericksburg attractions
- Situated in an area known for strong short-term rental activity (buyer to verify regulations)
- Ideal for primary residence, second home, or long-term investment use

Property Taxes:

\$4,772.47 - HS Exemption

\$11,549.76 w/o

Located just minutes from the heart of Fredericksburg, this historic 1907 home, thoughtfully updated and expanded in 2014, sits on an oversized 0.46± acre lot within an R-2 zoning district—offering a rare combination of character, space, and flexibility in one of the city's most desirable areas.

The home reflects its early 20th-century roots while incorporating more modern living spaces, featuring approximately 2,567± square feet, 4 bedrooms, and 3 bathrooms across a versatile floor plan. The original portion of the home showcases a warm, inviting formal living area with wood ceilings and classic detailing, while the 2014 addition introduced an expansive second living area and functional open-concept flow connecting the living, dining, and kitchen spaces, ideal for everyday living and entertaining.

The main level offers multiple defined living areas, along with two bedrooms and a full bath, plus a dedicated office, and laundry room for everyday convenience. The upper level provides additional bedrooms with en-suite baths, along with a flexible bonus area that can serve as a guest space, office, storage room, or additional living area.

Outdoors, the property continues to impress with a spacious backyard shaded by mature trees. A screened porch and multiple patio areas create a comfortable setting for entertaining or relaxing, while the size of the lot allows room for expansion, gardening, or additional improvements.

With nearly half an acre inside Fredericksburg city limits and a layout that blends historic charm with updated functionality, this property presents a compelling opportunity for full-time living, a weekend retreat, or long-term investment. Situated along W. San Antonio Street, it offers convenient access to Main Street, local shops, dining, and the character that defines Fredericksburg—while still providing the space and privacy that is increasingly difficult to find this close to town.

With nearly half an acre inside Fredericksburg city limits and a layout that blends historic charm with updated functionality, this property presents a compelling opportunity for full-time living, a weekend retreat, or investment use. Situated along W. San Antonio Street—just one block from Main Street—it offers convenient access to local shops, dining, and the character that defines Fredericksburg. The surrounding area is well known for its concentration of short-term rentals, further supporting the property's long-term investment appeal, **subject to applicable city regulations and permitting requirements.**

MLS #: R104374A (Active) List Price: \$990,000 (99 Hits)

505 W San Antonio St Fredericksburg, TX 78624



New Construction: No
Bedrooms: 4
Full Baths: 3
Half Baths: 0
Main House Living SqFt : 2,567
Apx Total SqFt: 2,567
Price Per SQFT: \$385.66
Source SqFt: GCAD
Appx Year Built: 1907
Type & Style: Early Fbg, Historical
Current B&B: No
Stories: Two
Heating: Central, Electric
A/C: Central Air, Electric
Garage/Carport: None

Unit #:
Original List Price: \$990,000
Area: City-Northwest
Subdivision: N/A, Not in Sub
County: Gillespie
School District: Fredericksburg
Distance From City Limits: In City Limits
Apx Acreage: 0.4600
Seller's Est Tax: 4772.40
Showing Instructions: Appointment Only, Call Listing Agent, Special Instructions
Days on Market 62

Tax Exemptions: HS **Taxes w/o Exemptions:** \$11,549.76 **Tax Info Source:** CAD **CAD Property ID #:** 26758 **Zoning:** R-2
Flood Plain: No **Deed Restrictions:** Yes **STR Permit:** No **Permit #:** 000000 **Manufactured Homes Allowed:** No
HOA: No **HOA Fees:** **HOA Fees Pd:** **HO Warranty:**
Road Maintenance Agreement: No **Rental Property:** **Rental \$:** **Items Not In Sale:**
Guest House: No **# of Guest Houses:** **Total Guest House SqFt:** 0
Guest House # Bedrooms: **Guest House # Baths:** **Guest House # Half Baths:**

Construction: Wood Siding **City/Rural:** In City Limits
Foundation: Pillar/Post/Pier, Slab **Site Features:** Deck/Patio, Double Pane Windows, Storage Building
Roof: Metal **Interior Features:** Ceiling Fan(s), Washer-Dryer Connection
Flooring: Tile, Vinyl, Wood **Topography:** City Lot, Level
Utilities: City Electric **Surface Water:** None
Water: Public **Access:** City Street
Sewer: Public Sewer **Location Description:** Gravel Drive, Historic District
Fireplace/Woodstove: None **Documents on File:** Deed Restrictions, Site Plan
Appliances: Disposal, Microwave, Range, Electric Water Heater **Misc Search:** Potential Short-Term Rental

Trms/Fin: Cash, Conventional **Possessn:** See Remarks **Excl Agy:** No
Title Company: Fredericksburg Titles **Attorney:** **Refer to MLS#:**
Location/Directions: From downtown Fredericksburg, travel W. on Main Street. Turn left onto S.Edison St, then take a right onto W. San Antonio St. The property will be on your left.
Owner: STAUDT, SALLY M ETAL **Occupancy:** Owner

Legal Description: FBG ADDN BLK 14 LOT 375, -50% INT IN HS-, GILLESPIE COUNTY, TEXAS
Instructions: Showings are by appointment only and require a minimum of 4 hours' notice. Please call the LAfor instructions.

Public Remarks: Located in the Historical District of Fredericksburg, this 1907 home, thoughtfully updated and expanded in 2014, sits on an oversized 0.46± acre lot within an R-2 zoning district—offering a rare combination of character, space, and flexibility in one of the city's most desirable areas. The home reflects its early 20th-century roots while incorporating more modern living spaces, featuring approximately 2,567± square feet, 4 bedrooms, and 3 bathrooms across a versatile floor plan. The original portion of the home showcases a warm, inviting formal living area with wood ceilings and classic detailing, while the 2014 addition introduced an expansive second living area and functional open-concept flow connecting the living, dining, and kitchen spaces, ideal for everyday living and entertaining. The main level offers multiple defined living areas, along with two bedrooms and a full bath, plus a dedicated office, and laundry room for everyday convenience. The upper level provides additional bedrooms with en-suite baths, along with a flexible bonus area that can serve as a guest space, office, storage room, or additional living area. Outdoors, the property continues to impress with a spacious backyard shaded by mature trees. A screened porch and multiple patio areas create a comfortable setting for entertaining or relaxing, while the size of the lot allows room for expansion, gardening, or additional improvements. With nearly half an acre inside Fredericksburg city limits and a layout that blends historic charm with updated functionality, this property presents a compelling opportunity for full-time living, a weekend retreat, or long-term investment. Situated along W. San Antonio Street—just one block from Main Street—it offers convenient access to local shops, dining, and the character that defines Fredericksburg. The surrounding area is well known for its concentration of short-term rentals, further supporting the property's long-term investment appeal, subject to applicable city regulations and permitting requirements.

Agent Remarks: Closing could be prior to end of May but seller will need till the end of May to move out.
Display on Internet: Yes **Display Address:** Yes **Allow AVM:** No **Allow Comments:** No

Office Broker's Lic #: 9003085

Listing Office: Fredericksburg Realty (#:14)
Main: (830) 997-6531
Mail Address 1: 257 W Main Street
Mail City: Fredericksburg
Mail Zip Code: 78624
Supervising Agent Name:
Supervising Agent License #:

Listing Agent: Justin Cop (#:130)
Agent Email: justin@fredericksburgrealty.com
Contact #: (830) 998-2895
License Number: 0613372



- Boundary
- 100 Year Floodplain
- 500 Year Floodplain
- Floodway
- Special
- Unmapped/ Not Included

505 W San Antonio St.

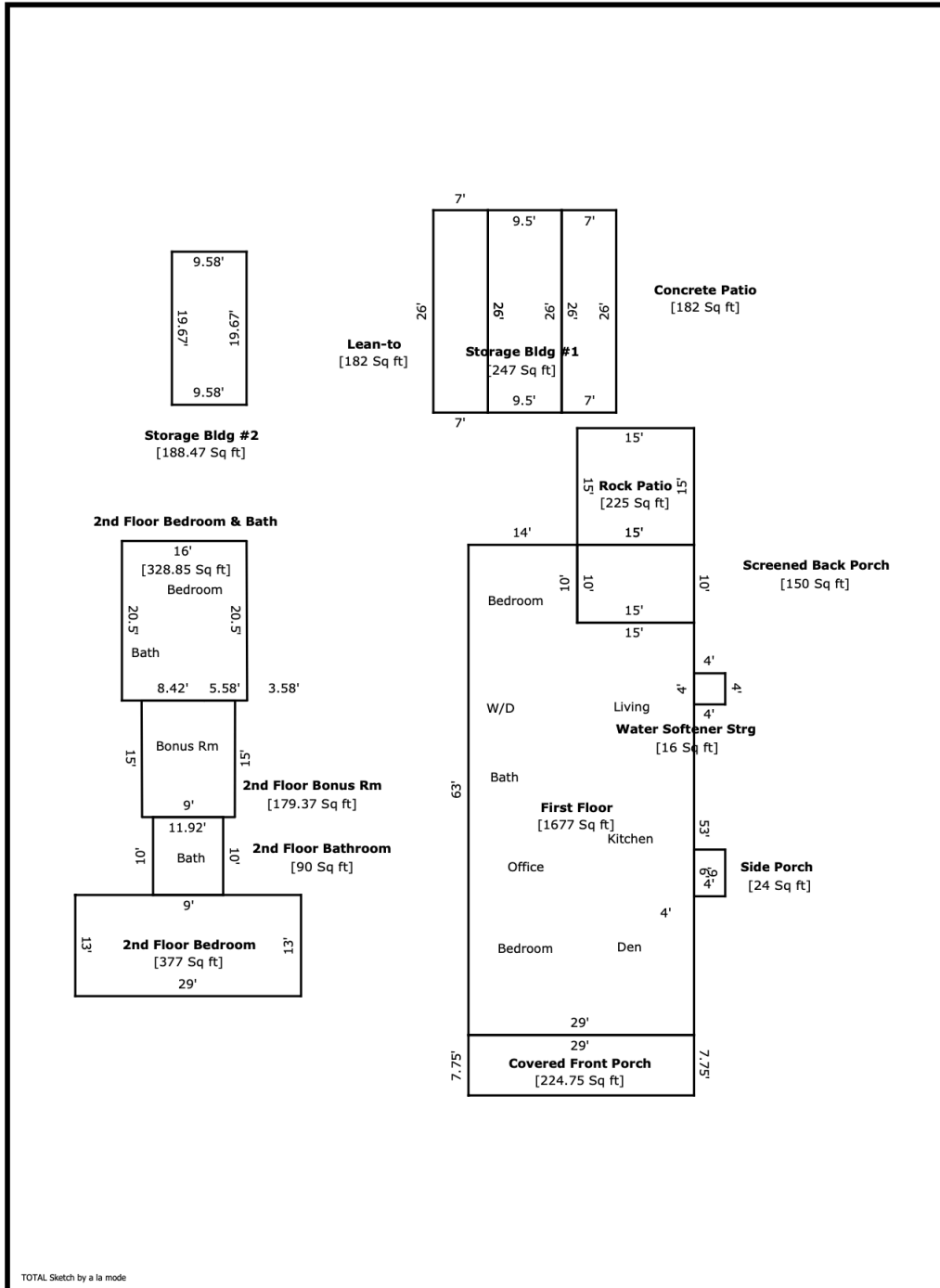



APPROVED BY THE TEXAS REAL ESTATE COMMISSION
**ADDENDUM FOR SELLER'S DISCLOSURE OF INFORMATION
ON LEAD-BASED PAINT AND LEAD-BASED PAINT HAZARDS
AS REQUIRED BY FEDERAL LAW**

10-10-11

CONCERNING THE PROPERTY AT 505 W San Antonio St Fredericksburg
(Street Address and City)

A. LEAD WARNING STATEMENT: "Every purchaser of any interest in residential real property on which a residential dwelling was built prior to 1978 is notified that such property may present exposure to lead from lead-based paint that may place young children at risk of developing lead poisoning. Lead poisoning in young children may produce permanent neurological damage, including learning disabilities, reduced intelligence quotient, behavioral problems, and impaired memory. Lead poisoning also poses a particular risk to pregnant women. The seller of any interest in residential real property is required to provide the buyer with any information on lead-based paint hazards from risk assessments or inspections in the seller's possession and notify the buyer of any known lead-based paint hazards. A risk assessment or inspection for possible lead-paint hazards is recommended prior to purchase."

NOTICE: Inspector must be properly certified as required by federal law.

B. SELLER'S DISCLOSURE:

- 1. PRESENCE OF LEAD-BASED PAINT AND/OR LEAD-BASED PAINT HAZARDS (check one box only):
 - (a) Known lead-based paint and/or lead-based paint hazards are present in the Property (explain): _____
 - (b) Seller has no actual knowledge of lead-based paint and/or lead-based paint hazards in the Property.
- 2. RECORDS AND REPORTS AVAILABLE TO SELLER (check one box only):
 - (a) Seller has provided the purchaser with all available records and reports pertaining to lead-based paint and/or lead-based paint hazards in the Property (list documents): _____
 - (b) Seller has no reports or records pertaining to lead-based paint and/or lead-based paint hazards in the Property.

C. BUYER'S RIGHTS (check one box only):

- 1. Buyer waives the opportunity to conduct a risk assessment or inspection of the Property for the presence of lead-based paint or lead-based paint hazards.
- 2. Within ten days after the effective date of this contract, Buyer may have the Property inspected by inspectors selected by Buyer. If lead-based paint or lead-based paint hazards are present, Buyer may terminate this contract by giving Seller written notice within 14 days after the effective date of this contract, and the earnest money will be refunded to Buyer.

D. BUYER'S ACKNOWLEDGMENT (check applicable boxes):

- 1. Buyer has received copies of all information listed above.
- 2. Buyer has received the pamphlet *Protect Your Family from Lead in Your Home*.

E. BROKERS' ACKNOWLEDGMENT: Brokers have informed Seller of Seller's obligations under 42 U.S.C. 4852d to:

(a) provide Buyer with the federally approved pamphlet on lead poisoning prevention; (b) complete this addendum; (c) disclose any known lead-based paint and/or lead-based paint hazards in the Property; (d) deliver all records and reports to Buyer pertaining to lead-based paint and/or lead-based paint hazards in the Property; (e) provide Buyer a period of up to 10 days to have the Property inspected; and (f) retain a completed copy of this addendum for at least 3 years following the sale. Brokers are aware of their responsibility to ensure compliance.

F. CERTIFICATION OF ACCURACY: The following persons have reviewed the information above and certify, to the best of their knowledge, that the information they have provided is true and accurate.

Buyer _____	Date _____		04/15/2026	Seller _____	Date _____
Buyer _____	Date _____			Seller _____	Date <u>4/21/26</u>
Other Broker _____	Date _____	Listing Broker		Date _____	
		Justin Cop			

The form of this addendum has been approved by the Texas Real Estate Commission for use only with similarly approved or promulgated forms of contracts. Such approval relates to this contract form only. TREC forms are intended for use only by trained real estate licensees. No representation is made as to the legal validity or adequacy of any provision in any specific transactions. It is not suitable for complex transactions. Texas Real Estate Commission, P.O. Box 12188, Austin, TX 78711-2188, 512-936-3000 (<http://www.trec.texas.gov>)

(TXR 1906) 10-10-11

TREC No. OP-L

Sec. 3.110. - R-2: MIXED RESIDENTIAL.

Intent

This zone is intended to provide for medium density living, for example, with not more than one (two bedroom) dwelling unit permitted for each 3,500 square feet of lot area. (See Site Development Regulations). Additional uses necessary and incidental to multiple family residential dwellings are also permitted. It is a zone well suited as a buffer between single family uses and other more intense uses. This zone is typically associated with Medium Density Residential Land Use category but is allowed within all Land Use categories except "Open Space/Park," "Public Facility" and "Industrial."

Principal Permitted Uses

Buildings, structures and land shall be used, and buildings and structures shall hereinafter be erected, altered or enlarged only for the following uses, plus such other uses as the City Council, by resolution, may deem to be similar to those uses listed and not obnoxious or detrimental to the public health, safety and welfare:

Community Recreation	Local Utility Service
Duplex Residential	Multiple Family Residential
Townhouses (Section 7.610)	
Group Residential	Single Family Residential (Detached)
Single Family Small Lot (Section 3.101 R-1-A)	
Short-term Rental, Accessory: (With a STR permit and adherence to Chapter 20, Article VII)	Short-term Rental, B & B: (With a STR permit and adherence to Chapter 20, Article VII)

Uses Permitted Subject To Conditional Use Permit

The following uses may be permitted subject to a Conditional Use Permit as provided in Section 5.400.

Private Primary Educational Facilities	Private Secondary Educational Facilities
--	--

Day Care Services	
Condominiums (Section 7.610)	
Convalescent Services	
Cultural Services	Religious Assembly
Guidance Services	

Property Development Standards

Except as hereinafter provided, no building or structure or part thereof shall be erected, altered or converted for any use permitted in this district unless it is in conformity with all the standards and regulations herein specified for lot area, width and depth, dwelling unit area, lot coverage, yards and building height. The following standards shall apply except in cases where a lot does not meet the standards herein required but was an official "lot of record" prior to the adoption of this ordinance. In such cases, the present dimension shall be maintained as a minimum standard until such time as the use is removed. The replacement shall meet the standards and regulations herein specified.

Site Development Regulations

Each site in the R-2 district shall be subject to the following site development regulations:

Feature	Regulation
Lot Size	Minimum Lot Area, 5,000 Square feet
Lot Width	Minimum Lot Width, 50 feet
Height	2½ Stories, 28 feet
Front Yard	Minimum Required Setback, 15 feet (20 feet for garage)
Street Side Yard	Minimum Required Setback, 15 feet
Interior Side Yard	Minimum Required Setback, 5 feet for single family detached structures; or 10 feet, for multi-family developments, when abutting residential zoning districts; or 15 feet for 2 story multi-family developments when abutting residential zoning districts

Rear Yard	Minimum Required Setback, 10 feet; or 15 feet, for multi-family developments, when abutting a residential zoning district; or 25 feet, for multi-family developments, for 2 or more stories when abutting residential zoning districts
Residential Density	Minimum Site Area per Dwelling Units, Efficiency: 2,500 Square feet
	1 Bedroom: 3,000 Square feet
	2 Bedroom: 3,500 Square feet
	3 Bedroom: 4,000 Square Feet Each additional bedroom (over 3 bedrooms) shall provide an additional 500 square feet interval to the required density area
Maximum Impervious Coverage	65%
Maximum Building Coverage	Percent of Lot Area, 55%
Nonconforming Uses	Section 6.100
Site Development Regulations	Section 7.000
Special Yard Regulations	Section 7.300
Fences, Walls and Visibility	Section 7.530
Parking	Section 7.800
Landscaping and Screening Regulations	Section 7.900
Temporary/Accessory Building	Section 8.000
Home Occupations	Section 8.300

Note— In an R-2 Zone the R-1-A Site Development Regulations may apply to the development of single family dwellings at the option of the Owner.

(Ord. No. 18-014, § 3.110, 12-1-2008; Ord. No. 23-014, 9-16-2013; Ord. No. 2022-13, § 3(Exh. C), 3-21-2022; Ord. No. 2023-18, § 8B, 11-7-2023)

Sec. 3.500. - HO: HISTORIC OVERLAY.

Intent

This zone is intended to encompass that portion of the City with historic resource value. The area within the Historic Overlay District is subject to the requirements of two sets of development standards:

1. The underlying zoning district land use designations and development standards; and
2. The historic characteristics of the district, including that all exterior construction, restoration, alteration or demolition within the district is subject to the provisions of the Historic Preservation Ordinance.

Property Development Standards

Except as hereinafter provided, no building or structure or part thereof shall be erected, altered or converted for any use permitted in this district unless it is in conformity with all of the development standards and regulations specified in the underlying zoning district, the Historic Preservation Ordinance, and the Historic Design Guidelines/Standards. The following standards shall apply except in cases where a lot does not meet the standards herein required but was an official "lot of record" prior to the adoption of this ordinance. In such cases, the present dimension shall be maintained as a minimum standard until such time as the use is removed. The replacement shall meet the standards and regulations herein specified.

Lot Area - The minimum lot area shall be as provided in any underlying zone or as may be required upon approval of a Conditional Use Permit.

Lot Dimensions - Shall be as provided in any underlying zone, or as may be required upon approval of a Conditional Use Permit.

Yards - Each lot shall have front, side and rear yards extending across the full widths and lengths of the lot as may be required in the underlying zone, or as may be required upon approval of a Conditional Use Permit.

Height Regulations - Section 7.500.

Fences, Walls and Visibility - Section 7.530.

Parking - Section 7.800.

Temporary/Accessory Building Regulations - Section 8.000.

Historic Preservation Ordinance

Signs - Sign Ordinance

Sec. 3.510. - HSD: HISTORIC SHOPPING DISTRICT OVERLAY.

Intent.

This zone is intended to encompass that portion of the City which constitutes the in-town historic shopping and tourist area. The area within the District is subject to the requirements of the underlying zoning district, the Historic Overlay District, if within its defined area, and the requirements of this Historic Shopping District.

Principal Permitted Uses

See uses listed in the underlying district.

Uses Permitted Subject to issuance of a Conditional Use Permit using the review and evaluation criteria of Section 5.460. See the uses listed for the underlying district.

Uses Permitted Subject to issuance of a Conditional Use Permit using review and evaluation criteria in Sections 5.460 and 5.461. Any Standardized Business may be located in the Historic Shopping District subject to a Conditional Use Permit as provided in Section 5.400 using the review and evaluation criteria set forth in Sections 5.460 and 5.461.

For the purpose of this section, the following definitions shall apply:

- A. Historic Shopping District shall be all properties generally located between Elk Street and Acorn Street including the properties fronting on both sides of Acorn Street, and between San Antonio Street including the properties fronting on both sides of such street, and Austin Street including the properties fronting on both sides of such street, as they are depicted on the map of the area attached to this ordinance.
- B. Standardized Business shall mean a business which is required by contractual or other arrangement or affiliation to maintain one or more of the following items: standardized ("formula") array of services and/or merchandise, trademark, logo, signs, service mark, symbol, decor, architecture, layout, uniform, menu, or similar standardized features and which causes it to be substantially identical to more than ten other businesses regardless of ownership or location at the time the application therefor is completed. Standardized Businesses can include, but are not limited to: restaurants, retail stores, banks, sales offices, spas, hair and nail salons, art galleries, and hotel/motel/inn/short-term rental establishments. A statement made under oath, and subject to penalties for perjury concerning the status as a standardized business shall be submitted with the application for Conditional use permit, along with any other reasonable proof required by the person administering the City's Zoning ordinance.

Property Development Standards.

Except as hereinafter provided, no building or structure or part thereof shall be erected, altered or converted for any use permitted in this district unless it is in conformity with all the standards and regulations herein specified for lot area, lot width, lot depth, dwelling unit area, lot coverage, yards and building height. The following standards shall apply except in cases where a lot does not meet the standards herein required but was an official "lot of record" prior to the adoption of this ordinance. In such cases, the present dimension shall be maintained as a minimum standard until such time as the use is removed. The replacement shall meet the standards and regulations herein specified.

- [A.] Lot Area - The minimum lot area shall be as provided in any underlying zone or as may be required upon approval of a Conditional Use Permit.
- B. Lot Dimensions - Shall be as provided in any underlying zone, or as may be required upon approval of a Conditional Use Permit.
- C. Yards - Each lot shall have front, side and rear yards extending across the full widths and lengths of the lot as may be required in the underlying zone, or as may be required upon approval of a Conditional Use Permit.
- D. Height Regulations - Shall be as provided in the underlying zoning District.
- E. Fences, Walls and Visibility - Section 7.530.
- F. Parking - The standards of Section 7.800 shall apply.
- G. Temporary/Accessory Building Regulations - Section 8.000.
- H. Historic Preservation Ordinance.
- I. Signs - Sign Ordinance.

(Ord. No. 18-002, § 3.510, 4-21-2008; Ord. No. 19-005, § 3.510, 4-20-2009; Ord. No. 23-014, 9-16-2013; Ord. No. 2022-13, § 10(Exh. J), 3-21-2022; Ord. No. 2023-18, § 8H, 11-7-2023)

Gillespie CAD Property Search

2025 values are now certified!

Property ID: 26758 For Year 2025

Property Details

Account		
Property ID:	26758	Geographic ID: S0010-0140-037500
Type:	R	Zoning: R2
Property Use:		Condo:
Location		
Situs Address:	505 W SAN ANTONIO ST TX	
Map ID:	10	Mapsco:
Legal Description:	FBG ADDN BLK 14 LOT 375, -50% INT IN HS-	
Abstract/Subdivision:	S0010	
Neighborhood:	(FCCW) CITY CENTRAL WEST	
Owner		
Owner ID:	221246	
Name:	STAUDT, SALLY M ETAL	
Agent:		
Mailing Address:	505 W SAN ANTONIO ST FREDERICKSBURG, TX 78624	
% Ownership:	100.0%	
Exemptions:	HS - For privacy reasons not all exemptions are shown online.	

Property Values

Improvement Homesite Value:	\$584,500 (+)
Improvement Non-Homesite Value:	\$0 (+)
Land Homesite Value:	\$322,000 (+)
Land Non-Homesite Value:	\$0 (+)

Agricultural Market Valuation:	\$0 (+)
Market Value:	\$906,500 (=)
Agricultural Value Loss: ⓘ	\$0 (-)
Appraised Value: ⓘ	\$906,500 (=)
HS Cap Loss: ⓘ	\$122,779 (-)
Circuit Breaker: ⓘ	\$0 (-)
Assessed Value:	\$783,721
Ag Use Value:	\$0

2025 values are now certified!

Information provided for research purposes only, for current ownership research you are able to change the search year to 2026. Legal descriptions and acreage amounts are for Appraisal District use only and should be verified prior to using for legal purpose and or documents. Please contact the Appraisal District to verify all information for accuracy.

Property Taxing Jurisdiction

Owner: STAUDT, SALLY M ETAL

Entity	Description	Market Value	Taxable Value	Estimated Tax	Freeze Ceiling
CFB	CITY OF FREDBG	\$906,500	\$783,721	\$1,782.39	\$949.66
G086	GILLESPIE COUNTY	\$906,500	\$783,721	\$2,104.29	\$1,683.38
HUW	HILL CNTRY UWCD	\$906,500	\$783,721	\$38.40	
SFB	FREDBG ISD	\$906,500	\$683,721	\$5,285.85	\$2,099.63
WCD	GILLESPIE WCID	\$906,500	\$783,721	\$1.40	
CAD	GILLESPIE CENTRAL APPRAISAL DISTRICT	\$906,500	\$783,721	\$0.00	

Total Tax Rate: 1.274105

Estimated Taxes With Exemptions: \$4,772.47

Estimated Taxes Without Exemptions: \$11,549.76

Property Improvement - Building

Description: RESIDENTIAL **Type:** RESIDENTIAL **Living Area:** 2567.0 sqft **Value:** \$584,500

Type	Description	Class CD	Year Built	SQFT
MA	MAIN AREA	C5	1907	1730
MA2	MAIN AREA 2ND STORY	C5	2014	357
MA3	MAIN AREA HALF STORY	C5	0	480
UTL	UTILITY ROOM	C5	2015	16
SP	SCREENED PORCH	C5	2014	160
OP	OPEN PORCH	C5	0	232
WD	WOOD DECK	C5	2014	32
OP	OPEN PORCH	C5	0	24
PO	PATIO	C5	2015	255
STGG	STORAGE GOOD	*	2012	200
STGL	STORAGE LOW	*	0	442
PC	PATIO COVER	*	0	182

Property Land

Type	Description	Acreage	Sqft	Eff Front	Eff Depth	Market Value	Prod. Value
UI	URBAN INTERIOR	0.46	20,000.00	100.00	200.00	\$322,000	\$0

Property Roll Value History

Year	Improvements	Land Market	Ag Valuation	Appraised	HS Cap Loss	Assessed
2025	\$584,500	\$322,000	\$0	\$906,500	\$122,779	\$783,721
2024	\$553,200	\$318,000	\$0	\$871,200	\$158,726	\$712,474
2023	\$553,200	\$318,000	\$0	\$871,200	\$223,496	\$647,704
2022	\$501,730	\$224,000	\$0	\$725,730	\$136,908	\$588,822
2021	\$459,950	\$166,000	\$0	\$625,950	\$90,657	\$535,293
2020	\$368,830	\$117,800	\$0	\$486,630	\$0	\$486,630
2019	\$368,830	\$117,800	\$0	\$486,630	\$0	\$486,630
2018	\$342,920	\$107,400	\$0	\$450,320	\$0	\$450,320
2017	\$313,550	\$107,400	\$0	\$420,950	\$0	\$420,950