

# THE BOWERY AVAILABLE NOW

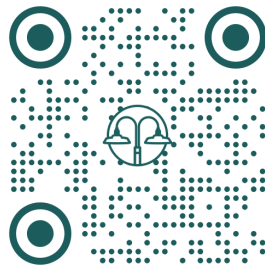

MOURNING DOVE LANE, OPELIKA, AL 36801

LOTS FROM \$403,003



The Bowery, a 120-acre development off Lee County Road 171 and Oak Bowery Road in Opelika, features 13 stunning 7.5-10.5 acre lots with pastures, pines, and hardwoods. Adjacent to the Robert Trent Jones Golf Course, it offers a single cul-de-sac entrance with easy access to Auburn and Opelika. Custom homes will enjoy City of Opelika Water, Tallapoosa Electric, and Point Broadband, with schools including Opelika City Schools, Lee-Scott Academy, and Trinity Christian School.

*for more information, call:*  
Mailon Reese  
334.750.2846



THREE SIXTY  
REAL ESTATE

# THE BOWERY



Lot 8



Lot 10



Lot 11



Lot 12



Lot 13

*for more information, call:*  
Mailon Reese  
334.750.2846

# THE BOWERY

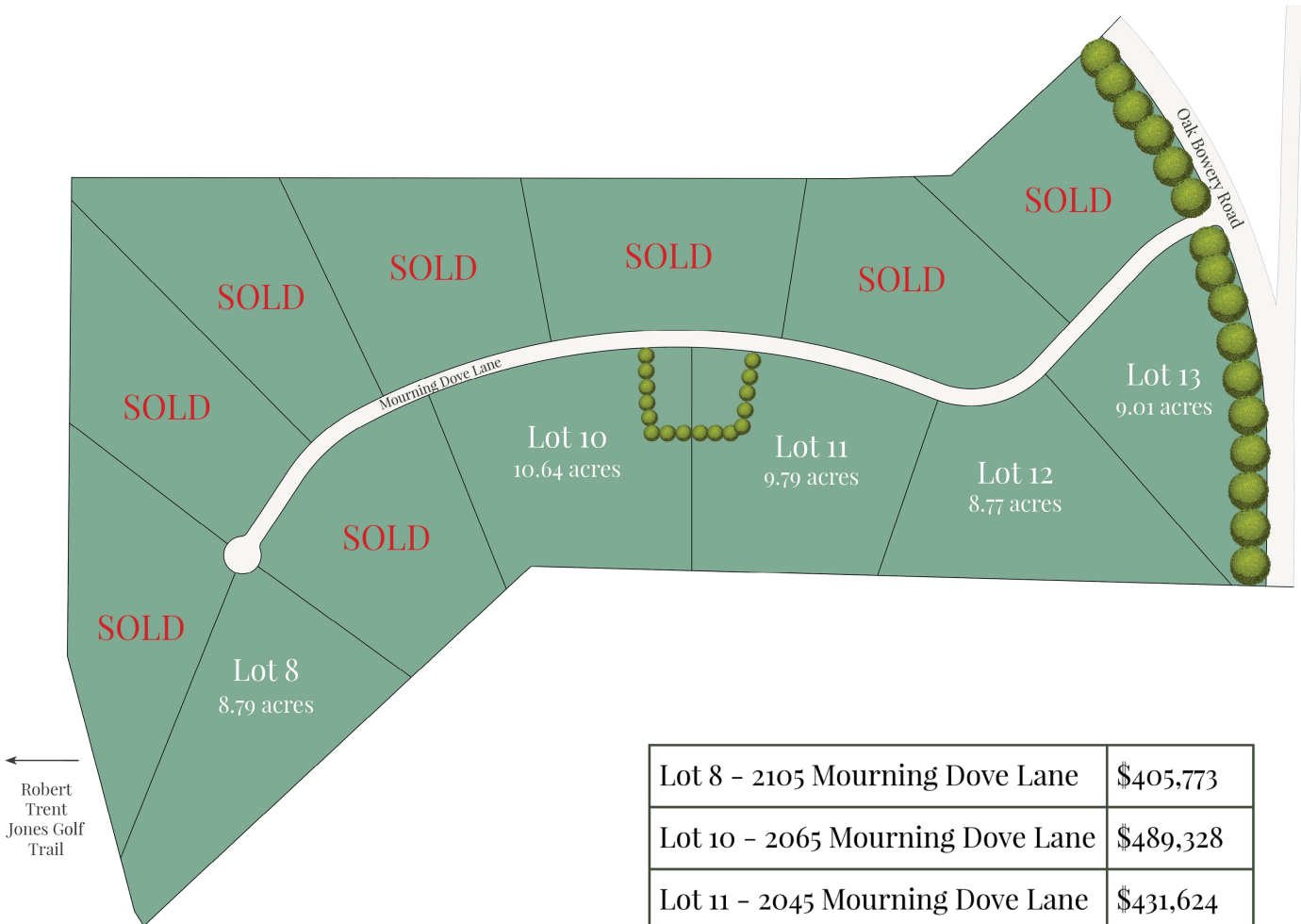

Lot 8 - 2105 Mourning Dove Lane	\$405,773
Lot 10 - 2065 Mourning Dove Lane	\$489,328
Lot 11 - 2045 Mourning Dove Lane	\$431,624
Lot 12 - 2025 Mourning Dove Lane	\$403,003
Lot 13 - 2005 Mourning Dove Lane	\$415,929

Scan to learn more!



for more information, call:  
Mailon Reese  
334.750.2846



THREE SIXTY  
REAL ESTATE

# THE BOWERY

Proposed Construction by

## DILWORTH

RESIDENTIAL | COMMERCIAL | DEVELOPMENT

Dilworth, an established builder throughout southeast Alabama, has two proposed construction homes in The Bowery! With a heritage of first-class construction values and distinctive designs, Dilworth has been serving East Alabama since 1999. Founded by Michael Dilworth, this company is renowned for its comprehensive project organization, commitment to craft, exceptional client service, and creative design capability. If you are interested in using Dilworth to build your dream home in The Bowery, Contact Debbie Whitley - 334.740.0140 - with Dilworth Development for more info.



\$1,559,385



\$1,803,933

*for more information, call:*  
Mailon Reese  
334.750.2846



THREE SIXTY  
REAL ESTATE

# THE BOWERY

## Area Map

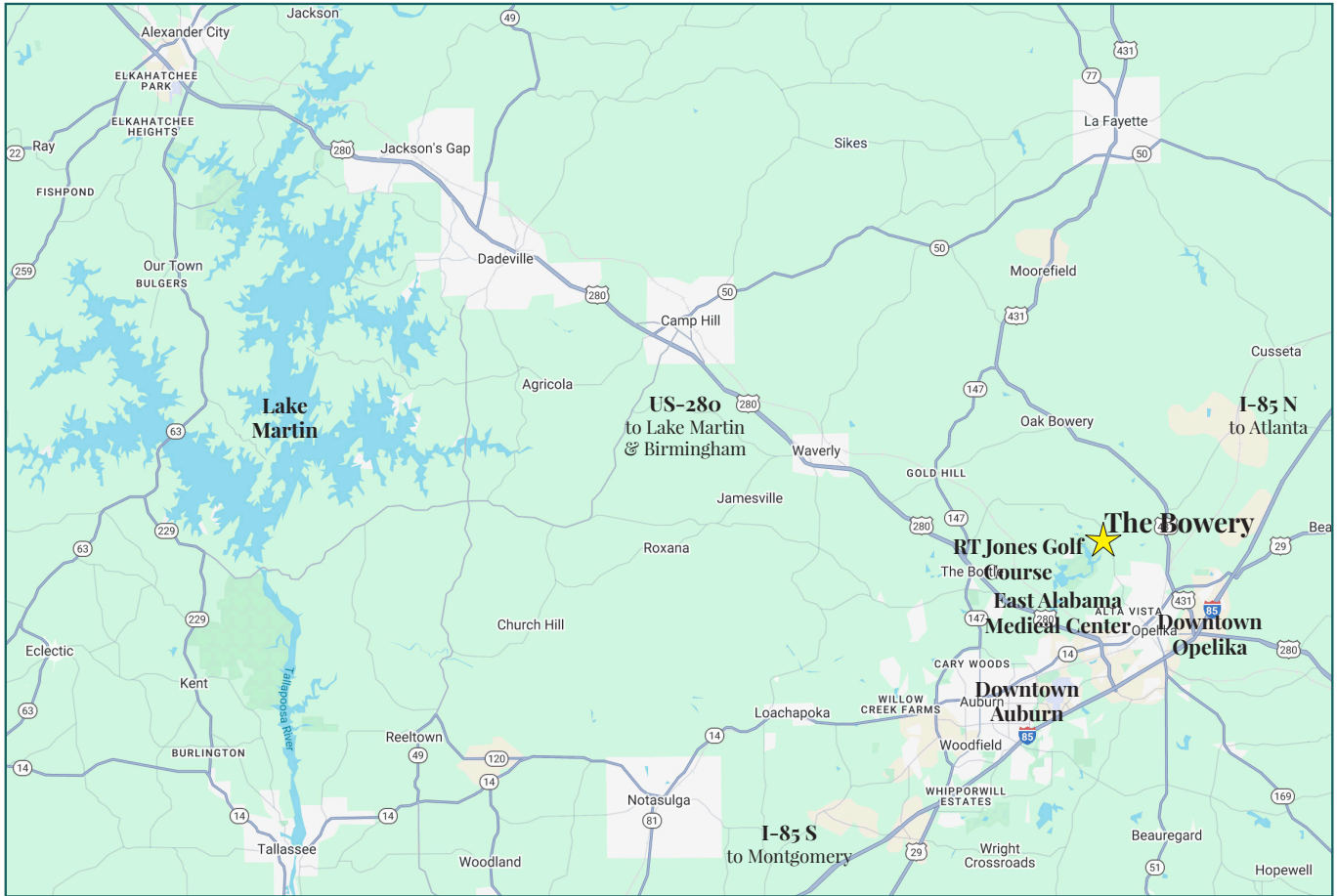

The Bowery is in a great location! One-half mile from the secondary entrance to RTJ, 5 minutes from Highway 280, 5 minutes to downtown Opelika, 10 minutes to Tigertown, 15 minutes to downtown Auburn and 55 minutes to Lake Martin.



Nonet Reese  
334.275.0615



Mailon Reese  
334.750.2846



THREE SIXTY

REAL ESTATE

334.887.3601

[www.concepttoclosing.com](http://www.concepttoclosing.com)