



RAWSPACE

34 Little West 12th Street | Brand Activation





34 Little West 12th Street | Venue Description

34 Little West 12th Street is located on the most charming street in the Meatpacking District. One block away from the Highline and the Whitney Museum of American Art, this venue sits on a cobblestone street and is nestled among top restaurants and retailers. The appealing frontage is 27' 8", features floor to ceiling glass windows and is crowned with an iconic metal canopy. The interior offers details authentic to the neighborhood, including rustic hardwood floors, exposed brick, subway tiles, and art deco lighting. The space currently has six individual cabin dressing rooms and one client facing, ADA compliant restroom on the main level. There are two sizable rooms behind the dressing rooms that can be used for catering or various production needs. Additionally, the lower level is available for catering or storage should the upper rooms be used for separate activations.



34 Little West 12th Street | Venue Specifications

VENUE MANAGEMENT BY RAWSPACE GROUP | PAGE 3/8

ADDRESS	34 Little West 12 th Street, New York, NY 10014
PEDESTRIAN TRAFFIC	One block from the High Line and the Whitney Museum of American Art
NEIGHBORS	Major attractions, hotels, restaurants, and retail
SQUARE FOOTAGES	Storefront: 3,215 sq ft, Lower Level Basement: 850 sq ft, Total: 4,065 sq ft
CEILING HEIGHTS	Storefront Ceiling: 12'
FRONTAGE	Frontage is 27.8' with floor to ceiling glass windows and an iconic Meatpacking District metal canopy
SPRINKLERS	Venue has a sprinkler system throughout as well as emergency lighting
POWER	200 amps
LIGHTING	Venue has a mix of suspended art deco lighting and track lighting in the storefront windows
SOUND	Music volume maintained at 90 dB within space; DJs are allowed for optics, however subwoofers are not
RESTROOMS	There is one client facing restroom in the main space that is ADA compliant
INTERNET	Mifis available for administrative purposes
FLOORS	Floors can be carpeted. Paper tape is the only adhesive allowed to come in direct contact with flooring
BRICK WALL	Brick walls cannot be painted
RESTORATION FEES	Restoration fees will be charged to repair any and all damages incurred during a rental and will be automatically deducted from the security deposit. Restoration fees for patching/repairing holes in walls will be discussed in advance and based on scope of work. Please be mindful that excessive wall repairs often require the repainting of the entire wall and in extreme cases, the entire venue.
FAÇADE / BRANDING	Under no circumstances are any punctures allowed on the building's façade. All exterior branding is subject to Licensor approval. Façade measurements are included on the floor plan.



34 Little West 12th Street | Floor Plans

STOREFRONT 3,215 sq ft
LOWER LEVEL 850 sq ft

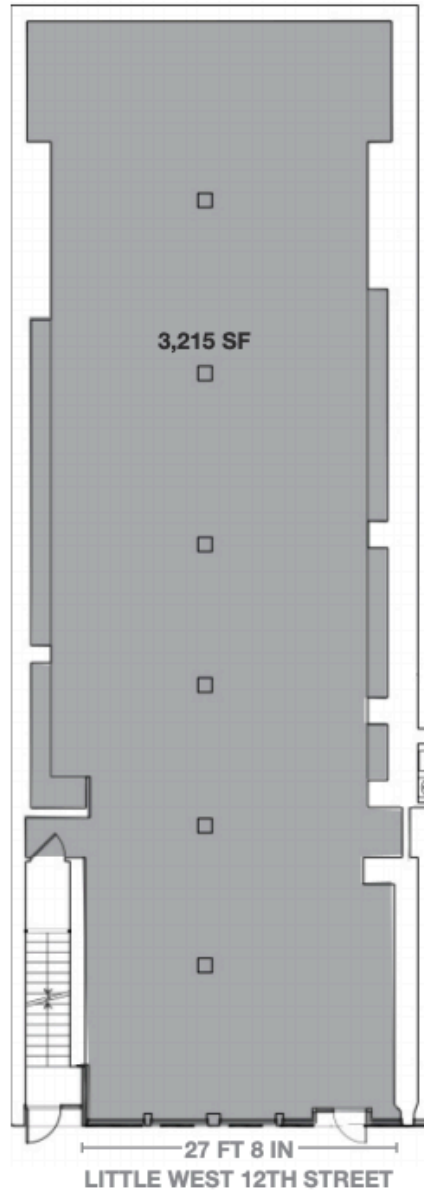

MEASUREMENTS

- Windows to Dressing Rooms: 75'
- Entrance width: 28'
- Main space width: 33'
- Ceiling height: 141"
- Ceiling height to duct: 119"
- (5) standard dressing rooms: 3' x 5' x 8'
- (1) ADA dressing room: 5' x 8' x 8'
- (1) Side closet: 1' x 8" x 5' x 8'

*East Back Room 187-1/2 x 178 x 106
 *West Back Room 141-1/8 x 187-7/8 x 104-3/4

**These rooms not shown on this floor plan and can be used for back of house needs*

34 Little West 12th Street | Column Measurements

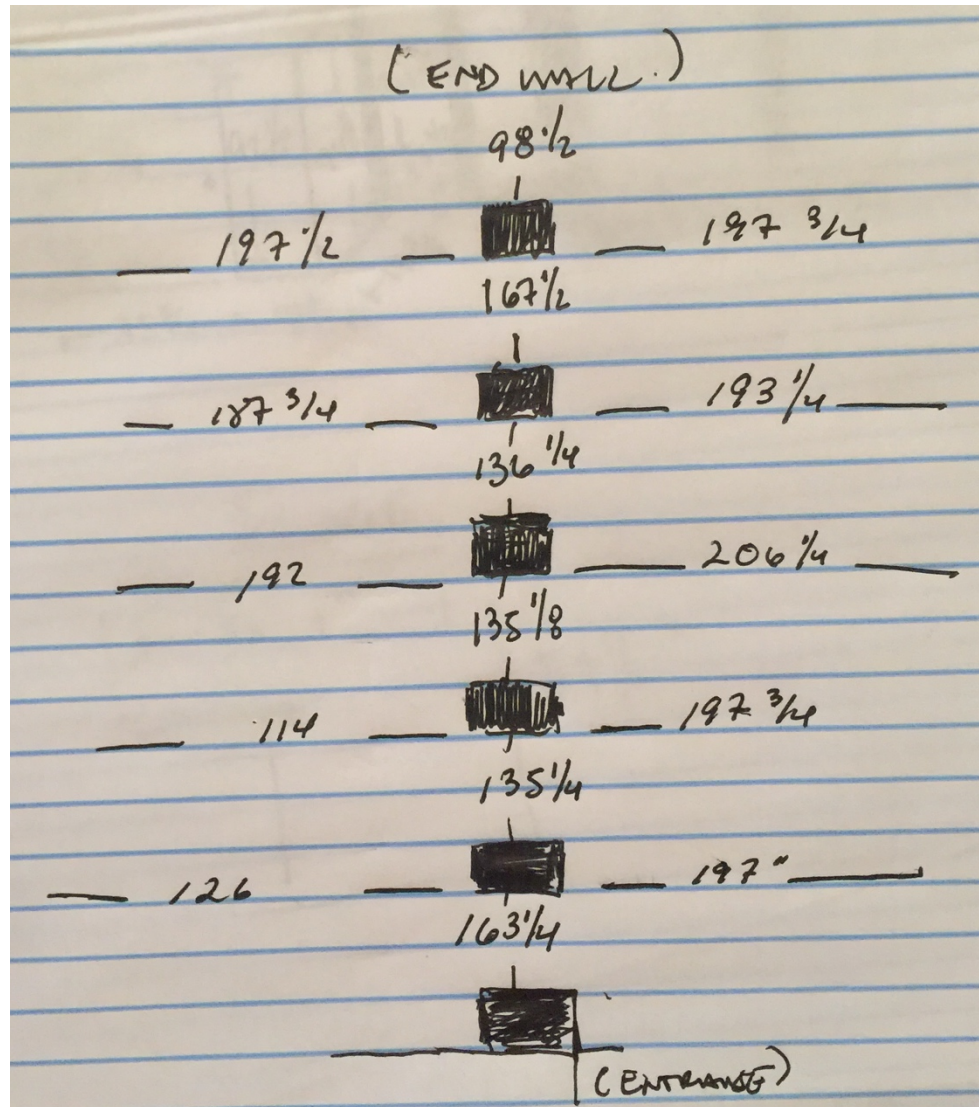



34 Little West 12th Street | Façade Measurements

*Front door opening for load in is 33' 1/8"

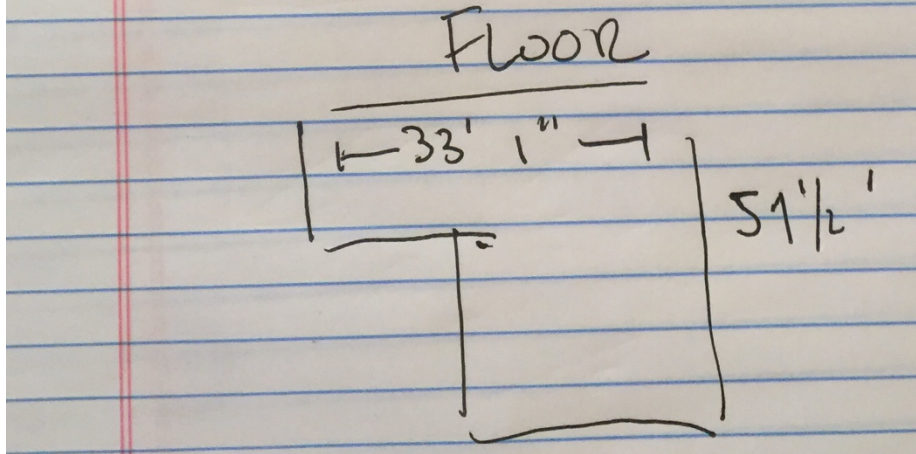
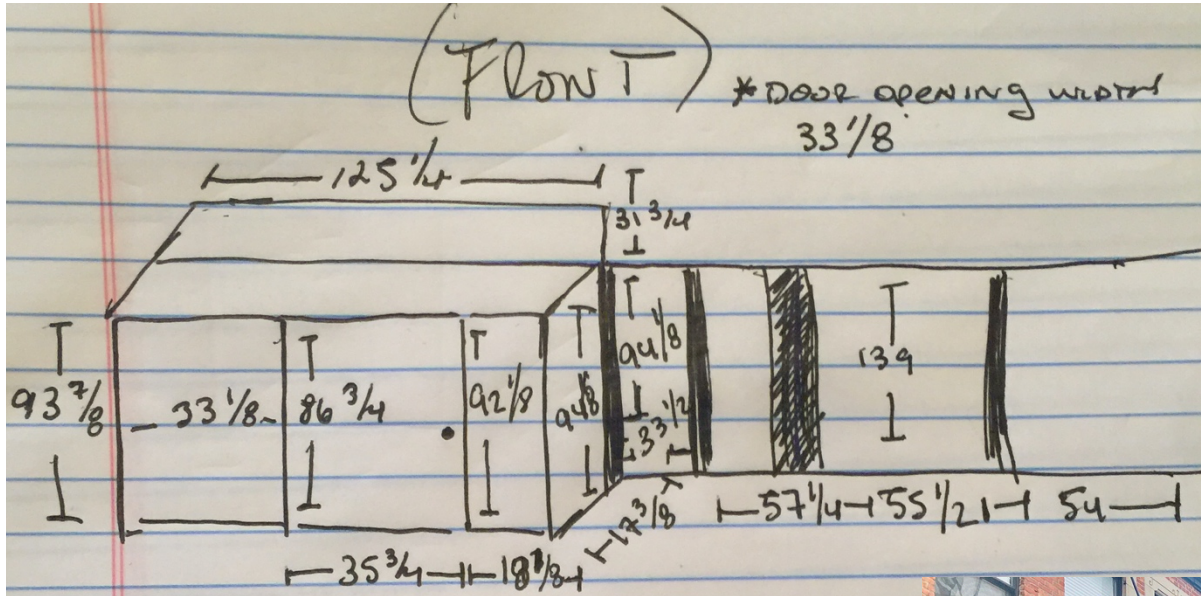

RAWSPACE

34 Little West 12th Street | Catering Area (Storefront)

VENUE MANAGEMENT BY RAWSPACE GROUP | PAGE 7/8

There are two rooms in the back of the store. This eastside room is appropriate for catering (pictured below). The slightly smaller westside room is appropriate for a production office, greenroom or storage.

