



1519 BENT HILL



4 Bedroom • 3 Bath • 2775 SF • \$1,200,000 • MLS# 202004637



LIVING & DINING

↻ Diamond Plaster Walls ↻ Corner Fireplace ↻ Gourmet Kitchen



1519 BENT HILL

4 Bedroom • 3 Bath • 2775 SF • \$1,200,000 • MLS# 202004637

Four bedroom, three bathroom custom home in The Summit offers panoramic mountain views and a sanctuary setting amidst pinon, ponderosa, and aspen trees. Thoughtful design and exceptional craftsmanship with diamond plaster walls, coved ceilings, hand-tooled beams, custom iron work, and wood and brick floors. Spacious living room with corner fireplace and access to an outdoor portal for expanded entertaining. An elegant formal dining room and a gourmet kitchen equipped with high-end appliances: Wolf range, oven and microwave, and a Sub-Zero refrigerator. Center island and tailored cabinets for extra storage. Split bedroom plan with secluded master suite. Fourth bedroom designed as a flex-space to be used as an office, library, or den. Inviting outdoor spaces, mature landscaping, and two-car garage with 2 heated areas for storage. Energy efficient home with solar panels, tankless hot water units, and new energy efficient boiler. Walking distance to Ten Thousand Waves Spa and Dale Ball Trails. This is the closest residential community to the Santa Fe Ski Basin and only minutes to the Plaza.

DARLENE STREIT | 505.920.8001 | DSTREIT@DSTREIT.COM



B E D R O O M S

↻ Split Bedroom Plan ↻ Secluded Master Suite ↻ Fourth Bedroom/Flex Space



DETAILS

- 4 Bedrooms
- Baths: 2 Full, 1 Three Quarter
- 2775 SF
- 0.448 Acre
- Built in 2006
- Wood, Brick Floors
- Frame, Stucco Construction *
- Flat, Foam Roof
- 2 Garage Spaces
- 3 Fireplaces
- Gas Cooking
- Radiant In Floor Heating
- Refrigerator, Central Cooling
- City Sewer
- City Water
- Internet: Cable, DSL, Satellite Dish, Wireless
- Insulated Windows
- Tankless Hot Water
- HOA Fees: \$850 Per Quarter
- HOA Fees Cover: Community Area & Road Maintenance, Security
- Landscaped
- Drip/Sprinkler System
- Security System
- Solar Photovoltaic

*Buyer to Verify

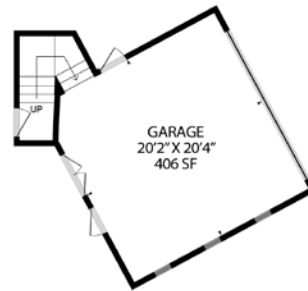

Above measurements provided by iGuide and may not be entirely accurate.

Plat depiction is for illustration purposes and may not be entirely accurate.

DARLENE STREIT

SANTA FE REAL ESTATE PROPERTY



DARLENE STREIT
 505.920.8001 • dstreit@dstreit.com
 Office: 417 E. Palace Avenue
 Santa Fe NM 87501

SantaFeRealEstateProperty.com

DarleneStreit.com

SantaFeLuxuryHomesandLand.com



View
Listing
Online

© Sotheby's International Realty, Inc. All rights reserved. Sotheby's International Realty® is a registered trademark. This material is based upon information which we consider reliable but because it has been supplied by third parties, we cannot represent that it is accurate or complete and it should not be relied upon as such. This offering is subject to errors, omissions, changes including price or withdrawal without notice. If your property is listed with a real estate broker, please disregard. It is not our intention to solicit the offerings of other real estate brokers. We are happy to work with them and cooperate fully. Operated by Sotheby's International Realty, Inc. Real estate agents affiliated with Sotheby's International Realty, Inc. are independent contractor sales associates and are not employees of Sotheby's International Realty, Inc. Equal Housing Opportunity. Sotheby's International Realty, 326 Grant Ave, Santa Fe, NM 87501, 505-988-2533.

Sotheby's
INTERNATIONAL REALTY