



465 CAMINO DE LAS ANIMAS



4 Bedroom • 3 Bath • 2,758 SF • \$1,595,000 • MLS# 202005244



MAIN HOUSE

⇨ Curved Doorways ⇨ Kiva Fireplace ⇨ Exposed Wood Vigas



465 CAMINO DE LAS ANIMAS

4 Bedroom • 3 Bath • 2,758 SF • \$1,595,000 • MLS# 202005244

Unique opportunity to own this 4 bedroom 3 bath Pueblo Revival style home plus casita in the heart of Santa Fe's Historic East Side. The main residence was designed in the 1930's by the famed Pueblo Revival style architect John Gaw Meem for the modernist painter Raymond Jonson. Classically designed with curved doorways, exposed wood vigas, portal, and deeply set bay windows to amplify light and the circulation of air. Entertain in style in the large great room and adjacent cafe bar with seating for four. In addition to the great room, there is a separate open concept living/dining area with a kiva. The north-facing studio space still speaks to Jonson's intent to have a world-class studio space inside the home. With an ensuite bath, this room can easily double as a bedroom. There is a private shared well to irrigate the greenhouse, established fruit trees, and gardens. Multiple patios provide space for al fresco dining and relaxing under the signature Santa Fe skies. Centrally located close to Kaune's, the Roundhouse, Museum Hill, and Canyon Road.

DARLENE STREIT | 505.920.8001 | DSTREIT@DSTREIT.COM



GUEST HOUSE

↪ Greenhouse ↪ Multiple Patios



DETAILS

- 4 Bedrooms
- Baths: 2 Full, 1 Three Quarter
- Main House 2287 SF
Guest House 471 SF
- 0.788 Acres
- Wood, Tile Floors
- Adobe and possibly other materials, Frame, Pentile, Stucco Construction *
- Flat, Tar & Gravel Roof
- 4 Off Street Parking Spaces
- 2 Fireplaces
- Gas Cooking
- Electric, Gas, Baseboard, Radiant In Floor, Radiant Heating
- Refrigerator, Evaporative Central, Cooling
- City Sewer
- City Water, Shared Well
- Internet: Cable, DSL, Satellite Dish
- Cafe Bar
- Landscaped
- Security System / Gated
- Drip/Sprinkler System

*Buyer to Verify

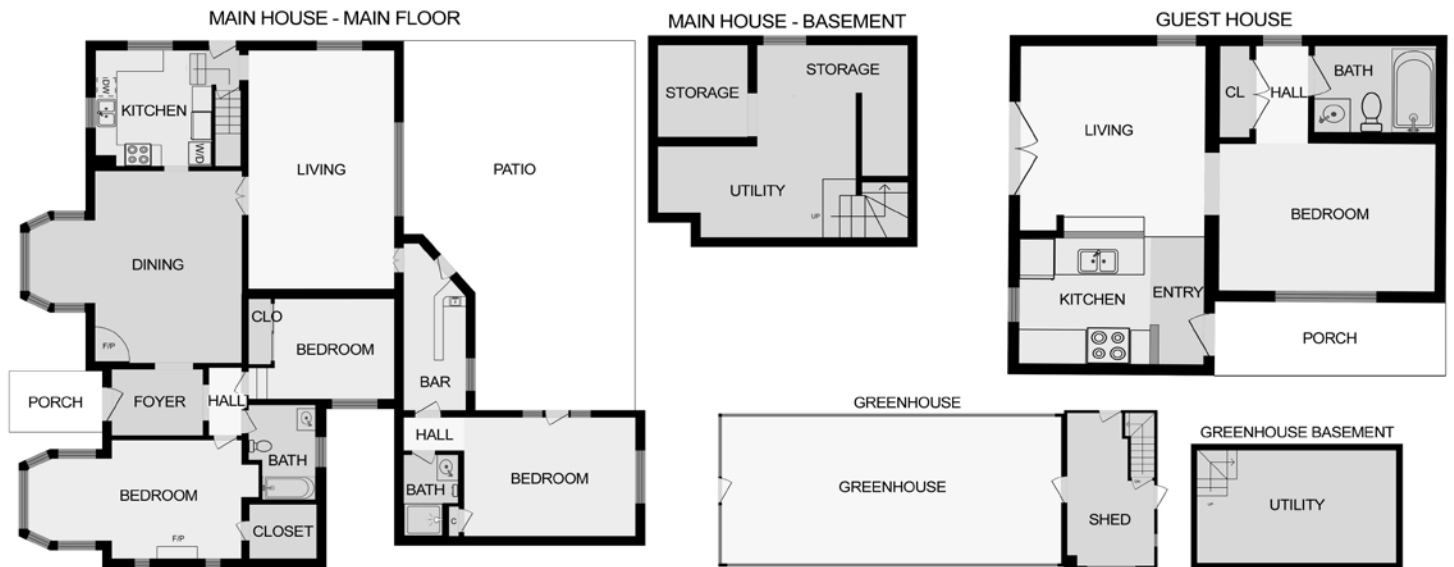

Above floor plan provided by iGuide and may not be entirely accurate.

Plat depiction is for illustration purposes and may not be entirely accurate.

DARLENE STREIT

SANTA FE REAL ESTATE PROPERTY



DARLENE STREIT
 505.920.8001 • dstreit@dstreit.com
 Office: 417 E. Palace Avenue
 Santa Fe NM 87501

SantaFeRealEstateProperty.com
 DarleneStreit.com
 SantaFeLuxuryHomesandLand.com



View
Listing
Online

© Sotheby's International Realty, Inc. All rights reserved. Sotheby's International Realty® is a registered trademark. This material is based upon information which we consider reliable but because it has been supplied by third parties, we cannot represent that it is accurate or complete and it should not be relied upon as such. This offering is subject to errors, omissions, changes including price or withdrawal without notice. If your property is listed with a real estate broker, please disregard. It is not our intention to solicit the offerings of other real estate brokers. We are happy to work with them and cooperate fully. Operated by Sotheby's International Realty, Inc. Real estate agents affiliated with Sotheby's International Realty, Inc. are independent contractor sales associates and are not employees of Sotheby's International Realty, Inc. Equal Housing Opportunity. Sotheby's International Realty, 326 Grant Ave, Santa Fe, NM 87501, 505-988-2533.

Sotheby's
INTERNATIONAL REALTY