



71 CAMINO PACIFICO



3 Bedroom • 3.5 Bath • 3,000 SF • \$1,650,000 • MLS# 202104202



LIVING & DINING

↻ Limestone Floors ↻ Formal Dining Room ↻ Gourmet Kitchen



71 CAMINO PACIFICO

3 Bedroom • 3.5 Bath • 3,000 SF • \$1,650,000 • MLS# 202104202

Unique, no steps, single level 3 bedroom 3.5 bath custom-designed home on panoramic ridgetop location with fantastic, 100-mile views of the Sandia, Jemez, Ortiz, Sangre De Cristo mountains and night time Santa Fe city lights. High-end appointments and finishes throughout, including limestone floors, plaster walls, custom beams & vigas, cove ceilings in bedrooms and kitchen, granite and marble countertops, full house sound system, 5 fireplaces (1 on portal) with log-lighters and custom-made flagstone hearths/mantles/sills. Spacious great room with built-in cabinets and lighted nichos with glass shelving for art. Formal dining room with access to outside patio. Impressive gourmet kitchen appointed with custom cabinets, Thermador French door refrigerator, 4 burner stove plus grill, warming drawer, Sub-Zero wine chiller, and large center island. Oenophiles will enjoy the fabulous 750 bottle temperature and humidity-controlled wine cellar. Sumptuous master suite with fireplace, sitting area, access to outdoor patio, and walk-in shower with heated shower walls, soaking tub and custom sauna. Oversized 2-car attached garage with workshop. Oversized 3-car detached garage including tall RV bay. The fenced front courtyard and huge back portal with built-in Vermont Castings barbeque and Coleman spa. Super-insulated home won Green Building Award in 2009 Santa Fe Haciendas-A Parade of Homes. HERS rating 60. Private rural setting on 5 acres but convenient to town and located on paved roads.

DARLENE STREIT | 505.920.8001 | DSTREIT@DSTREIT.COM



B E D R O O M S

↻ Master Suite ↻ Custom Sauna ↻ Soaking Tub



DETAILS

- 3 Bedrooms
- Baths: 2 Full, 1 Three Quarter, 1 Half
- 3000 SF
- 5 Acres
- Built in 2009
- Frame, Stucco Construction *
- Flat, Membrane Commercial Grade EPDM Roof
- 5 Garage Spaces
- 5 Fireplaces
- Gas Cooking
- Propane, Radiant In Floor Heating

- Evaporative, Central Cooling
- Septic
- Community Water
- Internet: Cable
- Portal w/ Kitchen & Kiva Fireplace
- Sauna
- Hot Tub
- Andersen Eagle Aluminum Clad Wood Windows
- RV Parking Available
- Xeriscaped/Landscaped
- Drip/Sprinkler System

- Water Filter
 - Security System
 - Wine Cellar
 - Greywater System
 - Rainwater Harvesting
 - Recirc Pump for Hot Water
 - Whole House Air Ventilation System
 - HERS Rated
 - EnergyStar Appliances
- *Buyer to Verify

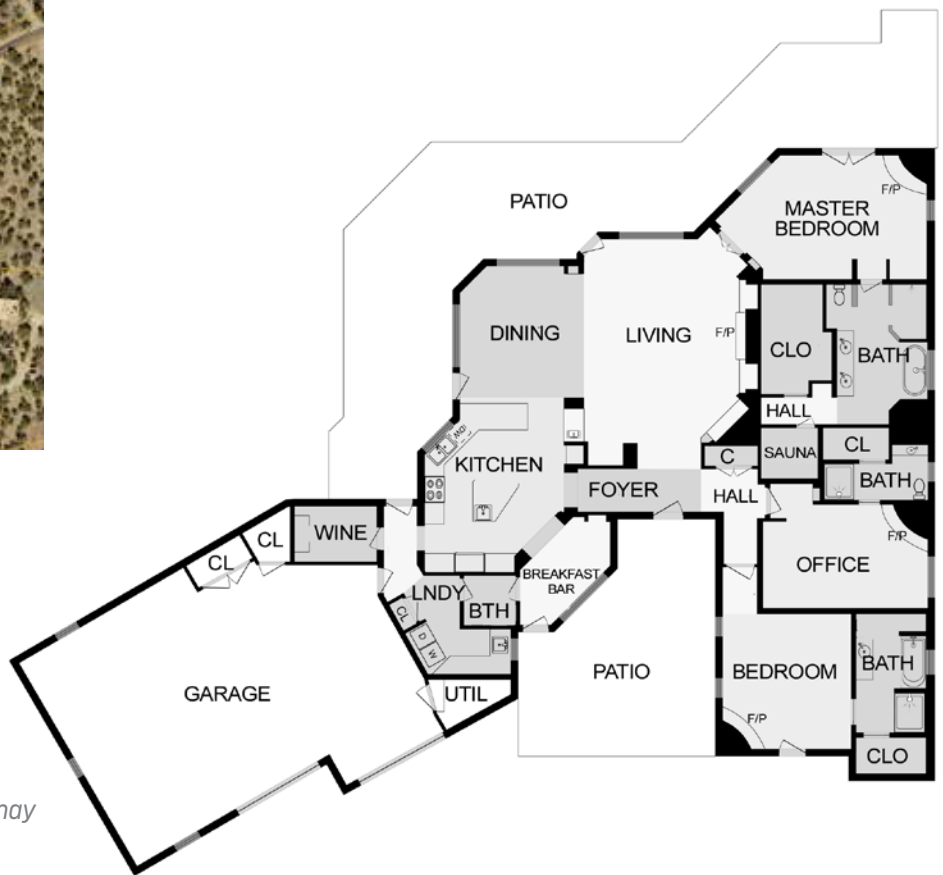

Above floor plan provided by iGuide and may not be entirely accurate.

Plat depiction is for illustration purposes and may not be entirely accurate.

DARLENE STREIT

SANTA FE REAL ESTATE PROPERTY



DARLENE STREIT
 505.920.8001 • dstreit@dstreit.com
 Office: 417 E. Palace Avenue
 Santa Fe NM 87501

SantaFeRealEstateProperty.com

DarleneStreit.com

SantaFeLuxuryHomesandLand.com



View
Listing
Online

© Sotheby's International Realty, Inc. All rights reserved. Sotheby's International Realty® is a registered trademark. This material is based upon information which we consider reliable but because it has been supplied by third parties, we cannot represent that it is accurate or complete and it should not be relied upon as such. This offering is subject to errors, omissions, changes including price or withdrawal without notice. If your property is listed with a real estate broker, please disregard. It is not our intention to solicit the offerings of other real estate brokers. We are happy to work with them and cooperate fully. Operated by Sotheby's International Realty, Inc. Real estate agents affiliated with Sotheby's International Realty, Inc. are independent contractor sales associates and are not employees of Sotheby's International Realty, Inc. Equal Housing Opportunity. Sotheby's International Realty, 326 Grant Ave, Santa Fe, NM 87501, 505-988-2533.

Sotheby's
INTERNATIONAL REALTY