



7757C OLD SANTA FE TRAIL



In Canada de Los Alamos



LIVING & DINING

↻ Dining Room Deck ↻ Eastern Mountain Views ↻ Farmhouse Kitchen

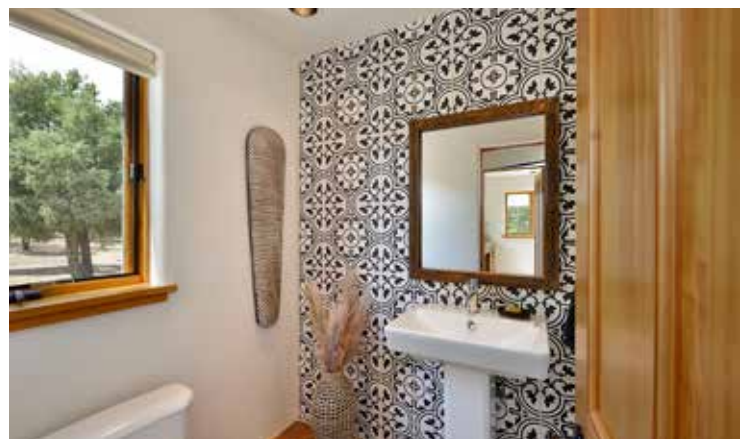

7757C OLD SANTA FE TRAIL

4 Bedroom • 3 1/2 Bath • 3032 SF • \$995,000 • MLS# 202003767

Recently remodeled 4 bedroom 3.5 bath home on 4.4+ acres in the foothills of Canada de Los Alamos directly adjacent to the Santa Fe National Forest. Striking architectural features abound with clerestory windows, nichos, coves, curved doorways and decorative tiles. The spacious living room has been strategically designed to capture sweeping eastern mountain views. Stylish farmhouse kitchen is appointed with high end appliances, brick walls and a wood table/island. Dining room opens to an exterior deck expanding space for entertaining. Master suite, located on the main living level, has access to a patio and a spa-like bath with double vanities, walk-in shower and soaking tub. Next to the Master suite is an office/studio. This home offers maximum privacy for guests and flexibility with a guest suite downstairs as well as an additional private entry two guest bedroom suite (with kitchenette) down. Wood and Casa Vita Bella cement tile floors throughout. In addition to being on-grid, the home is solar-powered and also features rainwater harvesting and xeriscaping. 2 car attached garage plus 6 off-street parking spots. Tastefully landscaped amidst forested hills. Close to nearby parks and natural areas such as Shaggy Peak yet only minutes away from all the cultural and culinary amenities of Santa Fe.

DARLENE STREIT | 505.920.8001 | DSTREIT@DSTREIT.COM



B E D R O O M S

⇨ Guest Suite ⇨ Master Suite ⇨ Office/Studio



DETAILS

- 4 Bedrooms
- Baths: 2 Full, 1 Three Quarter, 1 Half
- 3032 SF
- 4.40 Acres
- Built in 1998
- Frame, Stucco Construction *
- Flat, Foam Roof
- 2 Garage Spaces
- 1 Fireplace
- Gas Cooking
- Radiant In Floor Heating
- Septic
- Private Well
- Internet: Wireless
- Insulated Windows
- Landscaped
- Drip/Sprinkler System
- Security System
- Water Purification & Softener
- Passive Solar Design
- Solar Photovoltaic
- Solar Therm

*Buyer to Verify

7757C OLD SANTA FE TRAIL - FLOOR PLAN

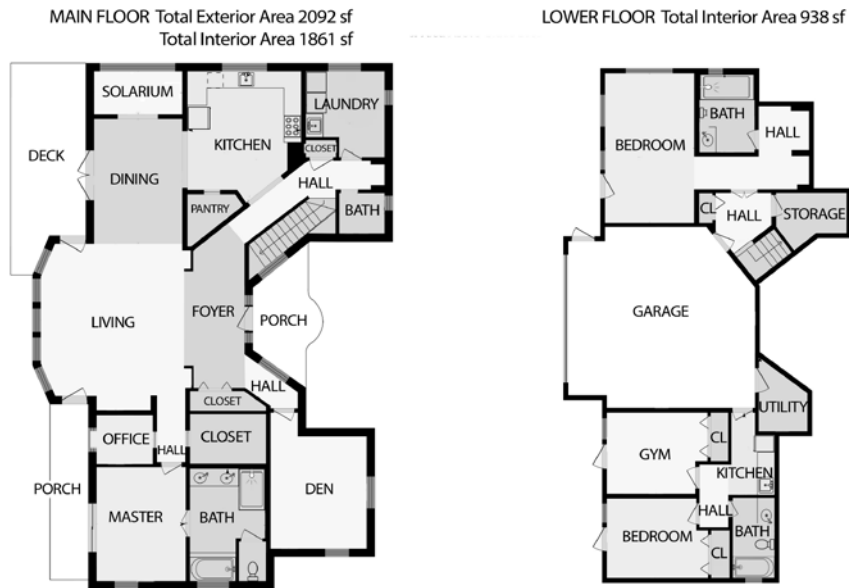

Above measurements provided by iGuide and may not be entirely accurate.

Plat depiction is for illustration purposes and may not be entirely accurate.

DARLENE STREIT

SANTA FE REAL ESTATE PROPERTY



DARLENE STREIT

505.920.8001 • dstreit@dstreit.com

Office: 417 E. Palace Avenue

Santa Fe NM 87501

SantaFeRealEstateProperty.com

DarleneStreit.com

SantaFeLuxuryHomesandLand.com



View
Listing
Online

© Sotheby's International Realty, Inc. All rights reserved. Sotheby's International Realty® is a registered trademark. This material is based upon information which we consider reliable but because it has been supplied by third parties, we cannot represent that it is accurate or complete and it should not be relied upon as such. This offering is subject to errors, omissions, changes including price or withdrawal without notice. If your property is listed with a real estate broker, please disregard. It is not our intention to solicit the offerings of other real estate brokers. We are happy to work with them and cooperate fully. Operated by Sotheby's International Realty, Inc. Real estate agents affiliated with Sotheby's International Realty, Inc. are independent contractor sales associates and are not employees of Sotheby's International Realty, Inc. Equal Housing Opportunity. Sotheby's International Realty, 326 Grant Ave, Santa Fe, NM 87501, 505-988-2533.

Sotheby's
INTERNATIONAL REALTY