

FRICKE, JARED A
 FRICKE, KELLY C
 438 PALMETTO RDG
 SYLVA, NC 28779
 ACCOUNT NUMBER: 181038

Jackson County, North Carolina

Tax Districts
 General County Tax

Parcel: 7529713398
 Tax Year: 2025
 Reval Year: 2025
 Appraised By: LKF on 04/15/2024
 Information Source: E - E

PARCEL INFORMATION	PROPERTY DESCRIPTION	VALUE SUMMARY																				
Address: 438 PALMETTO RDG Neighborhood: 23012 - Savannah Meadows Road Type: RG - Gravel Private Township: 23 - SAVANNAH Utilities: W-1, S-1 View: LR - Long Range	LT 12 SAVANNAH MEADOWS 1.9400 AC <table border="1" style="width: 100%; border-collapse: collapse; margin-top: 5px;"> <thead> <tr style="background-color: #e1eef6;"> <th colspan="4" style="text-align: center;">PERMIT INFORMATION</th> </tr> <tr style="background-color: #e1eef6;"> <th style="width: 10%;">Code</th> <th style="width: 15%;">Date</th> <th style="width: 35%;">Permit #</th> <th style="width: 40%;">Amount</th> </tr> </thead> <tbody> <tr><td> </td><td> </td><td> </td><td> </td></tr> <tr><td> </td><td> </td><td> </td><td> </td></tr> <tr><td> </td><td> </td><td> </td><td> </td></tr> </tbody> </table>	PERMIT INFORMATION				Code	Date	Permit #	Amount													LAND: 64,020 BUILDING: 306,320 OBXF: 2,100 MARKET VALUE: 372,440 DEFERRED AMOUNT: 0 EXEMPT VALUE: 0 NET TAXABLE: 372,440
PERMIT INFORMATION																						
Code	Date	Permit #	Amount																			
NOTES	SALES INFORMATION																					
	<table border="1" style="width: 100%; border-collapse: collapse;"> <thead> <tr style="background-color: #e1eef6;"> <th style="width: 15%;">Date</th> <th style="width: 20%;">Sales Price</th> <th style="width: 15%;">Valid</th> <th style="width: 50%;">Book/Page</th> </tr> </thead> <tbody> <tr> <td>6/5/2018</td> <td>210,000</td> <td>IR</td> <td>2215/701</td> </tr> <tr> <td>9/18/2001</td> <td>18,000</td> <td>N</td> <td>1130/408</td> </tr> </tbody> </table>	Date	Sales Price	Valid	Book/Page	6/5/2018	210,000	IR	2215/701	9/18/2001	18,000	N	1130/408									
Date	Sales Price	Valid	Book/Page																			
6/5/2018	210,000	IR	2215/701																			
9/18/2001	18,000	N	1130/408																			
	<table border="1" style="width: 100%; border-collapse: collapse;"> <tr> <td style="width: 40%;">Plat Book:</td> <td style="width: 20%;"> </td> <td style="width: 40%;">Plat Card:</td> <td> </td> </tr> </table>	Plat Book:		Plat Card:																		
Plat Book:		Plat Card:																				

LAND DATA - MARKET VALUE												
MTH	CODE	DESCRIPTION	ZONING	PRICE PER ACRE	ACRES	ADJ 1	ADJ 2	ADJ 3	UTILITIES	VALUE	NOTES	
1	A	0150 Res View		33,000	1.940	S-25			10,000	64,020		
Total Acres:					1.940	Total Land Value:				64,020		

OUTBUILDING DATA															
CODE	DESC	CT	LN	WD	UNITS	GRADE	AYB	EYB	COND	PHYS	FUNC	ECON	% CmplT	TAX VALUE	NOTES
64	STG, METAL UTIL		20	16	320	C	2006	2006	A	0.22				2100	

BUILDING DESCRIPTION	
VALUATION METHOD:	R - Residential
USE CODE:	R01 - SINGLE FAM DWLG
STYLE:	
FOUNDATION:	C - Continuous Wall
EXTERIOR WALL 1:	FR - Frame
EXTERIOR WALL 2:	
ROOF STRUCTURE:	G - Gable
ROOF COVER:	MT - Metal
BEDROOMS:	3
FULL BATHS:	2
HALF BATHS:	1
GENERATOR:	N
FIREPLACE TYPE/CNT/OPN/CH:	PF/1/2/1
ELEVATOR COUNT:	
PHYS OVERRIDE:	
ECONOMIC DEPRECIATION:	
FUNCTIONAL DEPRECIATION:	
SPECIAL CONDITION CODE:	
SPECIAL CONDITION VALUE:	
DESCRIPTION:	
REMARKS:	
CARD NOTES:	
UNITS:	
HEATED SQUARE FEET:	1,424

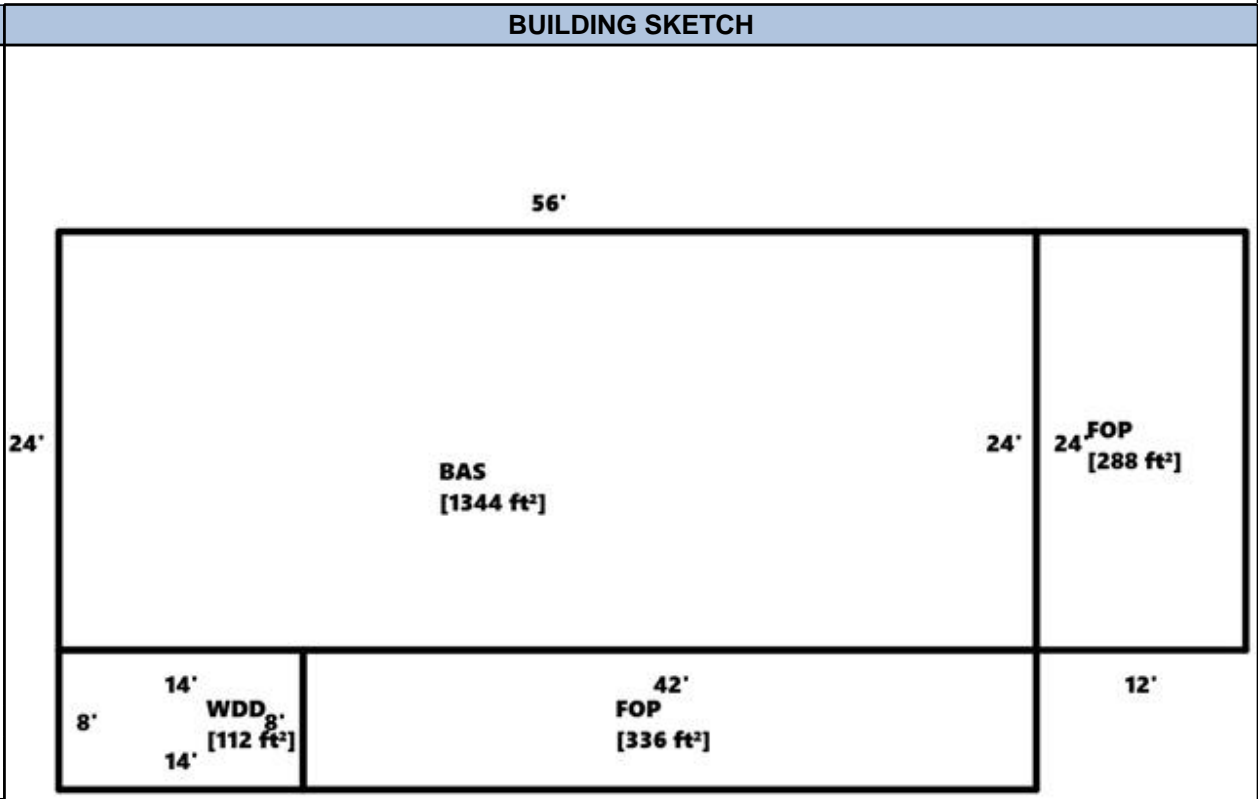

BUILDING COMPUTATION	
REPLACEMENT COST NEW	382,900
PHYSICAL DEPRECIATION	20%
FUNCTIONAL DEPRECIATION	
ECONOMIC DEPRECIATION	
% COMPLETE	
REPLACEMENT COST NEW LESS DEPRECIATION	306,320

BUILDING SECTION DETAIL																
TYPE	AREA	WALL HT	#ST	HEAT TYPE	HEAT%	AIR%	SPK%	GRADE	AYB	EYB	COND	P%	E%	F%	VALUE	
BAS	1344	8.00	1.5	HP		100%		C	2003	2003	A	80%			253,648	
FOP	288		1.0									80%			14,720	
FOP	336		1.0									80%			17,176	
FUS	80		1.0									80%			13,008	
PTO	576		1.0									80%			4,904	
WDD	112		1.0									80%			2,864	