

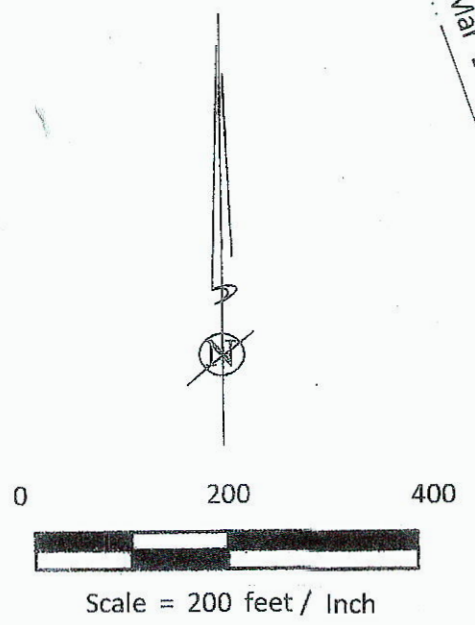

subject property is described as Tax Lot(s) 400, 700 and 800 in Section 16B and part of Tax Lot 100 in Section 17A, all in T25S, R5W, W.M.; Property I.D. No's. R43275, R43355, R43379, (pt) R21376 and (pt) R131744. The property is designated Low Density Hillside by the Sutherlin Comprehensive Plan and zoned (RH) Residential Hillside. **PLANNING DEPARTMENT FILE NO. 23-S005.**

**Preliminary Subdivision Map**  
 This plan would require access from the west.  
 Currently no legal access from the west.  
 Buyer to do due diligence.



	TECH. ENGINEERING
	PO Box 80483
	Portland, Oregon 97280
	Phone (503) 819-6494