

30 POPPY LANE

PEBBLE BEACH, CALIFORNIA

PARADISE ON POPPY

ParadiseOnPoppy.com

\$9,950,000



SCAN ME

Simply hold up your phone's camera to visit the property's website.

Ground-up new construction is seldom found in Pebble Beach. This striking contemporary masterpiece overlooks the 14th hole of Poppy Hills Golf Course and offers a buyer the rare opportunity for turnkey modern luxury living in one of Pebble Beach's best locations. The home contains warm finishes including stone, wood, and smooth, plaster walls and takes full advantage of its prime location with multiple indoor/outdoor living spaces and walls of glass to pull in the natural light and surrounding beauty. Sited on just over an acre in the exclusive Poppy Lane neighborhood, the 6,148 SqFt home boasts an extraordinary list of features for entertaining friends and family, as well as a 699 SqFt detached guest house. With views throughout the house across the golf course towards the pines filtering views of the ocean, and just a short stroll from the Poppy Hills clubhouse and Porters Bar, this architectural stunner awaits its new owners to move in and start enjoying paradise on Poppy Lane.



**COLDWELL
BANKER**

831.214.1990 | DRE#00891159
TimAllenProperties.com
Team@TimAllenProperties.com



TIM ALLEN
PROPERTIES TEAM

FLOOR PLAN

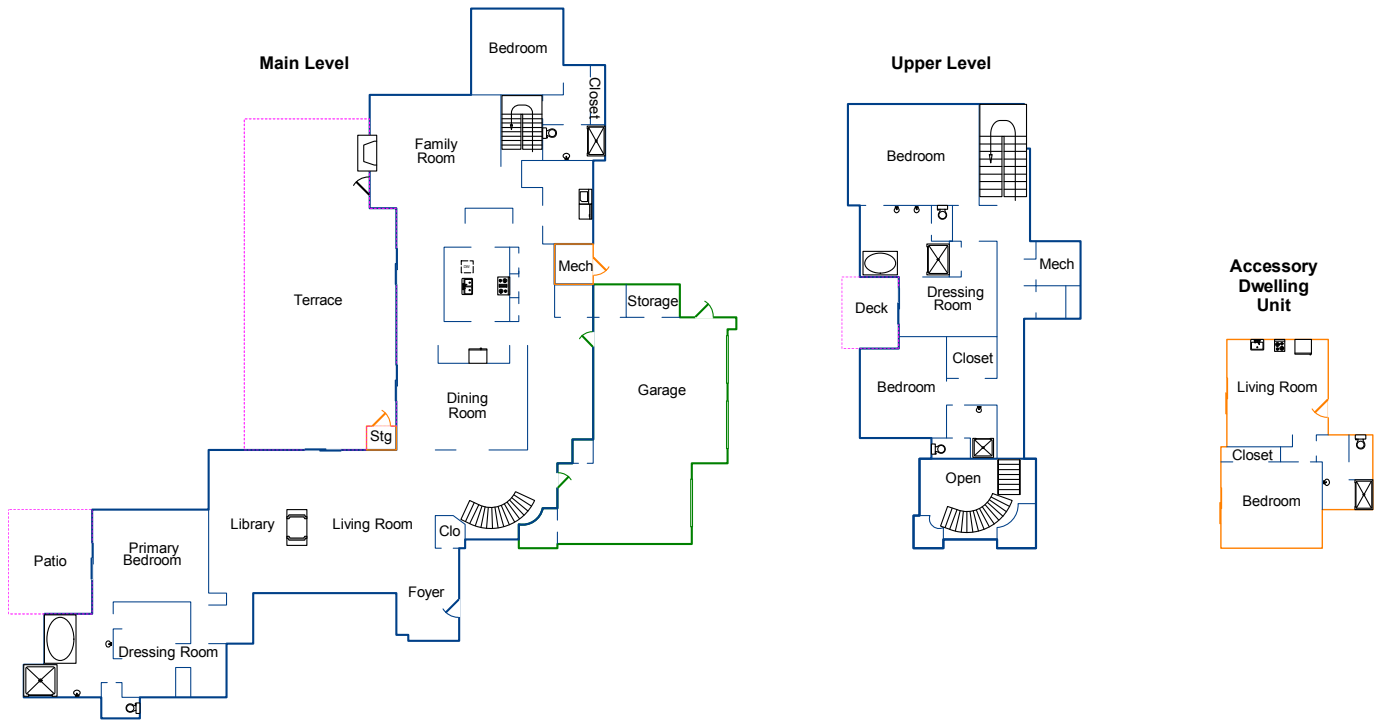

Main Living Area - 4459sf
 Upper Level - 1689sf

 Main House Total - 6148sf
 Accessory Dwelling Unit - 699sf

 Total Residential Area - 6847sf
 Garage - 986sf

Square foot calculations are based on dimensions provided by the client using architectural drawings

SPECIFICS



5 Bedrooms



5 Full, 1 Half Bathrooms



6,847 SqFt



1.03 Acres

Fireplace: 2

Heat: In-Floor Radiant Heat

Floors: Custom Wood, Tile, Carpet

Garage: 3-Car

Views: Golf Course, Ocean, Forest

Year Built: 2023