



## 3391 CARPENTER ROAD

CARMEL, CALIFORNIA

### UPDATED CARMEL RETREAT

\$1,095,000

[CarmelJewel.com](https://CarmelJewel.com)



#### SCAN ME

Hold up your phone's camera to visit the property's website.

Experience a laid-back seaside style in this beautifully updated 2 bed, 2 bath Carmel retreat located in the coveted Carmel school district. Set on an expansive 8,276 SqFt lot, this light-filled ~1,175 SqFt home showcases an open floor plan with vaulted wood ceilings and skylights that invite natural light throughout. The recently remodeled kitchen and bathrooms feature stunning quartz countertops, custom tile bath surrounds and floors, and designer finishes. Enjoy seamless indoor-outdoor living with sliding glass doors leading to a back deck and patio—perfect for entertaining or relaxing. A spacious dining area flows into the living room, while new carpet and fresh interior and exterior paint enhance the home's move-in-ready appeal. Additional highlights include a new paver driveway, interior laundry room, and ample space for expansion or lush garden landscaping. Close to all the incredible amenities the Monterey Peninsula has to offer, this home is a rare blend of modern comfort and timeless charm. Welcome to your Carmel dream.



**COLDWELL  
BANKER**

831.214.1990 | DRE#00891159  
[TimAllenProperties.com](https://TimAllenProperties.com)  
[Team@TimAllenProperties.com](mailto:Team@TimAllenProperties.com)



**TIM ALLEN**  
 PROPERTIES TEAM

The property information herein is derived from various sources that may include, but not be limited to, county records and the Multiple Listing Service, and it may include approximations. Although the information is believed to be accurate, it is not warranted and you should not rely upon it without personal verification. ©2024 Coldwell Banker. All Rights Reserved. Coldwell Banker and the Coldwell Banker logos are trademarks of Coldwell Banker Real Estate LLC. The Coldwell Banker® System is comprised of company owned offices which are owned by a subsidiary of Anywhere Advisors LLC and franchised offices which are independently owned and operated. The Coldwell Banker System fully supports the principles of the Fair Housing Act and the Equal Opportunity Act.

## FLOOR PLAN

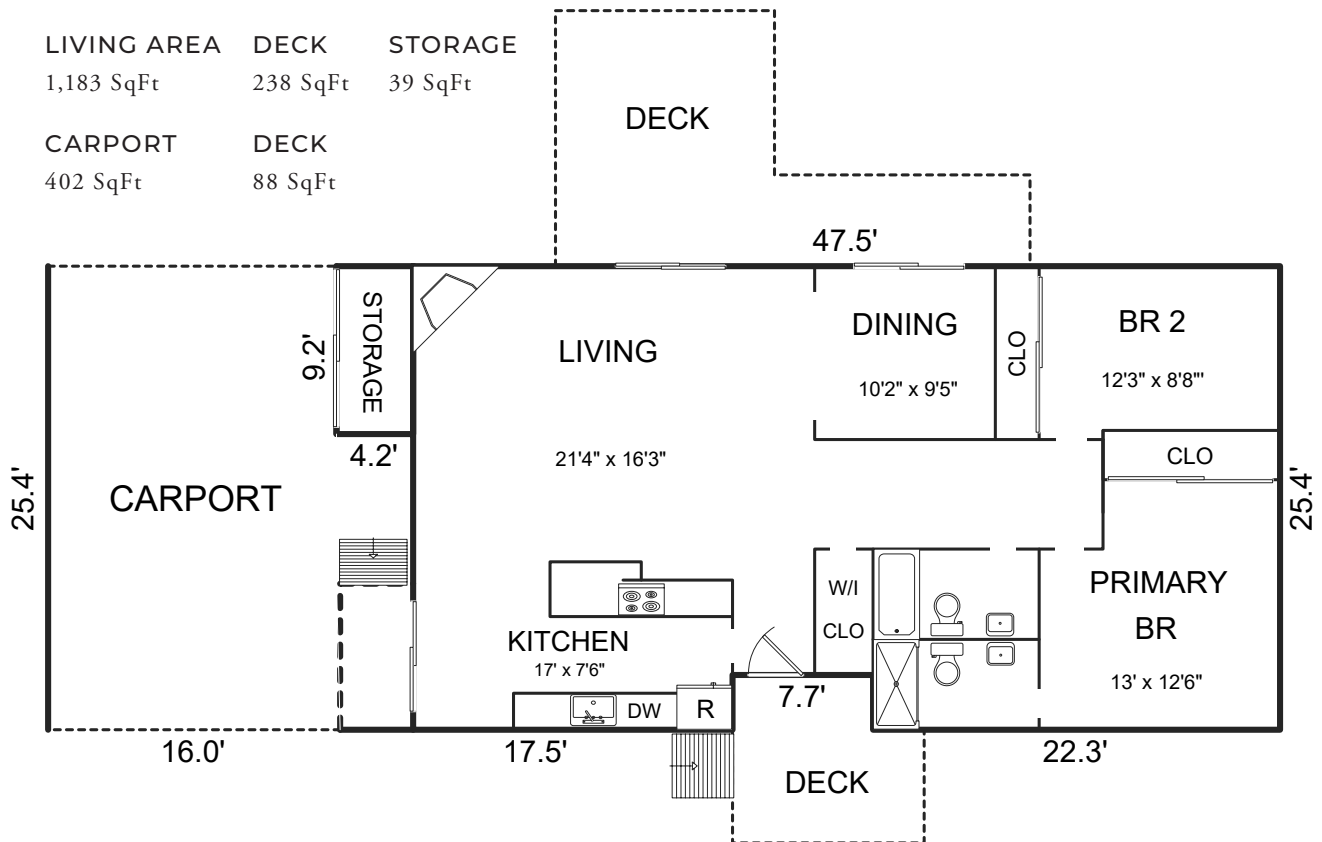

This model is for use as a visual tool only. Some measurements are estimates. Therefore, no appraisal value should be inferred.

## SPECIFICS



2 Bedrooms



2 Bathrooms



1,183 SqFt



8,276 SqFt Lot

Interior: ..... Plaster  
 Exterior: ..... Wood  
 Fireplace: ..... 1, Wood Burning  
 Heat: ..... Wall Furnace

Roof: ..... Composition Shingle  
 Floors: ..... Carpet, Tile  
 Carport: ..... 2 Spaces  
 Year Built: ..... 1980

**2.5% Buyers Brokerage Compensation** | Brokerage Compensation not binding unless confirmed by separate agreement among applicable parties.