



1246 PORTOLA ROAD

PEBBLE BEACH, CALIFORNIA

OCEANVIEW FRENCH COUNTRY ESTATE

\$18,200,000

PebbleBeachElegance.com



SCAN ME

Hold up your phone's camera to visit the property's website.

Experience timeless French country elegance at this 6,402± sq.ft. estate in Pebble Beach, crafted by Randy Wallis and designed by Jun Sillano of IDG. Set on 1.35 acres with panoramic views from Point Lobos to Point Sur in Big Sur and the coastline in between, this 5-bed, 6.5-bath home offers refined living in a private coastal setting. The stone entry opens to a grand living room with wide-plank wood floors, oak built-ins, and Ironware chandeliers. The gourmet kitchen features honed marble counters, Thermador appliances, a wood-clad hood, and walk-in pantry, all adjacent to a cozy family room with fireplace. A main-level primary suite includes French doors to the deck, walk-in closets, and a spa-like bath with Palomino granite and walk-out patio. An elevator connects the main levels, including a guest suite with ocean views, and a lower level with game room, multiple ensuite bedrooms, laundry, and radiant heat throughout. The 920± sq.ft. 3-car garage has dual EV chargers. Exterior highlights include fire pit, ocean-facing deck, uplighting, bronze railings, and room for a pool or guest unit. Quietly nestled among oaks with privacy and potential for expansion, this is Pebble Beach luxury at its finest.



**COLDWELL
BANKER**

831.214.1990 | DRE#00891159
TimAllenProperties.com
Team@TimAllenProperties.com



TIM ALLEN
PROPERTIES TEAM

The property information herein is derived from various sources that may include, but not be limited to, county records and the Multiple Listing Service, and it may include approximations. Although the information is believed to be accurate, it is not warranted and you should not rely upon it without personal verification. ©2024 Coldwell Banker. All Rights Reserved. Coldwell Banker and the Coldwell Banker logos are trademarks of Coldwell Banker Real Estate LLC. The Coldwell Banker® System is comprised of company owned offices which are owned by a subsidiary of Anywhere Advisors LLC and franchised offices which are independently owned and operated. The Coldwell Banker System fully supports the principles of the Fair Housing Act and the Equal Opportunity Act.

FLOOR PLAN

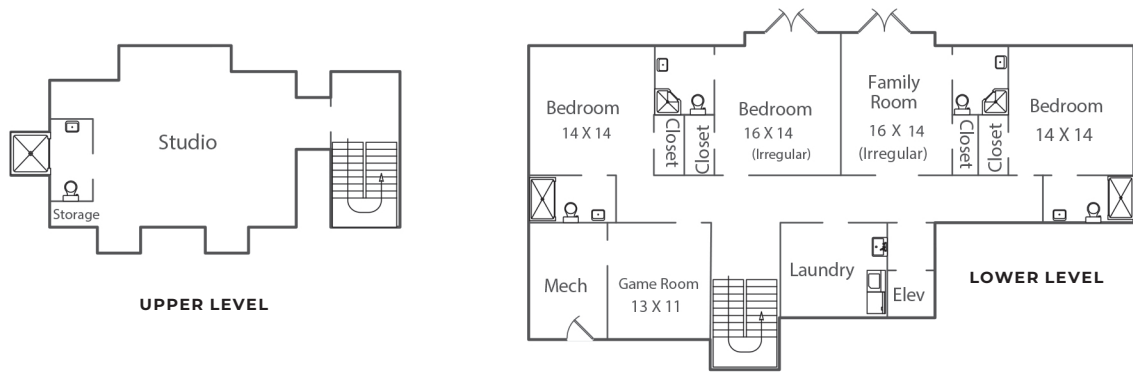

UPPER LEVEL	TOTAL LIVING AREA
764 SqFt	6,402 SqFt
MAIN LEVEL	GARAGE
3,552 SqFt	925 SqFt
LOWER LEVEL	
2,086 SqFt	

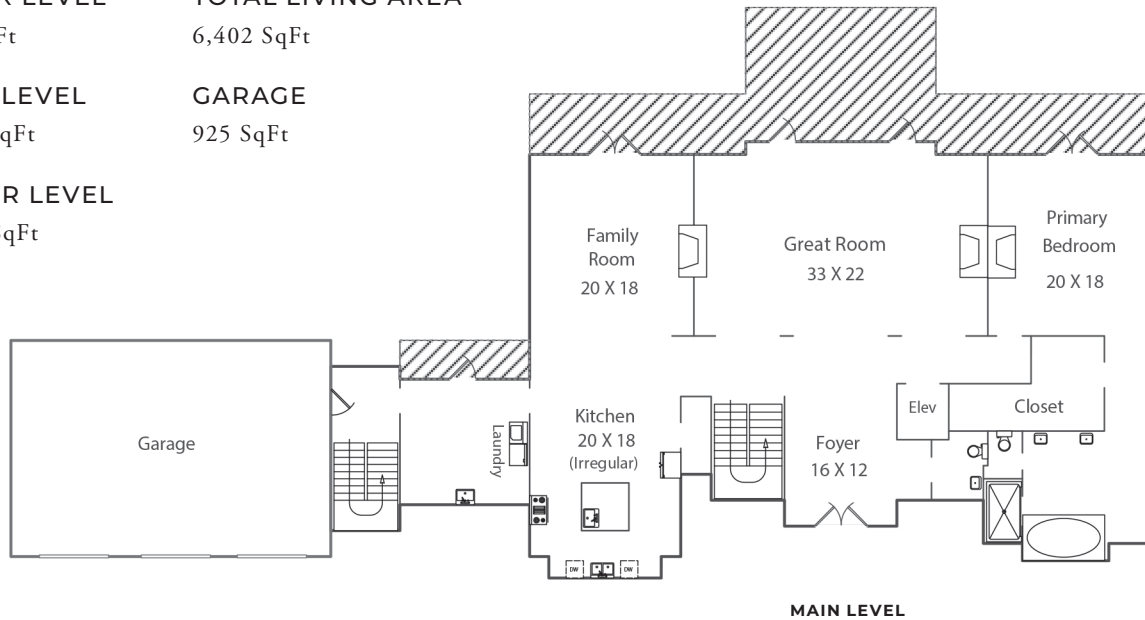

This model is for use as a visual tool only. Some measurements are estimates. Therefore, no appraisal value should be inferred.

SPECIFICS



5 Bedrooms



6 Full, 1 Half Bathrooms



6,402 SqFt



1.35 Acres

Interior: Plaster

Exterior: Stucco, Stone

Fireplace: 3

Heat: Radiant

Roof: Clay Tile

Floors: Hardwood

Garage: 3-Car

Year Built: 2025

2.5% Buyers Brokerage Compensation | Brokerage Compensation not binding unless confirmed by separate agreement among applicable parties.