



229A LOWER WALDEN RD

CARMEL HIGHLANDS, CALIFORNIA

VILLA FONTANA

\$5,200,000

CarmelCoastLiving.com



SCAN ME

Hold up your phone's camera to visit the property's website.

Located in the elevated Carmel Highlands, Villa Fontana—the former estate of Academy Award winning actress Joan Fontaine—is perfectly perched on the hills above the Carmel coastline, boasting sweeping views of the Pacific Ocean and the marine-rich details of Point Lobos. Set on a ~1 acre, Cypress studded lot, the home exudes all the elegance of old Hollywood style and charm, with gallery-like hallways and large entertaining areas. Stunning ocean views can be seen from almost every room and the large, westside decks enable effortless indoor/outdoor living, begging for alfresco dining, morning sunrise coffees, or sunset cocktails. Highlights include a gated entry, 4 bedrooms and 4.5 bathrooms, 4,712 SqFt of light and bright living space, a detached 2-car garage, a golden-era library with cozy fireplace, and open kitchen with unforgettable ocean views. Live like a movie star every day, exploring all the incredible amenities of the Monterey Peninsula, knowing that your private, coastal haven awaits your return.



**COLDWELL
BANKER**

831.214.1990 | DRE#00891159
TimAllenProperties.com
Team@TimAllenProperties.com



TIM ALLEN
PROPERTIES TEAM

The property information herein is derived from various sources that may include, but not be limited to, county records and the Multiple Listing Service, and it may include approximations. Although the information is believed to be accurate, it is not warranted and you should not rely upon it without personal verification. ©2024 Coldwell Banker. All Rights Reserved. Coldwell Banker and the Coldwell Banker logos are trademarks of Coldwell Banker Real Estate LLC. The Coldwell Banker® System is comprised of company owned offices which are owned by a subsidiary of Anywhere Advisors LLC and franchised offices which are independently owned and operated. The Coldwell Banker System fully supports the principles of the Fair Housing Act and the Equal Opportunity Act.

FLOOR PLAN

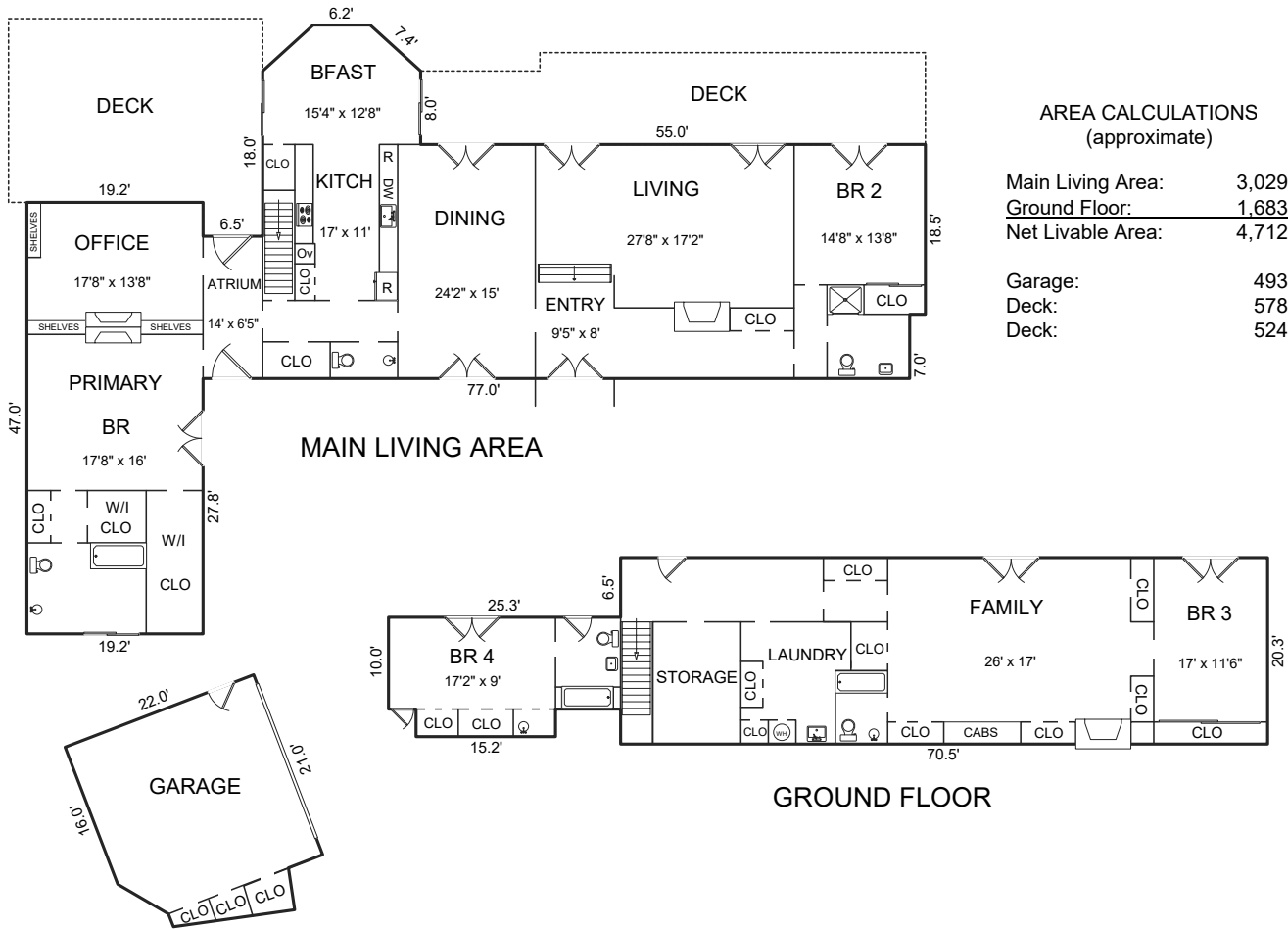

AREA CALCULATIONS
(approximate)

Main Living Area:	3,029sf
Ground Floor:	1,683
Net Livable Area:	4,712sf
Garage:	493
Deck:	578
Deck:	524

This model is for use as a visual tool only. Some measurements are estimates. Therefore, no appraisal value should be inferred.

SPECIFICS



4 Bedrooms



4 Full, 1 Half Bathrooms



4,712 SqFt



1 Acre

Interior: Plaster, Adobe

Roof: Wood Shingle

Exterior: Adobe

Floors: Hardwood, Brick, Carpet, Tile

Fireplace: 4

Garage: 2-Car

Heat: Central Forced Air

Year Built: 1965

2.5% Buyers Brokerage Compensation | Brokerage Compensation not binding unless confirmed by separate agreement among applicable parties.