



# 1051 OCEAN VIEW BLVD

PACIFIC GROVE, CALIFORNIA

**PACIFIC GROVE ESTATE  
ON OCEAN VIEW**

\$7,200,000

[PacificGroveParadise.com](http://PacificGroveParadise.com)



Perched along the dramatic, wave-carved coastline of Pacific Grove, this prominent oceanfront estate stands as a sentinel to the protected waters of the Monterey Bay Marine Sanctuary. Positioned directly above the Marine Gardens Conservation Area, this crown jewel offers an extraordinary front-row seat to one of the most pristine and abundant ecosystems in the world. Originally built in 1924, the home encompasses over 4,000 sq ft of modern luxury, featuring dual primary suites with breathtaking views, additional en-suite bedroom, large corner lot with a lush garden and lawn, 2 car garage, and detached guest house. Expansive terraces and balconies frame sweeping panoramic views, capturing sunrise to sunset. Here, your morning rhythm is dictated not by an alarm clock, but by the migration of gray whales and the pulse of the tides. A home where the Pacific Ocean filters the air and calms your mind. More than a visual backdrop, the view enriches everyday life, promoting a sense of balance, wellness, and harmony with nature. True to its name, Casa de la Roca is both grounded and enduring, anchored to the rugged shoreline and intimately intertwined with natural formations that define this iconic stretch of coast; a rare offering of strength, beauty, and legacy.



**COLDWELL  
BANKER**

831.214.1990 | DRE#00891159  
[TimAllenProperties.com](http://TimAllenProperties.com)  
[Team@TimAllenProperties.com](mailto:Team@TimAllenProperties.com)



**TIM ALLEN**  
PROPERTIES TEAM

# FLOOR PLAN

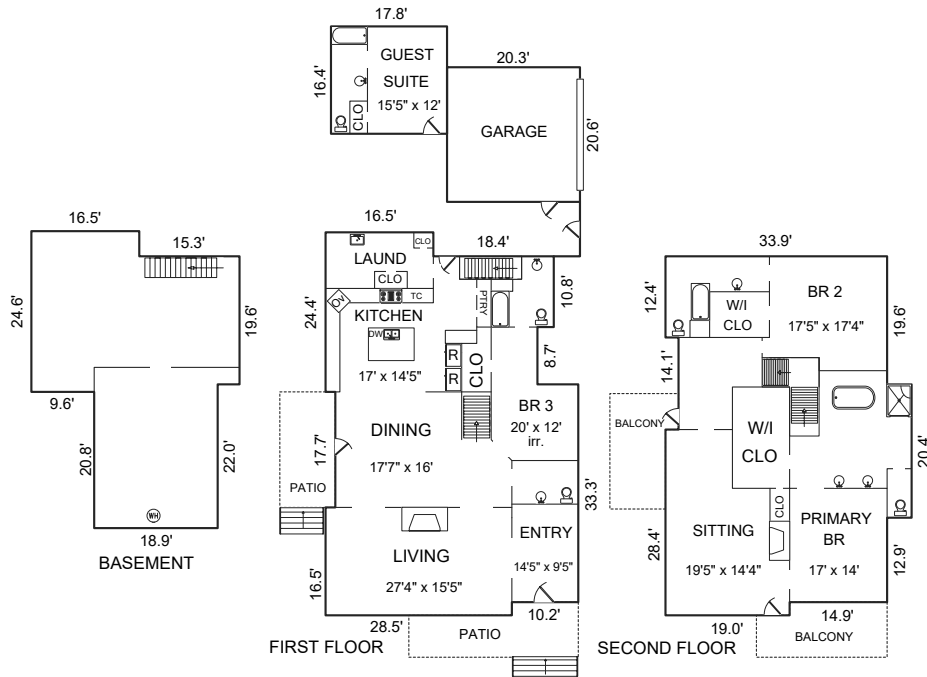

## AREA CALCULATIONS (approximate)

First Floor:	2,009sf
Second Floor:	1,808
Guest Suite:	291
<b>Net Livable Area:</b>	<b>4,108sf</b>
Garage:	419
Basement:	1,114
Patio:	187
Patio:	150
Balcony:	158
Balcony:	161

This model is for use as a visual tool only. Some measurements are estimates. Therefore, no appraisal value should be inferred.

## SPECIFICS



4 Bedrooms



4.5 Bathrooms



4,108 SqFt



9,507 SqFt

Interior: ..... Wood

Exterior: ..... Stucco

Fireplace: ..... 1 - Gas

Heat: ..... Central Forced Air

Roof: .. Composite Shingles, Elastomeric

Floors: ..... Wood, Tile, Carpet

Garage ..... 2-Car, Attached

Year Built: ..... 1924

**2.5% Buyers Brokerage Compensation** | Brokerage Compensation not binding unless confirmed by separate agreement among applicable parties.