



1022 DEL MONTE BLVD

PACIFIC GROVE, CALIFORNIA

CHARMING PACIFIC GROVE COTTAGE

\$2,350,000

PacificGroveJewel.com



SCAN ME

Hold up your phone's camera to visit the property's website.

Just steps from the beach and nestled among majestic cypress trees, this enchanting coastal cottage and guest house offer the perfect blend of charm and modern convenience. Located in the heart of the coveted Beach Tract neighborhood, this property is a true sanctuary. Set on an oversized lot with peeks of the ocean, the main residence features numerous refined updates focused on functionality, efficiency, and aesthetics, highlighted by a beautifully renovated custom kitchen. Step outside to enjoy the gentle ocean breeze and serene coastal setting from your private outdoor space. A fully-equipped and legally permitted guest house provides flexible options for extended family, visitors, or rental income. Whether you enjoy relaxing under the canopy of cypress trees at Esplanade Park or taking in the soothing sounds of waves at Otter Cove, this property is a rare opportunity to own a piece of paradise. Don't miss your chance to experience the timeless charm and unmatched tranquility in America's last hometown.



**COLDWELL
BANKER**

831.214.1990 | DRE#00891159
TimAllenProperties.com
Team@TimAllenProperties.com



TIM ALLEN
PROPERTIES TEAM

The property information herein is derived from various sources that may include, but not be limited to, county records and the Multiple Listing Service, and it may include approximations. Although the information is believed to be accurate, it is not warranted and you should not rely upon it without personal verification. ©2024 Coldwell Banker. All Rights Reserved. Coldwell Banker and the Coldwell Banker logos are trademarks of Coldwell Banker Real Estate LLC. The Coldwell Banker® System is comprised of company owned offices which are owned by a subsidiary of Anywhere Advisors LLC and franchised offices which are independently owned and operated. The Coldwell Banker System fully supports the principles of the Fair Housing Act and the Equal Opportunity Act.

FLOOR PLAN

MAIN HOUSE

846 SqFt

GUEST UNIT

404 SqFt

NET LIVING AREA

1,250 SqFt

DECK

191 SqFt

PATIO

154 SqFt

PATIO

80 SqFt

PORCH

73 SqFt

GARAGE

253 SqFt

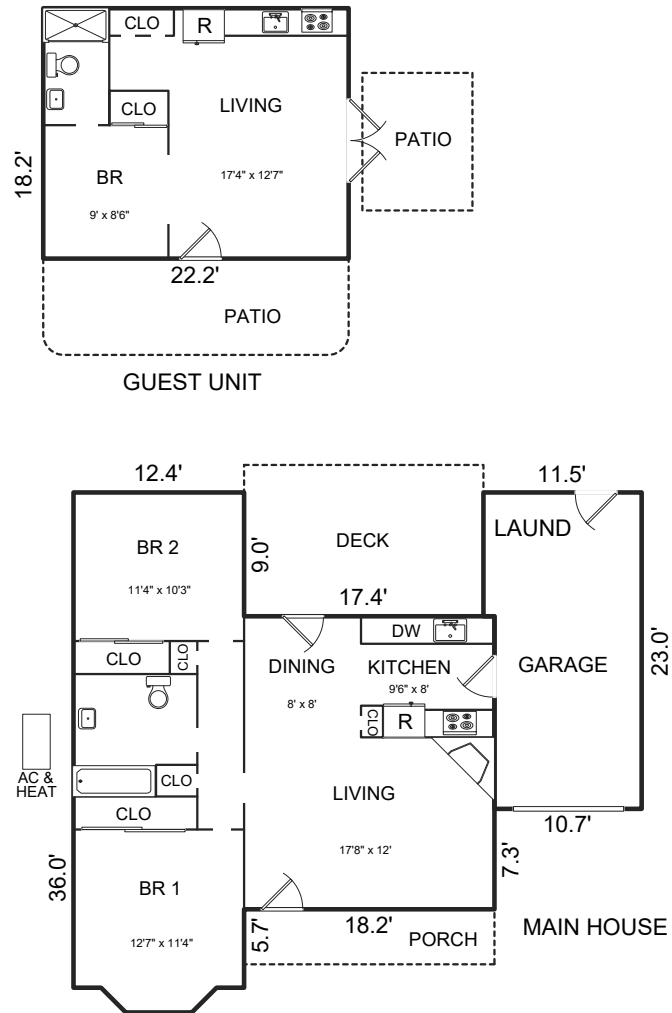

This model is for use as a visual tool only. Some measurements are estimates. Therefore, no appraisal value should be inferred.

SPECIFICS



3 Bedrooms



2 Bathrooms



1,250 SqFt



6,100 SqFt Lot

Interior: Plaster

Exterior: Wood

Fireplace: 1

Heat: Central Forced Air

Roof: Composition

Floors: Hardwood, Tile

Garage Space: 1

Year Built: 1949

2.5% Buyers Brokerage Compensation | Brokerage Compensation not binding unless confirmed by separate agreement among applicable parties.