

# 11827 SADDLE ROAD, MONTEREY, CA 93940

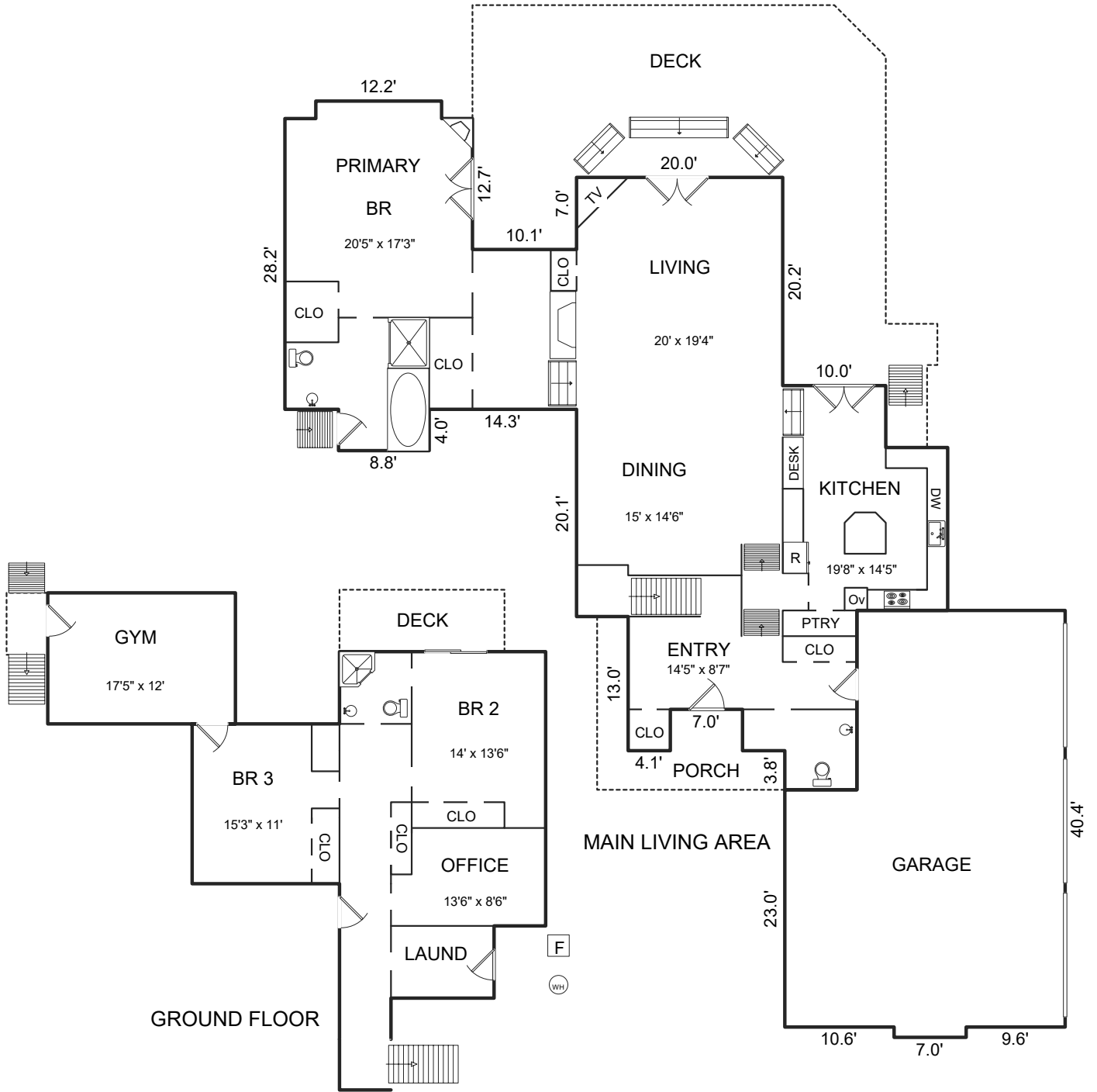

### AREA CALCULATIONS (approximate)

Main Living Area:	2,182sf
Ground Floor:	879
<b>Net Livable Area:</b>	<b>3,061sf</b>

Garage:	984
Workshop:	231
Porch:	136
Deck:	982
Deck:	96