

26378 ISABELLA AVENUE

CARMEL, CALIFORNIA

CHARMING COTTAGE ON CARMEL POINT

\$9,500,000

CarmelPointLiving.com



SCAN ME

Hold up your phone's camera to visit the property's website.

Located on Carmel Point with easy access to the village's world-class beaches, restaurants, shopping, and art galleries, this exceptionally large Carmel Cottage designed by renowned architect Tom Meaney provides luxury living with peeks of the ocean and all the amenities you could hope for. With 4 bedrooms, 3.5 bathrooms, and ~2,500 SqFt of living space, there is plenty of room to entertain friends and family. Other highlights include a gourmet kitchen, luxurious suites, spacious living and dining room with a beautiful fireplace leading out to the Carmel stone patio with built-in firepit and hot tub, and meticulously manicured gardens to explore. With Pebble Beach's golf, Big Sur, and all the wonderful amenities on the Monterey Peninsula, we welcome you to experience Carmel Isabella.



**COLDWELL
BANKER**

831.214.1990 | DRE#00891159
TimAllenProperties.com
Team@TimAllenProperties.com



TIM ALLEN
PROPERTIES TEAM

The property information herein is derived from various sources that may include, but not be limited to, county records and the Multiple Listing Service, and it may include approximations. Although the information is believed to be accurate, it is not warranted and you should not rely upon it without personal verification. ©2024 Coldwell Banker. All Rights Reserved. Coldwell Banker and the Coldwell Banker logos are trademarks of Coldwell Banker Real Estate LLC. The Coldwell Banker® System is comprised of company owned offices which are owned by a subsidiary of Anywhere Advisors LLC and franchised offices which are independently owned and operated. The Coldwell Banker System fully supports the principles of the Fair Housing Act and the Equal Opportunity Act.

FLOOR PLAN

MAIN LIVING AREA

1,527 SqFt

FINISHED BASEMENT

1,040 SqFt

TOTAL LIVING AREA

2,567 SqFt

GARAGE

287 SqFt

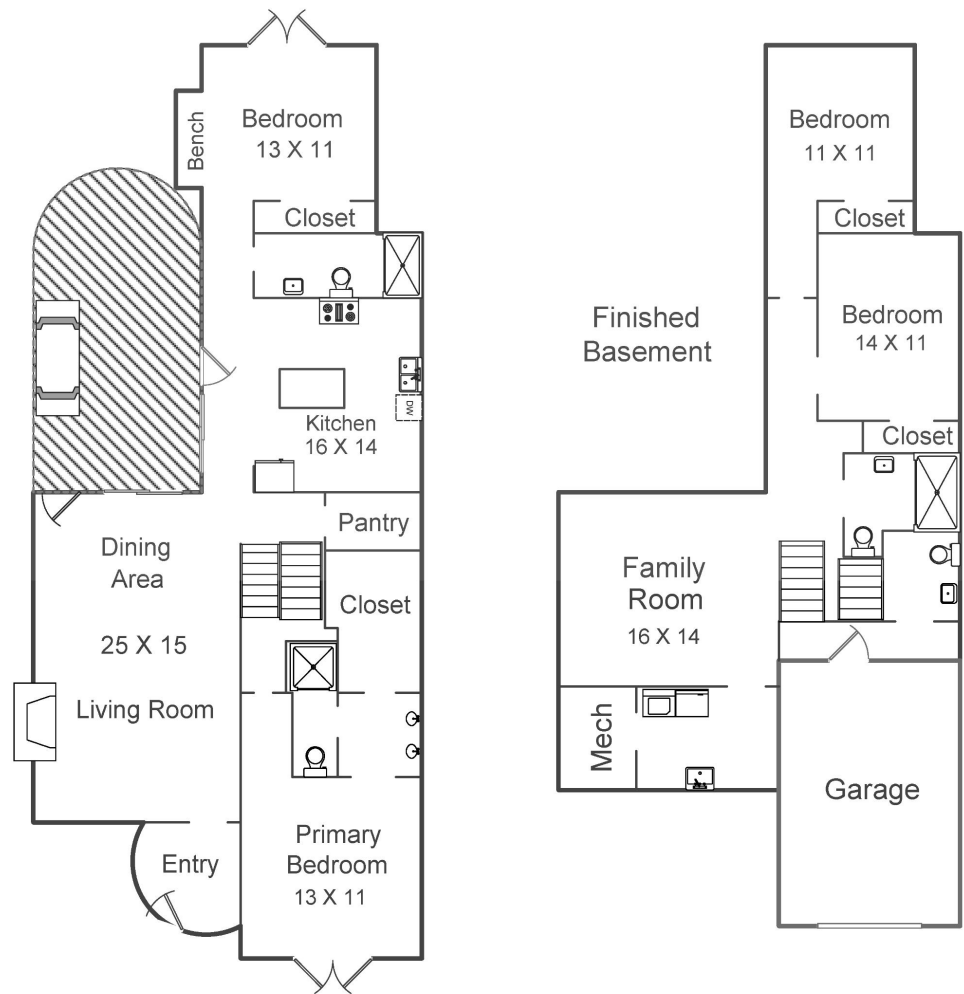

This model is for use as a visual tool only. Some measurements are estimates. Therefore, no appraisal value should be inferred.

SPECIFICS



4 Bedrooms



3 Full, 1 Half Bathrooms



2,567 SqFt



4,000 SqFt Lot

Interior: Venetian Plaster

Exterior: Stucco, Stone

Fireplace: 1 Indoor, 1 Outdoor Firepit

Heat: Radiant

Roof: Tile

Floors: European Oak, Tile

Garage: 1-Car

Year Built: 2016

2.5% Buyers Brokerage Compensation | Brokerage Compensation not binding unless confirmed by separate agreement among applicable parties.