



1636 ABRAMSON ROAD

SANTA ROSA, CALIFORNIA

MODERN CRAFTSMAN VINEYARD ESTATE

\$2,499,000

SantaRosaLiving.com



SCAN ME

Hold up your phone's
camera to visit the
property's website.

Discover a private Wine Country retreat in Sonoma County's coveted Russian River Valley AVA. Nestled on 7+ acres, this single-level Craftsman estate was reimaged in 2013 by Harkey Construction. The 2,595± sq ft residence showcases soaring wood-beamed and cedar-lined ceilings, skylights, a wood-burning fireplace, and tumbled marble floors. The chef's kitchen boasts leathered granite, Wolf appliances, Miele refrigeration, custom cabinetry, and a butler's pantry. The serene primary suite features a spa-like bath with dual sinks, makeup vanity, and walk-in shower. Two additional bedrooms, an office nook, and a laundry/mudroom enhance flexibility. Entertain effortlessly in the resort-style yard with expansive patios, pergola, fountain, artificial turf, and Tonga lighting. A fully equipped outdoor barn-kitchen with BBQ, griddle, fridge, sink, TV, heater, and bar seating overlooks the vineyard. Additional highlights include a climate-controlled barn/workshop with loft, gated entry, water filtration systems, two 5,000-gallon storage tanks with fire hose hookup, and ample parking for RVs, boats, and guests. A rare blend of elegance, privacy, and vineyard lifestyle—ideal as a primary home or Wine Country compound.



**COLDWELL
BANKER**

John C. Reid
707.328.0101 | DRE#01994802
TimAllenProperties.com
Team@TimAllenProperties.com



TIM ALLEN
PROPERTIES TEAM

The property information herein is derived from various sources that may include, but not be limited to, county records and the Multiple Listing Service, and it may include approximations. Although the information is believed to be accurate, it is not warranted and you should not rely upon it without personal verification. ©2024 Coldwell Banker. All Rights Reserved. Coldwell Banker and the Coldwell Banker logos are trademarks of Coldwell Banker Real Estate LLC. The Coldwell Banker® System is comprised of company owned offices which are owned by a subsidiary of Anywhere Advisors LLC and franchised offices which are independently owned and operated. The Coldwell Banker System fully supports the principles of the Fair Housing Act and the Equal Opportunity Act.

FLOOR PLAN

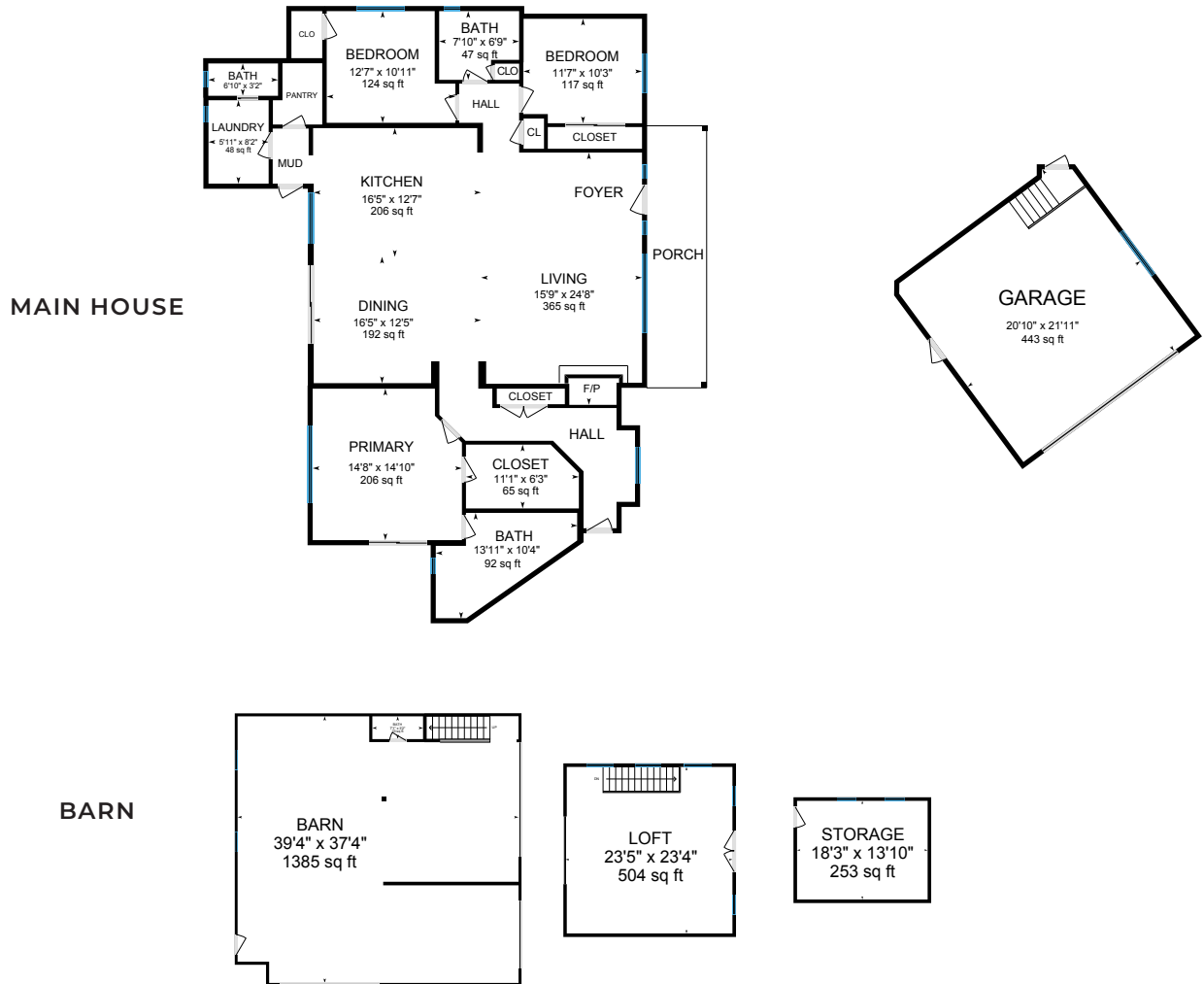

This model is for use as a visual tool only. Some measurements are estimates. Therefore, no appraisal value should be inferred.

SPECIFICS



3 Bedrooms



2 Full, 2 Half Bathrooms



2,595 SqFt



7.06 Acre Lot

Interior: Plaster

Exterior: Wood

Fireplace: 1, Wood Burning With Insert

Heat & A/C: Central

Roof: Composition Shingle

Floors: Tumbled Marble Tile, Carpet

Garage Space: 7

Year Built: 1948

2.5% Buyers Brokerage Compensation | Brokerage Compensation not binding unless confirmed by separate agreement among applicable parties.